



**Shown with Cover Removed**



YoLink® YS7201 Sensor Not Included

## Features

- Designed for the YoLink® Smart Vibration Sensor, Shock Sensor and Glass Break Sensor (Model YS7201)
- Meets NEMA 1, 2, 4, 4X, 12, 13 and IP65, IP66 for outdoor installations
- Provides protection of sensor from theft or damage
- Small size makes it easy to conceal
- Can be wall mounted or pole mounted with optional adjustable bands
- RF transparent design will not affect LoRa signal range or coverage pattern
- Easy to install

YoLink® is a trademark or registered trademark of YoSmart, Inc.

## Description

---

The **Altelix YoLink Sensor Enclosure** provides a simple and easy to use solution to mount and secure your YoLink® Smart Vibration Sensor. Designed for harshest environments, the YoLink® sensor enclosure can be wall mounted using the included screws and wall anchors or pole mounted using optional adjustable bands.

### Construction and Features

The cover of this enclosure is molded out of UV resistant Polycarbonate + ABS, an industrial grade plastic with greater strength and durability than standard ABS. The enclosure base is constructed from PETG which provides significant chemical resistance and durability, Both the cover and base are fully gasketed and meets or exceeds NEMA 1, 2, 4, 4X, 12, 13 and IEC 529 IP65, IP66. The RF transparent design will not effect LoRa signal range or coverage pattern.

### Easy to Use

This enclosure is specifically designed for use with YoLink® Smart Vibration Sensor. Installation is easy, simply attach the YoLink® Vibration Sensor to the enclosure base using the double-sided take included with the sensor or hook-n-loop tape include with the enclosure. Attach the gasketed cover using the four screws and gasketed washers. Included is a sealed cable gland installed in the open port to maintain the NEMA rating of the enclosure when no cables are used. When required for use, simply punch a hole through the inner seal, run your cable and hand tighten for a water-tight seal.

This enclosure is compatible with the following YoLink® Sensor:

- YoLink® Smart Vibration Sensor, Shock Sensor and Glass Break Sensor (model #YS7201)

## Specifications

---

<b>Material</b>	Polycarbonate / PETG
<b>Color</b>	Gray
<b>Dimensions</b>	4.6 x 7.2 x 1.7 In. (116.8 x 182.8 x 43.1mm)
<b>Included Accessories</b>	(4) Wall Anchors and Screws Cable Gland
<b>Mounting Plate Material</b>	0.25 in (6.4 mm) PVC
<b>Weight</b>	0.4 lbs. (0.2 kg)
<b>Ratings</b>	NEMA 1, 2, 4, 4X, 12, 13, and IP65, IP66
<b>Compatible YoLink® Models</b>	Vibration Sensor, Shock Sensor, Glass Break Sensor (YS7201)

## Product Photos

---

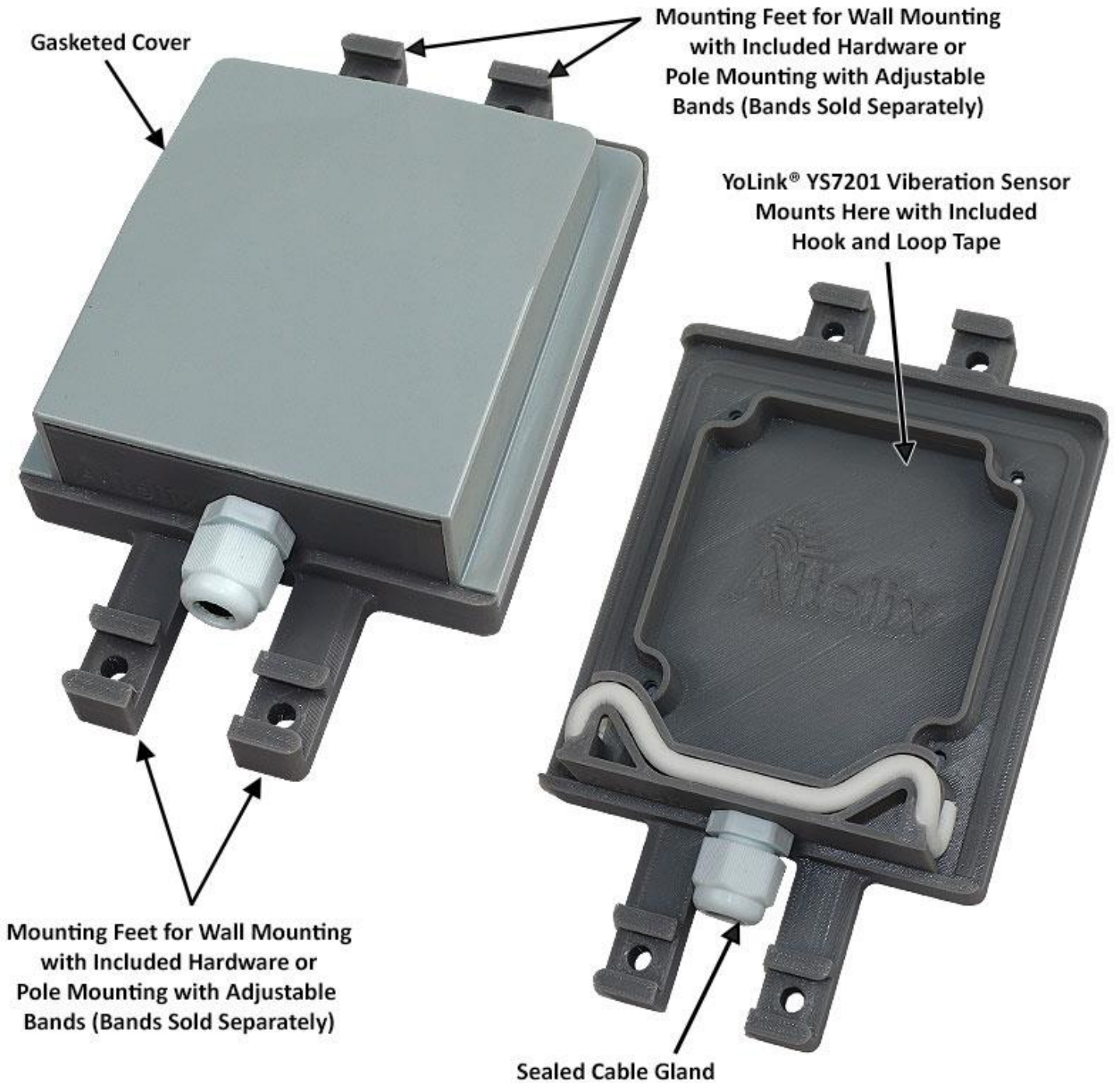

**Product Photos**

---

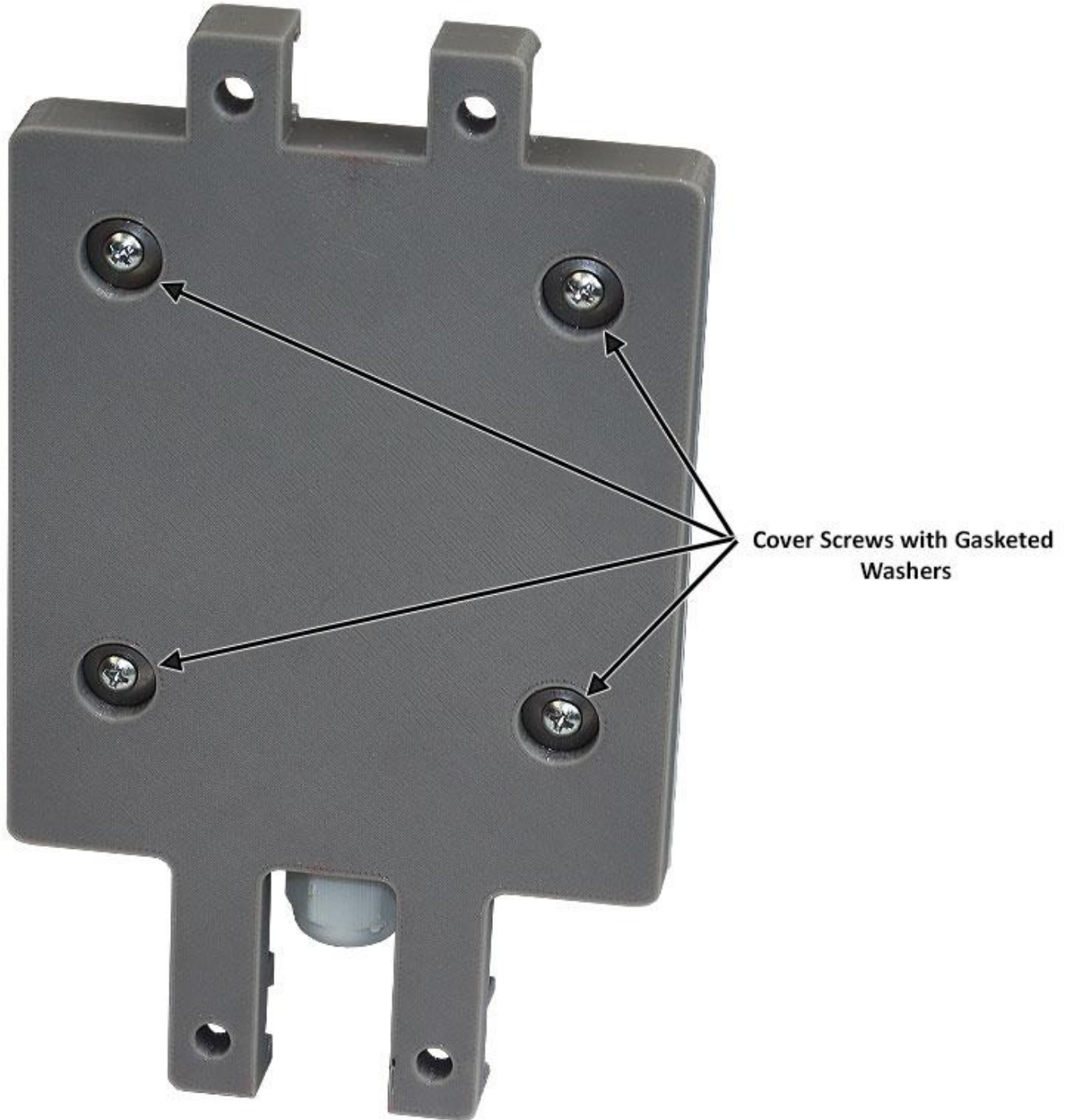

Product Photos

---



**Shown Pole Mounted with Adjustable Bands  
(Sold Separately)**