

14x12x6 Fiberglass Weatherproof Heated NEMA Enclosure with 120 VAC Outlets & 200W Heater with Digital Temperature Controller

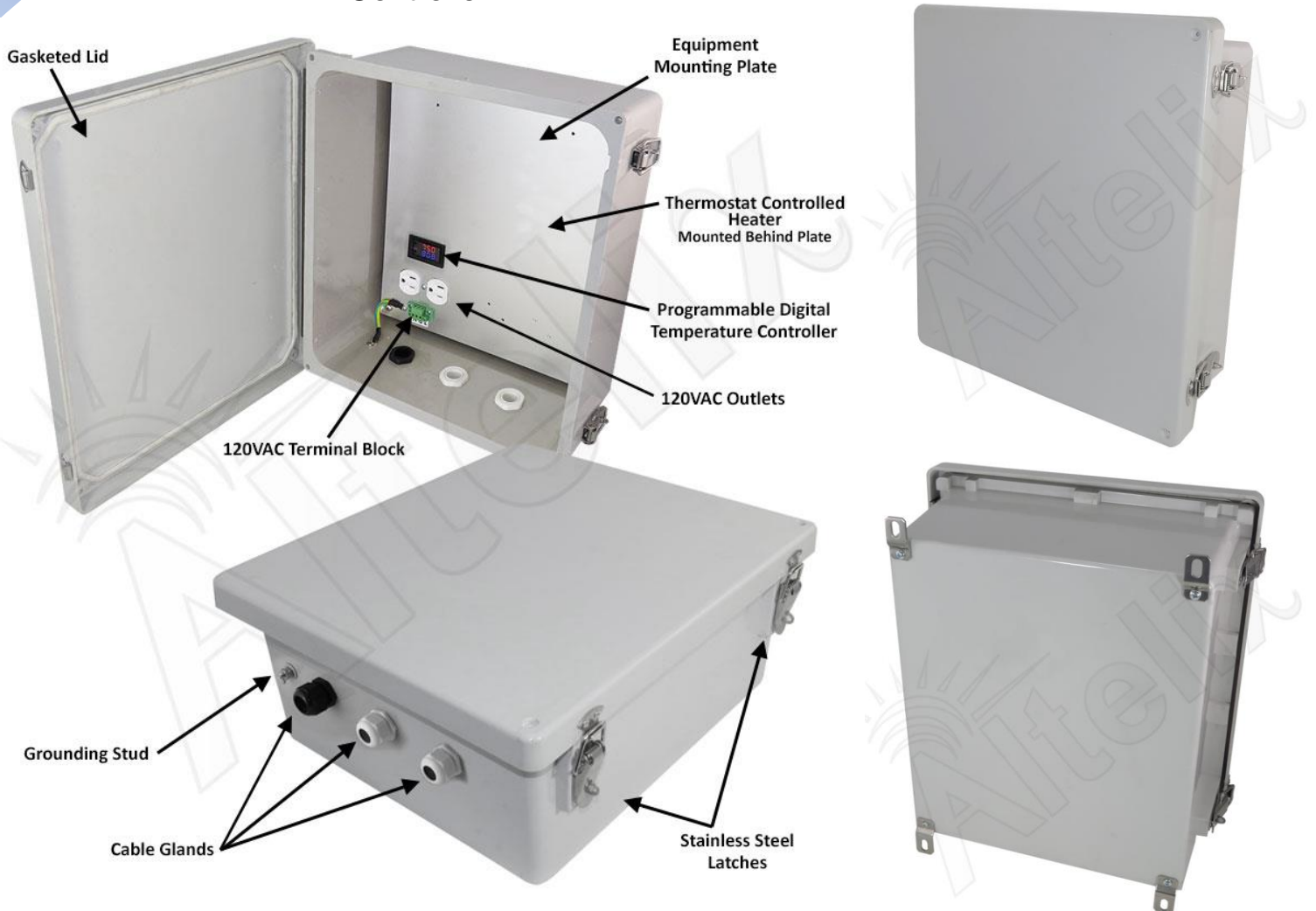

Features

- 200W Heating System with Programmable Digital Temperature Controller
- (2) Pre-Wired 120VAC Outlets
- Removable 120VAC Terminal Block
- Aluminum Equipment Mounting Plate
- Stainless Steel Hinge and Quick Release Latches with Padlock Hasps
- Fiberglass Reinforced Polyester, FRP
- Weatherproof, UV Stable and Highly Corrosion Resistant
- Meets NEMA 1, 2, 4, 4X, 12, 13 and IP65, IP66
- Includes Cable Glands and Stainless Steel Mounting Feet
- RF Transparent Enclosure
- Pole Mounting Kit Available



Description

The **Altelix NF141206HA1-DH** is ideal for cold environments. It features a 200W heating system. The operation of the heater can be controlled by the programmable digital temperature controller accessible inside the enclosure. The heater can be programmed to turn on and off within a temperature range of -58°F to 230°F (-50°C to 110°C). The controller features a color digital readout and can be programmed for Fahrenheit or Celsius. The heater is mounted below the equipment plate and wired internally so leaves the interior space and power outlets available for your equipment. An insulated extreme cold weather model is also available with a 400W heating system.

This enclosure provides two pre-wired 120VAC power outlets and a terminal strip, for easy wiring by a qualified installer.

Extreme Protection Built to Last

This rugged JIC style NEMA box is molded from durable UV stable and corrosion resistant fiberglass reinforced polyester (FRP) with a UL94-5V flame rating. The FRP material is dent-proof, non-conductive and RF transparent for compatibility with wireless equipment. It can be easily drilled and modified by the installer as needed. It features a gasketed door with stainless steel continuous hinge and stainless steel quick release latches with padlock hasps. The generous size of this enclosure accommodates a wide range of equipment.

Removable Terminal Block

This enclosure features our 120VAC top entry terminal block. It is easily removable which helps simplify on-site wiring. It can accept wires sizes from 12 to 18 AWG. The wires are secured by side terminal screws.

Specifications

| | |
|---|--|
| Material | Fiberglass Reinforced Polyester |
| Color | Gray |
| Voltage | 120VAC |
| Max Load | 15A @ 120VAC |
| Digital Controller Temperature Range | -58°F (-50°C) to 230°F (100°C) |
| Heater Power | 200 Watts |
| Terminal Block Wire Range | 12-18 AWG |
| Terminal Block Wire Strip Length | 6-7mm |
| Outer Dimensions | 15.75 x 13.83 x 6.54 Inches (401 x 352 x 164 mm) |
| Inner Dimensions | 13.87 x 11.97 x 6.2 Inches (352 x 304 x 157 mm) |
| Mounting Plate Material | 0.10 in (2.5 mm) Aluminum |
| Mounting Plate Dimensions | 10.9 x 12.8 in. (276 x 324 mm) |
| Weight | 11.4 lbs. (5.2 kg) |
| Ratings* | NEMA Type 4, 4X / IP66 |
| Flame Rating | UL94-5V |

*Note: Enclosure ports must be properly sealed to maintain NEMA Type 4, 4X / IP66 rating.