

14x12x6 Fiberglass Weatherproof NEMA 4X RF Transparent Enclosure with No-Drill PVC Equipment Mounting Plate, 120 VAC Outlets & Power Cord

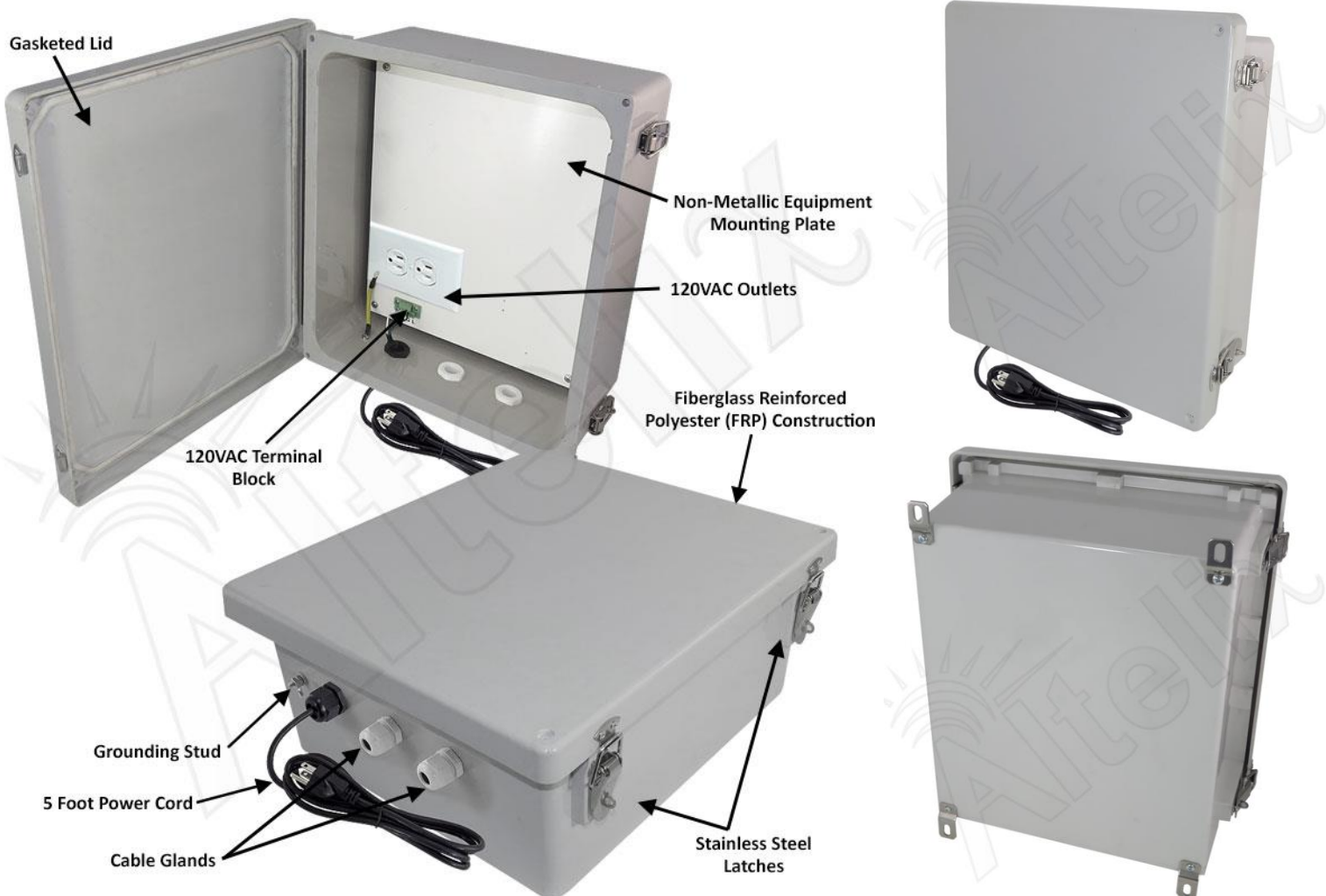

## Features

- No Electrical Wiring Required
- (2) Pre-Wired 120VAC Outlets with Pre-Wired 5 Foot Power Cord
- Removable 120VAC Terminal Block
- Features a No-Drill PVC Non-Metallic Equipment Mounting Plate
- Mount your equipment securely without the need for drilling!
- Stainless Steel Hinge and Quick Release Latches with Padlock Hasps
- Fiberglass Reinforced Polyester, FRP
- Weatherproof, UV Stable and Highly Corrosion Resistant
- Meets NEMA 1, 2, 4, 4X, 12, 13 and IP65, IP66
- Includes Cable Glands and Stainless Steel Mounting Feet
- RF Transparent Enclosure
- Pole Mounting Kit Available

## Description

---

The **Altelix NF141206MA1C** Enclosure is ideal for rapid deployment because no wiring is required. Simply mount the enclosure and plug the pre-wired 5 foot power cord into a nearby outlet. The 1/4" thick no-drill PVC non-metallic RF transparent equipment mounting plate features two pre-wired 120VAC power outlets for your equipment.

**Get your project up and running quickly** and transition to hard-wired later if needed. The power cord can be easily removed, and the quick-connect terminal strip simplifies hard-wiring by a qualified installer.

### Wireless Compatibility

This RF transparent enclosure and non-metallic equipment mounting plate are ideal for wireless applications including WiFi, RFID, IoT, Cellular and more. The non-metallic materials will not interfere with the operation of wireless gear.

### Extreme Protection Built to Last

This rugged JIC style NEMA box is molded from durable UV stable and corrosion resistant fiberglass reinforced polyester (FRP) with a UL94-5V flame rating. The FRP material is dent-proof, non-conductive and RF transparent for compatibility with wireless equipment. It can be easily drilled and modified by the installer as needed. It features a gasketed door with stainless steel continuous hinge and stainless steel quick release latches with padlock hasps. The generous size of this enclosure accommodates a wide range of equipment.

## Specifications

---

<b>Material</b>	Fiberglass Reinforced Polyester
<b>Color</b>	Gray
<b>Voltage</b>	120VAC
<b>Max Load</b>	10A @ 120VAC
<b>Terminal Block Wire Range</b>	12-18 AWG
<b>Terminal Block Wire Strip Length</b>	6-7mm
<b>Outer Dimensions</b>	15.7 x 13.8 x 6.5 Inches (401 x 352 x 165 mm)
<b>Inner Dimensions*</b>	13.0 x 11.0 x 4.3 Inches (330 x 279 x 110 mm)
<b>Mounting Plate Material</b>	0.25 inch (6.4 mm) PVC
<b>Mounting Plate Dimensions</b>	10.9 x 12.8 in. (276 x 324 mm)
<b>Weight</b>	10.4 lbs. (4.7 kg)
<b>Power Cord Length</b>	5 Feet (1.5m)
<b>Ratings*</b>	NEMA Type 4, 4X / IP66
<b>Flame Rating</b>	UL94-5V

\*Notes

- 1) Enclosure ports must be properly sealed to maintain NEMA Type 4, 4X / IP66 rating.
- 2) See drawing for detailed dimensions of maximum space available for equipment.