

14x12x6 Fiberglass Weatherproof Vented NEMA Enclosure  
with 120 VAC Outlets and 85°F Turn-On Cooling Fan

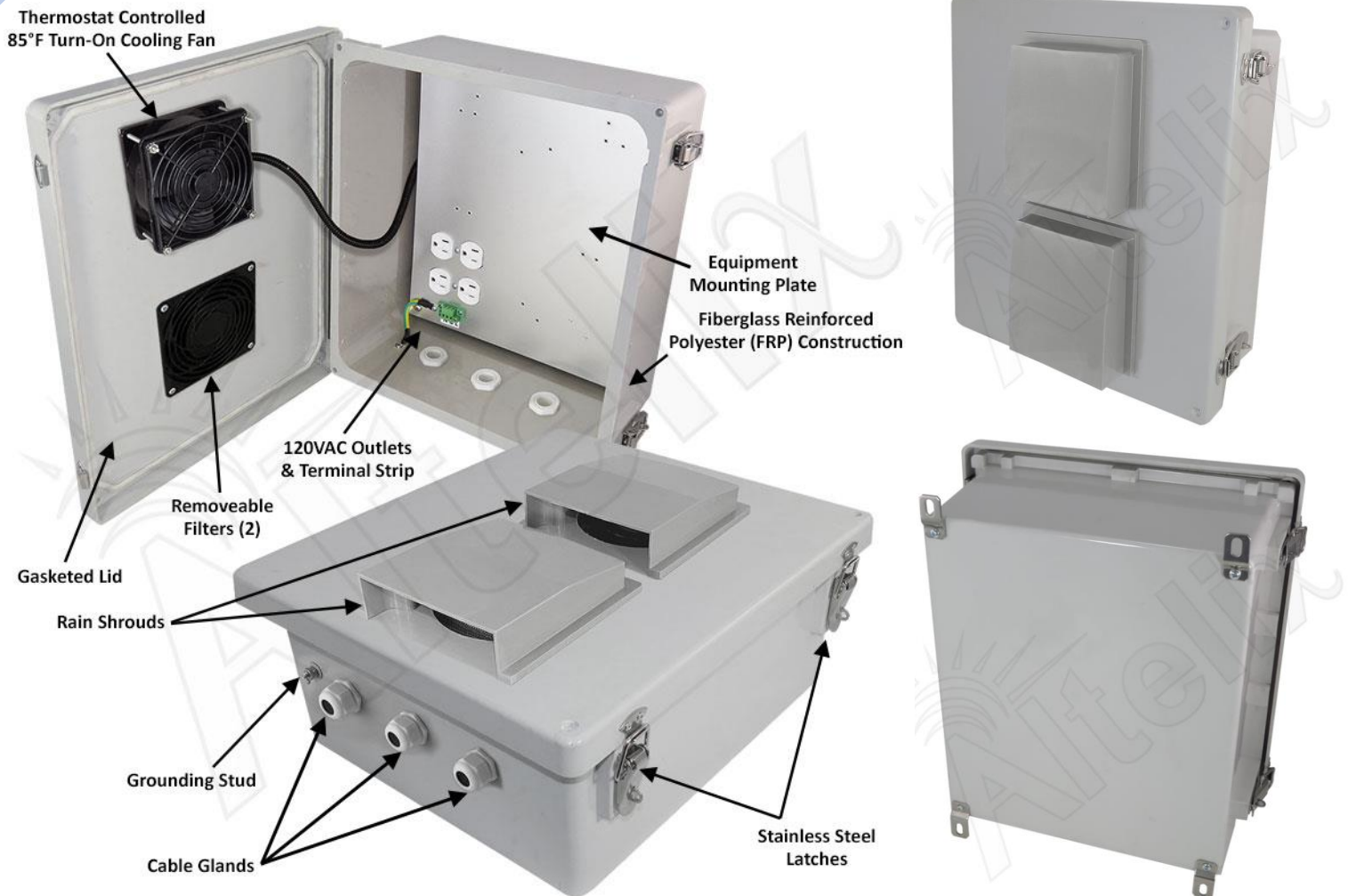

## Features

- Thermostat Controlled 85°F (30°C) Turn-On Cooling Fan
- Two (2) 4" Vents with Rain Shields and Screens
- (4) Pre-Wired 120VAC Outlets
- Removable 120VAC Terminal Block
- Aluminum Equipment Mounting Plate
- Stainless Steel Hinge and Quick Release Latches with Padlock Hasps
- Fiberglass Reinforced Polyester, FRP
- Weatherproof, UV Stable and Highly Corrosion Resistant
- NEMA Type 3R, 3RX / IP24 Rated
- Includes Cable Glands and Stainless Steel Mounting Feet
- RF Transparent Enclosure
- Pole Mounting Kit Available

## Description

---

The **Altelix NF141206VFA1-85** features two 4" vents and a thermostat controlled cooling fan which helps maintain lower internal temperatures. The fan turns on when the internal temperature reaches 85°F (30°C) and turns off when it drops to 59°F (15°C). Rain shrouds keep rain water from entering the enclosure while allowing ventilation for your equipment.

This enclosure provides four pre-wired 120VAC power outlets and a terminal strip, for easy wiring by a qualified installer. The fan is wired internally, leaving all power outlets available for installed equipment.

### Extreme Protection Built to Last

This rugged JIC style NEMA box is molded from durable UV stable and corrosion resistant fiberglass reinforced polyester (FRP) with a UL94-5V flame rating. The FRP material is dent-proof, non-conductive and RF transparent for compatibility with wireless equipment. It can be easily drilled and modified by the installer as needed. It features a gasketed door with stainless steel continuous hinge and stainless steel quick release latches with padlock hasps. The generous size of this enclosure accommodates a wide range of equipment.

### Removable Terminal Block

This enclosure features our 120VAC top entry terminal block. It is easily removable which helps simplify on-site wiring. It can accept wires sizes from 12 to 18 AWG. The wires are secured by side terminal screws.

## Specifications

---

|   |   |
|---|---|
| <b>Material</b>                         | Fiberglass Reinforced Polyester               |
| <b>Color</b>                            | Gray  |
| <b>Voltage</b>                          | 120VAC  |
| <b>Max Load</b>                         | 15A @ 120VAC                                  |
| <b>Cooling Fan Turn-On Temperature</b>  | 85°F (30°C)                                   |
| <b>Cooling Fan Turn-Off Temperature</b> | 59°F (15°C)                                   |
| <b>Outer Dimensions</b>                 | 15.7 x 13.8 x 8.0 Inches (401 x 352 x 205 mm) |
| <b>Inner Dimensions*</b>                | 13.0 x 11.0 x 2.7 Inches (330 x 279 x 69 mm)  |
| <b>Mounting Plate Material</b>          | 0.10 in (2.5 mm) Aluminum                     |
| <b>Mounting Plate Dimensions</b>        | 10.9 x 12.8 in. (276 x 324 mm)                |
| <b>Weight</b>                           | 12.0 lbs. (5.4 kg)                            |
| <b>Terminal Block Wire Range</b>        | 12-18 AWG                                     |
| <b>Terminal Block Wire Strip Length</b> | 6-7mm   |
| <b>Ratings</b>                          | NEMA Type 3R, 3RX / IP24                      |
| <b>Flame Rating</b>                     | UL94-5V                                       |

\*See drawing for detailed dimensions of maximum space available for equipment.