

14x12x6 Fiberglass Weatherproof Vented NEMA Enclosure with 120 VAC Outlets and Cooling Fan with Digital Temperature Controller

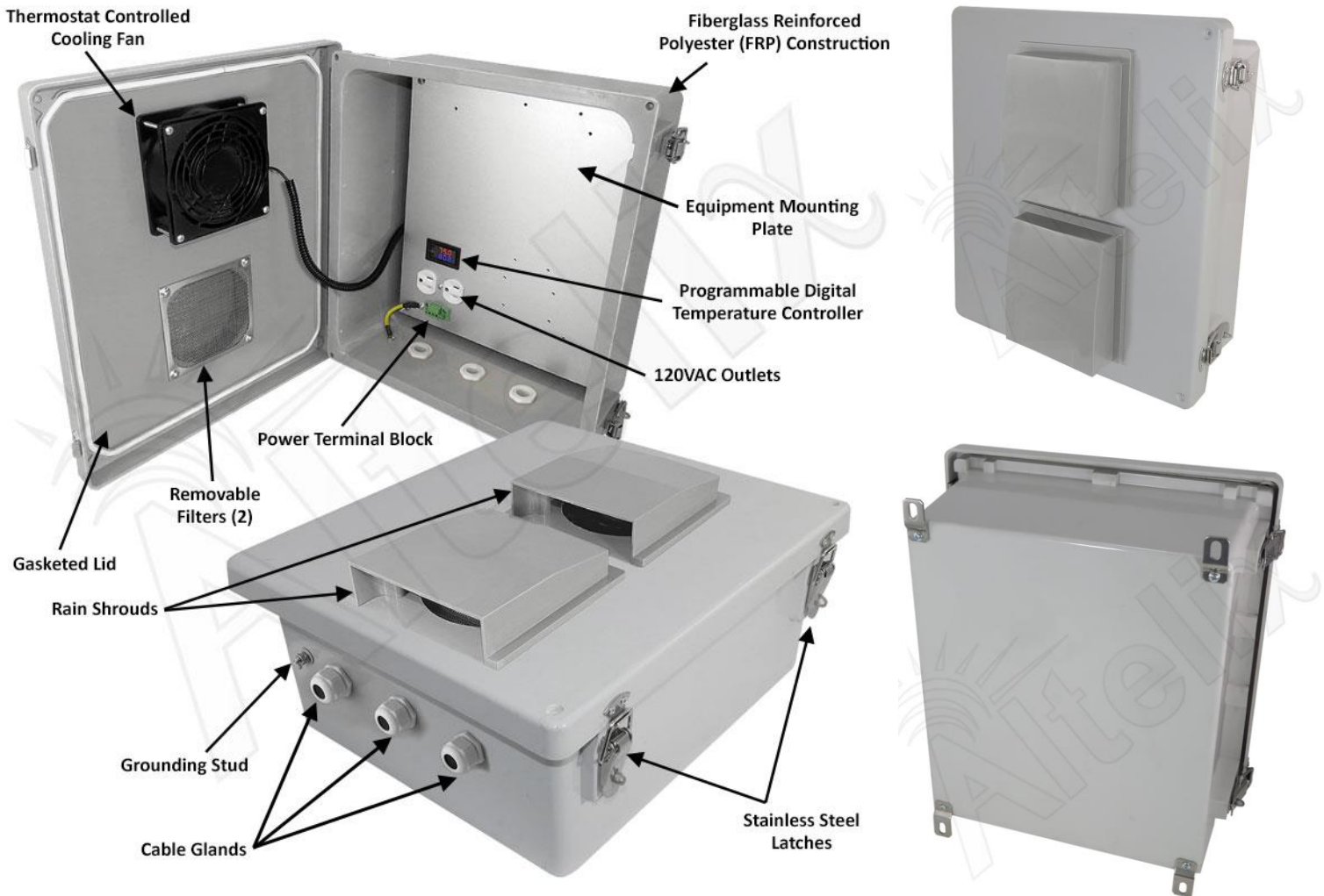

Features

- Cooling Fan with Programmable Digital Temperature Controller
- Two (2) 4" Vents with Rain Shields and Screens
- (2) Pre-Wired 120VAC Outlets
- Removable 120VAC Terminal Block
- Aluminum Equipment Mounting Plate
- Stainless Steel Hinge and Quick Release Latches with Padlock Hasps
- Fiberglass Reinforced Polyester, FRP
- Weatherproof, UV Stable and Highly Corrosion Resistant
- NEMA Type 3R, 3RX / IP24 Rated
- Includes Cable Glands and Stainless Steel Mounting Feet
- RF Transparent Enclosure
- Pole Mounting Kit Available



Description

The **Altelix NF141206VFA1-DF** features two 4" vents and a cooling fan which helps maintain lower internal temperatures. The operation of the cooling fan can be controlled by the programmable digital temperature controller accessible inside the enclosure. The fan can be programmed to turn on and off within a set temperature range set by the user. The controller features a color digital readout and can be programmed for Fahrenheit or Celsius. Rain shrouds keep rain water from entering the enclosure while allowing ventilation for installed equipment.

This enclosure provides two pre-wired 120VAC power outlets and a terminal strip, for easy wiring by a qualified installer. The fan is wired internally, leaving all power outlets available for installed equipment.

Extreme Protection Built to Last

This rugged JIC style NEMA box is molded from durable UV stable and corrosion resistant fiberglass reinforced polyester (FRP) with a UL94-5V flame rating. The FRP material is dent-proof, non-conductive and RF transparent for compatibility with wireless equipment. It can be easily drilled and modified by the installer as needed. It features a gasketed door with stainless steel continuous hinge and stainless steel quick release latches with padlock hasps. The generous size of this enclosure accommodates a wide range of equipment.

Removable Terminal Block

This enclosure features our 120VAC top entry terminal block. It is easily removable which helps simplify on-site wiring. It can accept wires sizes from 12 to 18 AWG. The wires are secured by side terminal screws.

Specifications

Material	Fiberglass Reinforced Polyester
Color	Gray
Voltage	120VAC
Max Load	15A @ 120VAC
Terminal Block Wire Range	12-18 AWG
Terminal Block Wire Strip Length	6-7mm
Digital Controller Temperature Range	14°F (-10°C) to 120°F (60°C)
Outer Dimensions	15.7 x 13.8 x 8.0 Inches (401 x 352 x 205 mm)
Inner Dimensions*	13.0 x 11.0 x 2.7 Inches (330 x 279 x 69 mm)
Mounting Plate Material	0.10 in (2.5 mm) Aluminum
Mounting Plate Dimensions	10.9 x 12.8 in. (276 x 324 mm)
Weight	12.0 lbs. (5.4 kg)
Ratings	NEMA Type 3R, 3RX / IP24
Flame Rating	UL94-5V

*See drawing for detailed dimensions of maximum space available for equipment.