

14x12x6 Fiberglass Weatherproof Vented NEMA Enclosure with 120 VAC Outlets, Power Cord and 85°F Turn-On Cooling Fan

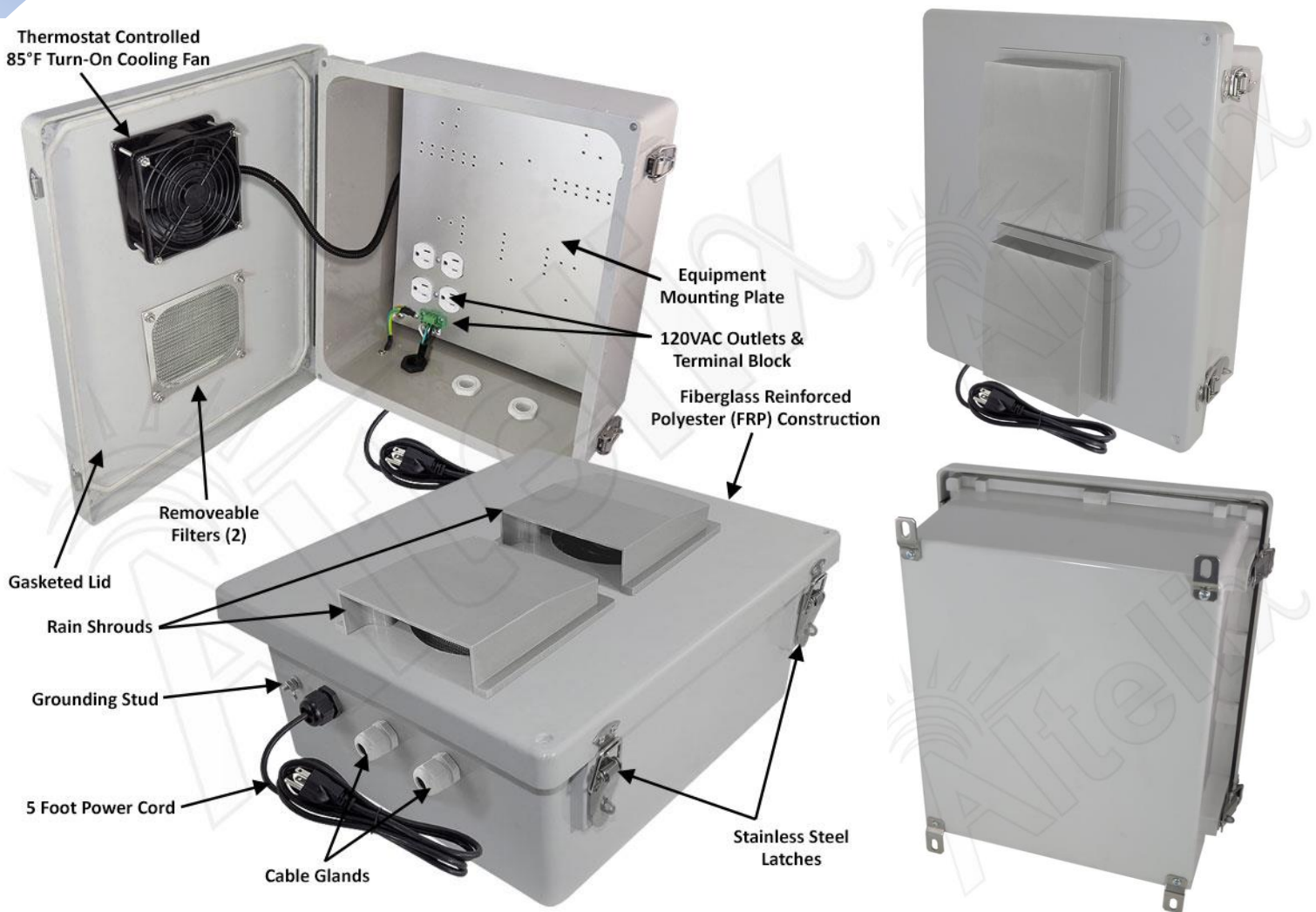

Features

- Thermostat Controlled 85°F (30°C) Turn-On Cooling Fan
- Two (2) 4" Vents with Rain Shields and Screens
- (4) Pre-Wired 120VAC Outlets with 5 Foot Power Cord
- Removable 120VAC Terminal Block
- Aluminum Equipment Mounting Plate
- Stainless Steel Hinge and Quick Release Latches with Padlock Hasps
- Fiberglass Reinforced Polyester, FRP
- Weatherproof, UV Stable and Highly Corrosion Resistant
- NEMA Type 3R, 3RX / IP24 Rated
- Includes Cable Glands and Stainless Steel Mounting Feet
- RF Transparent Enclosure
- Pole Mounting Kit Available

Description

The **Altelix NF141206VFA1C-85** Fan Cooled Vented NEMA Enclosure is ideal for rapid deployment because no wiring is required. Simply mount the enclosure and plug the pre-wired 5 foot power cord into a nearby outlet. The aluminum equipment mounting plate features four pre-wired 120VAC power outlets for your equipment.

Get your project up and running quickly and transition to hard-wired later if needed. The power cord can be easily removed, and the quick-connect terminal strip simplifies hard-wiring by a qualified installer.

Cooling Fan with Thermostat Control - This enclosure features two 4" vents and a thermostat controlled cooling fan which helps maintain lower internal temperatures. The fan turns on when the internal temperature reaches 85°F (30°C) and turns off when it drops to 59°F (15°C). Rain shrouds keep rain water from entering the enclosure while allowing ventilation for installed equipment. The fan is wired internally, leaving all 4 power outlets available for installed equipment.

Extreme Protection Built to Last - This rugged JIC style NEMA box is molded from durable UV stable and corrosion resistant fiberglass reinforced polyester (FRP) with a UL94-5V flame rating. The FRP material is dent-proof, non-conductive and RF transparent for compatibility with wireless equipment. It can be easily drilled and modified by the installer as needed. It features a gasketed door with stainless steel continuous hinge and stainless steel quick release latches with padlock hasps. The generous size of this enclosure accommodates a wide range of equipment.

Specifications

Material	Fiberglass Reinforced Polyester
Color	Gray
Voltage	120VAC
Max Load	10A @ 120VAC
Cooling Fan Turn-On Temperature	85°F (30°C)
Cooling Fan Turn-Off Temperature	59°F (15°C)
Outer Dimensions	15.7 x 13.8 x 8.0 Inches (401 x 352 x 205 mm)
Inner Dimensions*	13.0 x 11.0 x 2.7 Inches (330 x 279 x 69 mm)
Mounting Plate Material	0.10 in (2.5 mm) Aluminum
Mounting Plate Dimensions	10.9 x 12.8 in. (276 x 324 mm)
Weight	12.0 lbs. (5.4 kg)
Power Cord Length	5 Feet (1.5m)
Terminal Block Wire Range / Strip Length	12-18 AWG / 6-7mm
Ratings	NEMA Type 3R, 3RX / IP24
Flame Rating	UL94-5V

*See drawing for detailed dimensions of maximum space available for equipment.