

14x12x6 Fiberglass Weatherproof Vented NEMA Enclosure with 120 VAC Outlets, Power Cord, Cooling Fan and 200W Heater

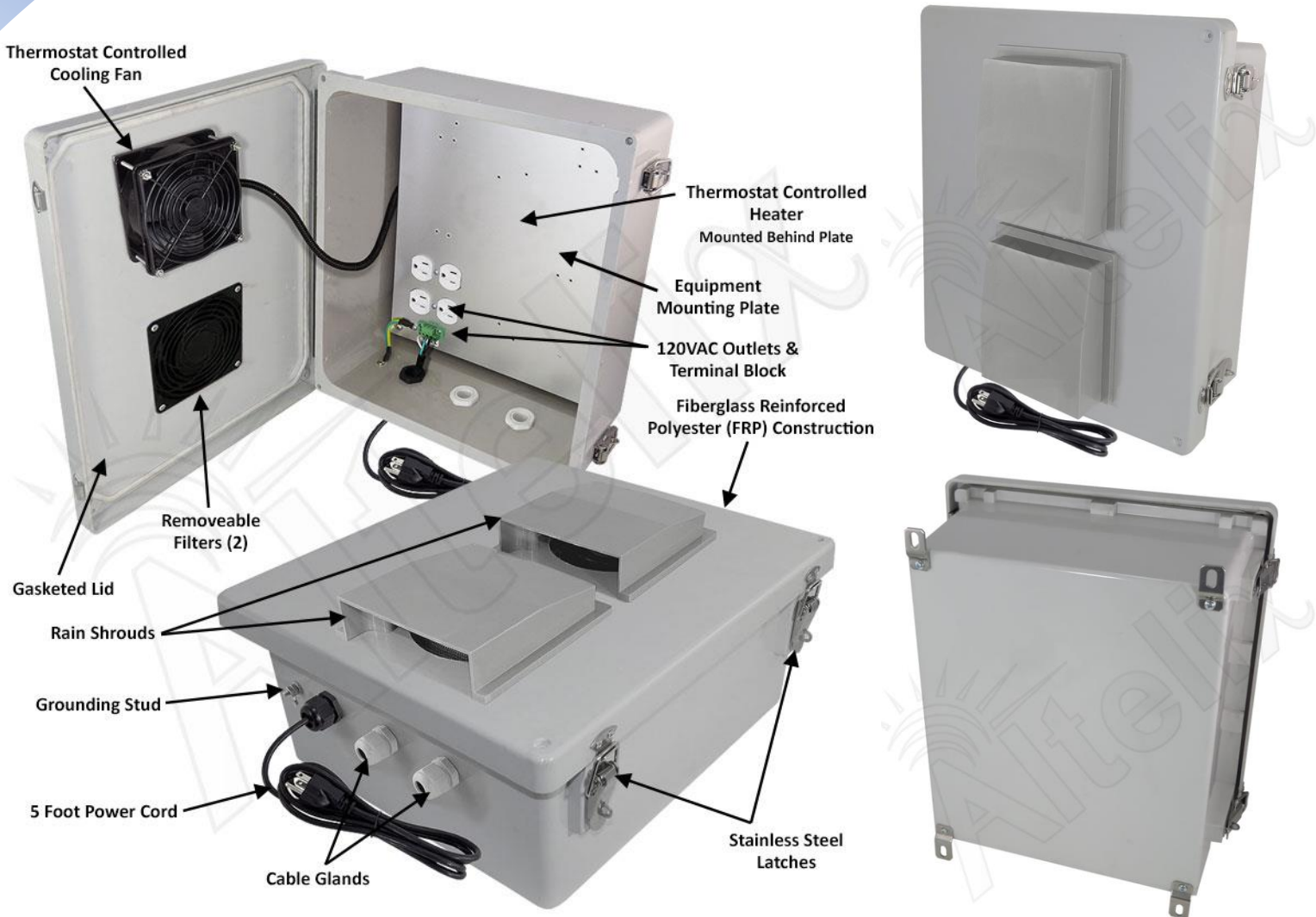

## Features

- Thermostat Controlled Cooling Fan and 200W Heating System
- (2) 4" Vents with Rain Shields and Screens
- (4) Pre-Wired 120VAC Outlets with 5 Foot Power Cord
- Removable 120VAC Terminal Block
- Aluminum Equipment Mounting Plate
- Stainless Steel Hinge and Quick Release Latches with Padlock Hasps
- Fiberglass Reinforced Polyester, FRP
- Weatherproof, UV Stable and Highly Corrosion Resistant
- NEMA Type 3R, 3RX / IP24 Rated
- Includes Cable Glands and Stainless Steel Mounting Feet
- RF Transparent Enclosure
- Pole Mounting Kit Available

## Description

---

The **Altelix NF141206VFHA1C** Heated/Fan Cooled Vented NEMA Enclosure is ideal for rapid deployment because no wiring is required. Simply mount the enclosure and plug the pre-wired 5 foot power cord into a nearby outlet. The aluminum equipment mounting plate features four pre-wired 120VAC power outlets for your equipment.

**Get your project up and running quickly** and transition to hard-wired later if needed. The power cord can be easily removed, and the quick-connect terminal strip simplifies hard-wiring by a qualified installer.

**Thermostat Controlled Cooling Fan and 200W Heating System** - Ideal for outdoor environments where temperatures vary between hot and cold, this enclosure features two 4" vents with rain shrouds and a thermostat controlled cooling fan which helps maintain lower internal temperatures. Controlled by a separate thermostat, the 200W heating system is ideal for harsh weather and cold environments. Both the fan and heater are wired internally, leaving all the power outlets available for installed equipment.

**Extreme Protection Built to Last** - This rugged JIC style NEMA box is molded from durable UV stable and corrosion resistant fiberglass reinforced polyester (FRP) with a UL94-5V flame rating. The FRP material is dent-proof, non-conductive and RF transparent for compatibility with wireless equipment. It can be easily drilled and modified by the installer as needed. It features a gasketed door with stainless steel continuous hinge and stainless steel quick release latches with padlock hasps. The generous size of this enclosure accommodates a wide range of equipment.

## Specifications

---

<b>Material</b>	Fiberglass Reinforced Polyester
<b>Color</b>	Gray
<b>Voltage / Max Load</b>	120VAC / 10A @ 120VAC
<b>Cooling Fan Turn-On Temperature</b>	100°F (38°C)
<b>Cooling Fan Turn-Off Temperature</b>	79°F (26°C)
<b>Heater Turn-On Temperature</b>	43°F (6°C)
<b>Heater Turn-Off Temperature</b>	59°F (15°C)
<b>Heater Power</b>	200 Watts
<b>Outer Dimensions</b>	15.7 x 13.8 x 8.0 Inches (401 x 352 x 205 mm)
<b>Inner Dimensions*</b>	13.0 x 11.0 x 2.7 Inches (330 x 279 x 69 mm)
<b>Mounting Plate Material</b>	0.10 in (2.5 mm) Aluminum
<b>Mounting Plate Dimensions</b>	10.9 x 12.8 in. (276 x 324 mm)
<b>Weight</b>	13.0 lbs. (5.9 kg)
<b>Power Cord Length</b>	5 Feet (1.5m)
<b>Terminal Block Wire Range / Strip Length</b>	12-18 AWG / 6-7mm
<b>Ratings</b>	NEMA Type 3R, 3RX / IP24
<b>Flame Rating</b>	UL94-5V

\*See drawing for detailed dimensions of maximum space available for equipment.