

14x12x8 Insulated Fiberglass Weatherproof Heated NEMA 4X Enclosure with 120 VAC Outlets & 200W Heating System

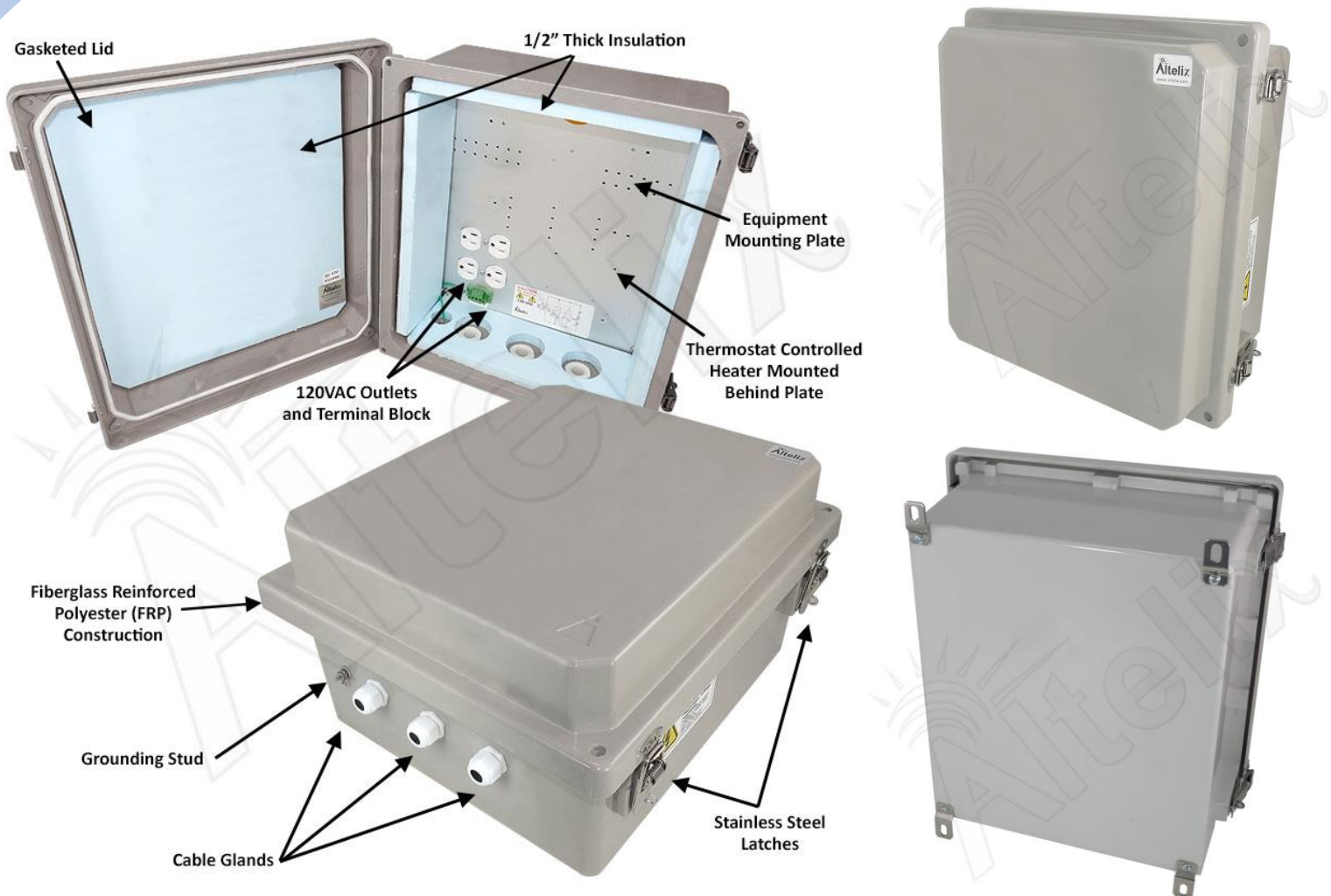

## Features

- 1/2" (12.7mm) Thick RF Transparent Insulation
- Thermostat Controlled 200W Heating System
- (4) Pre-Wired 120VAC Outlets and Removable 120VAC Terminal Block
- Aluminum Equipment Mounting Plate
- Extended Lid for Increased Equipment Clearance
- Stainless Steel Hinge and Quick Release Latches with Padlock Hasps
- Fiberglass Reinforced Polyester, FRP
- Weatherproof, UV Stable and Highly Corrosion Resistant
- Meets NEMA 1, 2, 4, 4X, 12, 13, and IP65, IP66
- Includes Cable Glands and Stainless Steel Mounting Feet
- RF Transparent Enclosure
- Pole Mounting Kit Available

## Description

The **Altelix NF141208HA1-Z** is ideal for extreme cold environments. It features a thermostat controlled 200W heating system. The heater turns on when the internal temperature reaches 43°F (6°C) and turns off when it rises to 59°F (15°C). The heater is mounted below the equipment plate and wired internally so leaves the interior space and power outlets available for your equipment.

This enclosure provides four pre-wired 120VAC power outlets and a terminal block, for easy wiring by a qualified installer.

**Thermal Insulation** - This enclosure features 0.50 inch (12.7mm) thick RF Transparent insulation attached to all interior sides of the enclosure.

**Extreme Protection Built to Last** - This rugged JIC style NEMA box is molded from durable UV stable and corrosion resistant fiberglass reinforced polyester (FRP) with a UL94-5V flame rating. The FRP material is dent-proof, non-conductive and RF transparent for compatibility with wireless equipment. It can be easily drilled and modified by the installer as needed. It features a gasketed door with stainless steel continuous hinge and stainless steel quick release latches with padlock hasps. The generous size of this enclosure and the extended lid accommodate a wide range of equipment.

**Removable Terminal Block** - This enclosure features our 120VAC top entry terminal block. It is easily removable which helps simplify on-site wiring. It can accept wires sizes from 12 to 18 AWG. The wires are secured by side terminal screws.

## Specifications

<b>Material</b>	Fiberglass Reinforced Polyester
<b>Color</b>	Gray
<b>Voltage</b>	120VAC
<b>Max Load</b>	15A @ 120VAC
<b>Heater Turn-On Temperature</b>	43°F (6°C)
<b>Heater Turn-Off Temperature</b>	59°F (15°C)
<b>Heater Power</b>	200 Watts
<b>Insulation Thickness / R-Values</b>	0.50 Inch (12.7mm) Thick / R-Value 2
<b>Terminal Block Wire Range</b>	12-18 AWG
<b>Terminal Block Wire Strip Length</b>	6-7mm
<b>Outer Dimensions</b>	15.7 x 13.8 x 8.6 Inches (401 x 352 x 218 mm)
<b>Inner Dimensions*</b>	12.0 x 10.0 x 6.2 Inches (304 x 254 x 158 mm)
<b>Mounting Plate Material</b>	0.10 in (2.5 mm) Aluminum
<b>Mounting Plate Dimensions</b>	10.9 x 12.8 in. (276 x 324 mm)
<b>Weight</b>	11.7 lbs. (5.3 kg)
<b>Ratings*</b>	NEMA Type 4, 4X / IP66
<b>Flame Rating</b>	UL94-5V

\*Notes

1) Enclosure ports must be properly sealed to maintain NEMA Type 4, 4X / IP66 rating.

2) See drawing for detailed dimensions of maximum space available for equipment.