

12x10x6 NEMA 3X Fiberglass Weatherproof Enclosure with Equipment Mounting Plate, 120 VAC Outlets & Power Cord

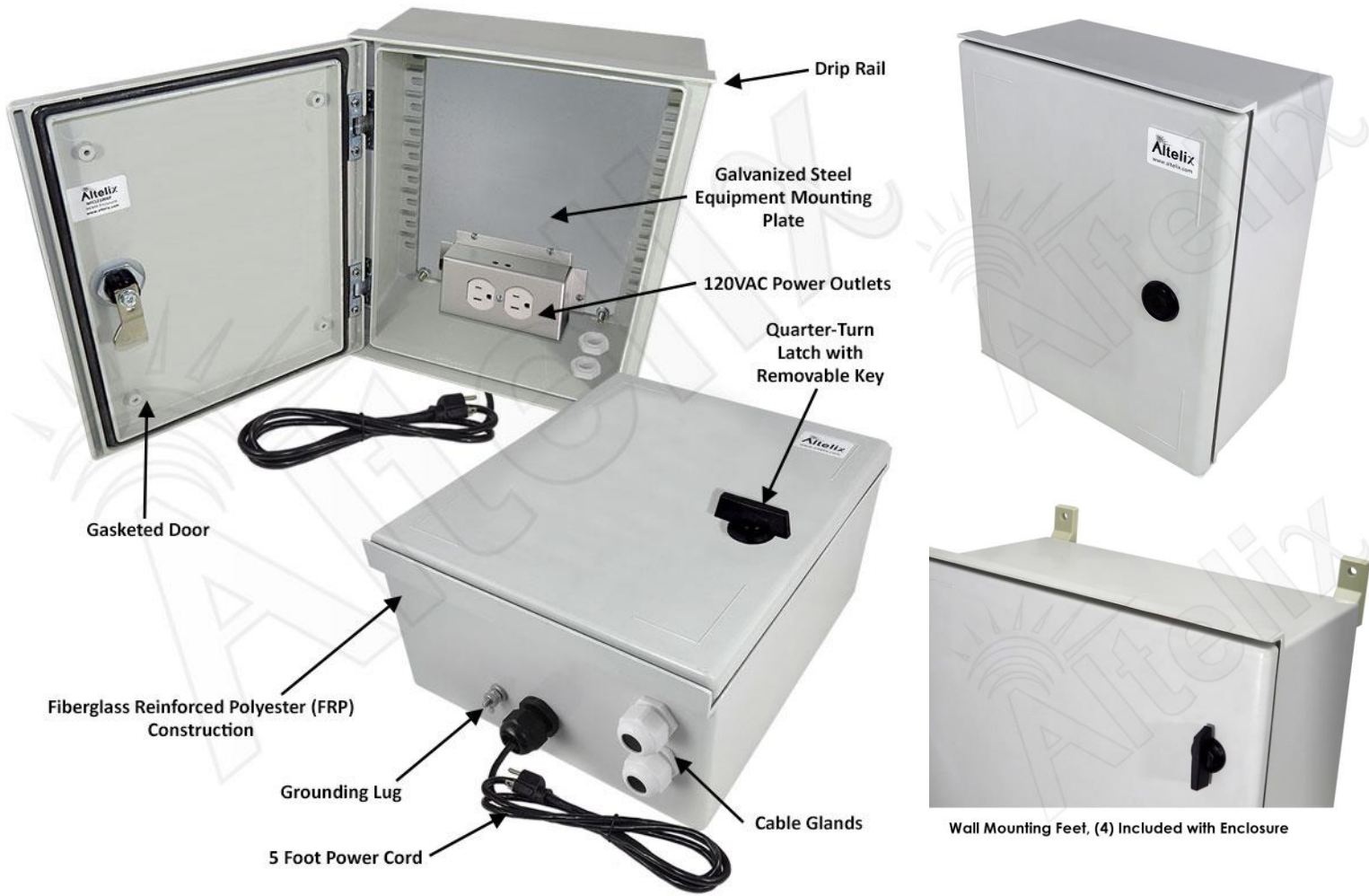

## Features

- Heavy Duty Fiberglass Reinforced Polyester (FRP) Construction
- Galvanized Steel Equipment Mounting Plate
- (2) Pre-Wired 120VAC Power Outlets
- Pre-Wired 5 Foot Power Cord
- Quarter-Turn Door Latch with Removable Key
- (4) Mounting Feet Included
- NEMA Type 3, 3X / IP65 Rated
- Optional Lockable Latch Sets Available

## Description

---

The **Altelix NFC121006A1C** NEMA 3X / IP65 rated enclosure is molded from durable and UV resistant fiberglass reinforced polyester (FRP). The door is fully gasketed making this enclosure suitable for use indoors or outdoors. The lockable door features reinforced hinges and a quarter-turn latch to secure the enclosure and is locked and unlocked using the included removable key. A drip rail over the door provides additional protection against water dripping into the cabinet while the enclosure is wet.

**Galvanized Steel Equipment Mounting Plate** - This configuration consists of the fiberglass NEMA enclosure with hinged lid and a 16 Gauge (1.5mm thick) galvanized steel plate for mounting and securing equipment. The enclosure and plate can be drilled and modified by the installer to suit unique site requirements.

**120VAC Power** - Two pre-wired 120VAC power outlets are provided inside the enclosure to power equipment. A 5 foot pre-wired power cord is included provide power to the internal 120VAC outlets, so no additional wiring is required. Simply mount the enclosure then plug the power cord into a 120VAC outlet.

**Mounting** - Four mounting feet are included so that the enclosure can be securely mounted to a wall or other structure. Optional flange and pole mounting kits are available.

**Optional Lockable Latches** - For additional protection of internal equipment installed, optional keyed latch sets are available. These optional lockable latches are direct replacements for the standard quarter-turn latches that come pre-installed in the enclosure.

## Specifications

---

<b>Material</b>	Fiberglass Reinforced Polyester
<b>Color</b>	Light Gray
<b>Voltage / Max. Load</b>	120VAC / 10A @ 120VAC
<b>Outer Dimensions</b> (Height x Width x Depth)	11.7 x 9.8 x 5.6 Inches (299 x 248 x 143 mm)
<b>Inner Dimensions*</b> (Height x Width x Depth)	7.2 x 8.2 x 3.5 Inches (184 x 210 x 89 mm)
<b>Equipment Plate Material</b>	16 Gauge Galvanized Steel
<b>Equipment Plate Dimensions</b>	7.9 x 10.3 In. (200 x 263 mm)
<b>Power Cord Length</b>	5 Feet (1.5M)
<b>Weight</b>	6.7 lbs. (3.0 kg)
<b>Ratings</b>	NEMA Type 3, 3X / IP65

\*Interior dimensions represent maximum space available for equipment.