

16x12x8 Vented Fiberglass Weatherproof NEMA Enclosure  
with Equipment Mounting Plate, 120 VAC Outlets & Power Cord

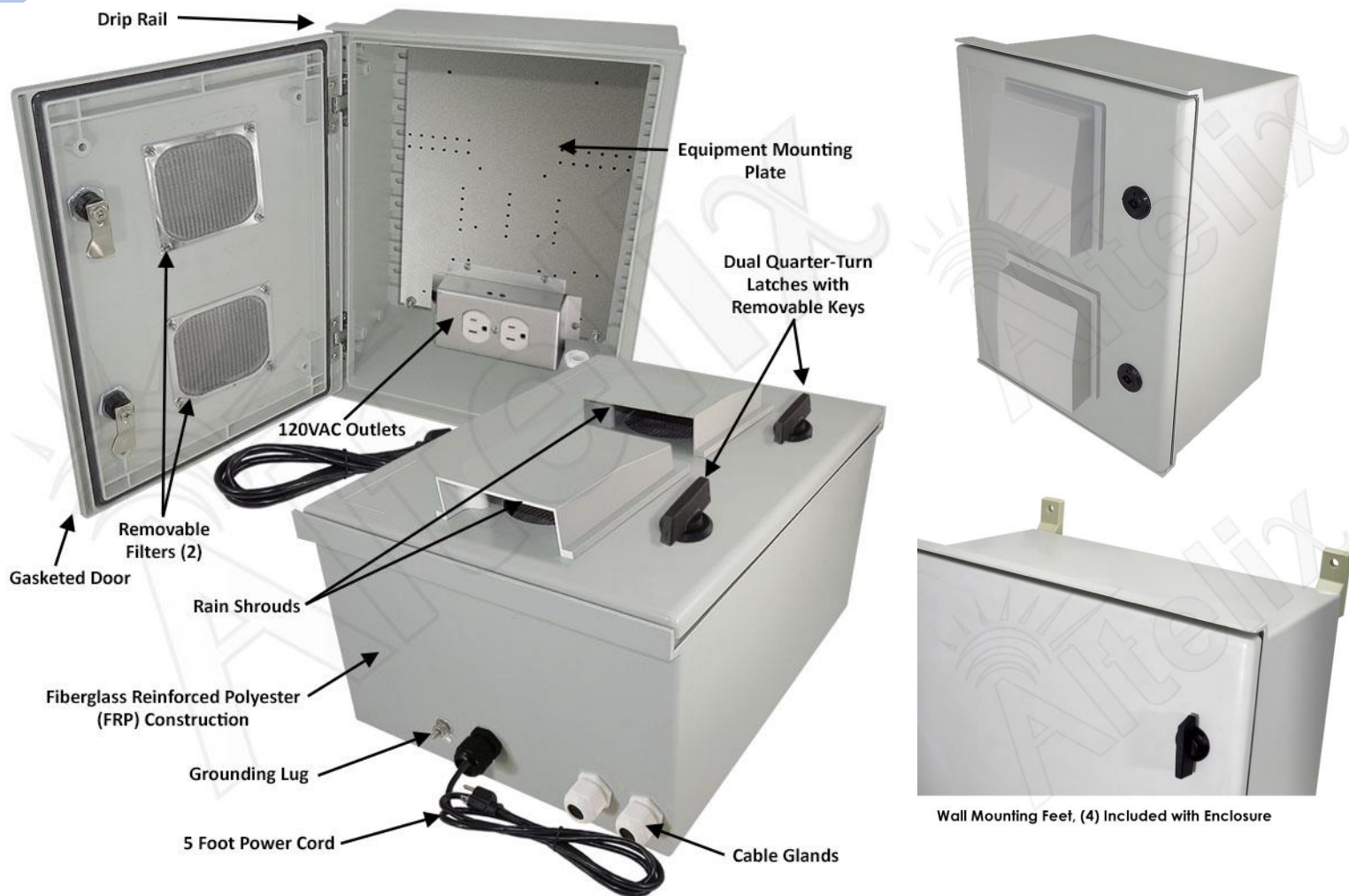

## Features

- (2) 4" Vents with Rain Shields and Screens
- Heavy Duty Fiberglass Reinforced Polyester (FRP) Construction
- Aluminum Equipment Mounting Plate
- (2) Pre-Wired 120VAC Power Outlets
- Pre-Wired 5 Foot Power Cord
- Dual Quarter-Turn Door Latches with Removable Keys
- (4) Mounting Feet Included
- NEMA Type 3R, 3RX / IP24 Rated
- Optional Lockable Latch Sets Available

## Description

---

The **Altelix NFC161208VA1C** enclosure is molded from durable and UV resistant fiberglass reinforced polyester (FRP). The door is fully gasketed making this enclosure suitable for use indoors or outdoors. The lockable door features reinforced hinges and dual quarter-turn latches to secure the enclosure and is locked and unlocked using the included removable keys. A drip rail over the door provides additional protection against water dripping into the cabinet while the enclosure is wet.

**Aluminum Equipment Mounting Plate** - This configuration consists of the fiberglass NEMA enclosure with hinged lid and a 0.08" (2.0mm) thick aluminum plate for mounting and securing equipment.

**120VAC Power** - Two pre-wired 120VAC power outlets are provided inside the enclosure to power equipment. A 5 foot pre-wired power cord is included provide power to the internal 120VAC outlets, so no additional wiring is required. Simply mount the enclosure then plug the power cord into a 120VAC outlet.

**Ventilation** - To help expel heat from within the enclosure, this model features two 4 inch air vents with cleanable aluminum mesh screens which are covered by rain shields.

**Mounting** - Four mounting feet are included so that the enclosure can be securely mounted to a wall or other structure. Optional flange and pole mounting kits are available.

**Optional Lockable Latches** - For additional protection of internal equipment installed, optional keyed latch sets are available. These optional lockable latches are direct replacements for the standard quarter-turn latches that come pre-installed in the enclosure.

## Specifications

---

<b>Material</b>	Fiberglass Reinforced Polyester
<b>Color</b>	Light Gray
<b>Voltage / Max. Load</b>	120VAC / 10A @ 120VAC
<b>Outer Dimensions</b> (Height x Width x Depth)	15.7 x 11.9 x 9.4 Inches (399 x 302 x 239 mm)
<b>Inner Dimensions*</b> (Height x Width x Depth)	10.5 x 10.2 x 5.0 Inches (267 x 260 x 127 mm)
<b>Equipment Plate Material</b>	0.08 In. (2.0 mm) Aluminum
<b>Equipment Plate Dimensions</b>	9.7 x 13.9 In. (246 x 353 mm)
<b>Power Cord Length</b>	5 Feet (1.5M)
<b>Weight</b>	10.0 lbs. (4.5 kg)
<b>Ratings</b>	NEMA Type 3R, 3RX / IP24

\*Interior dimensions represent maximum space available for equipment.