

Shown with Starlink® Mini Installed
(Starlink® Mini Not Included)



Features

- Includes heavy duty tilt-n-swivel mounting bracket to precisely aim the enclosure to achieve the best satellite reception
- RF transparent mounting system designed for the Starlink® Mini
- Angled mounting system for better satellite reception
- Plug-and-Play design, no electrical wiring required
- Durable polycarbonate + ABS construction, weatherproof and UV stable
- Meets NEMA 1, 2, 4, 4X, 12, 13 and IEC 529 IP65, IP66
- Extra deep gasketed lid with dual stainless-steel latches
- Tamper-Proof locking screw with key and provision for padlock
- Can be mounted using external feet or internal mounting points
- (2) Cable glands for Starlink® Mini power and Ethernet cables
- Optional pole mount kits available

Starlink® is a trademark or registered trademark of Space Exploration Technologies Corp.

Description

The **Altelix Starlink® Mini NEMA 4X Aimable Enclosure** is designed to provide the ultimate protection for the Starlink® Mini. This rugged weatherproof enclosure can withstand the harshest environments and provides a way to securely deploy the Starlink® Mini.

Aimable Enclosure for Better Satellite Reception

This enclosure features a heavy duty cast aluminum tilt-n-swivel mounting bracket attached to the rear of the enclosure. This bracket is designed to articulate in both vertical and horizontal planes which allows for precise adjustment and aiming of the enclosure to achieve the best satellite reception. This tilt-n-swivel bracket is designed for both wall and pole/mast mounting. It can be mounted to pole and masts ranging from 1-3 inches in diameter. Using the optional adjustable stainless-steel bands available from Altelix, it can be mounted to poles up to 13 inches in diameter.

Starlink® Mini Mounting System

This enclosure features a RF transparent mounting system located in the lid of the enclosure designed specifically for the Starlink® Mini. Angled up 30 degrees, this mounting system places the Starlink® Mini in the optimal position for the best satellite reception and wireless coverage. Easy to install, simply slide the Starlink® Mini into the mount and lock into place. Two pre-installed cable glands are provided on the enclosure for the Starlink® Mini power and Ethernet cables.

Polycarbonate + ABS Protection Built to Last

Built to last, this enclosure is molded out of UV resistant Polycarbonate + ABS, an industrial grade plastic with greater strength and durability than standard ABS. This enclosure can be easily drilled and modified by the installer to suit unique site requirements. This enclosure meets or exceeds NEMA 1, 2, 4, 4X, 12, 13 and IEC 529 IP65, IP66.

Secure Your Equipment

To better secure the Starlink® Mini this enclosure features dual stainless steel quick release latches. A stainless-steel security screw with keys and a provision for a padlock are also provided.

RF Transparent Design

The non-metallic design of the enclosure and mounting system is RF transparent and will not interfere with the wireless signal range or coverage pattern.

Product Photos

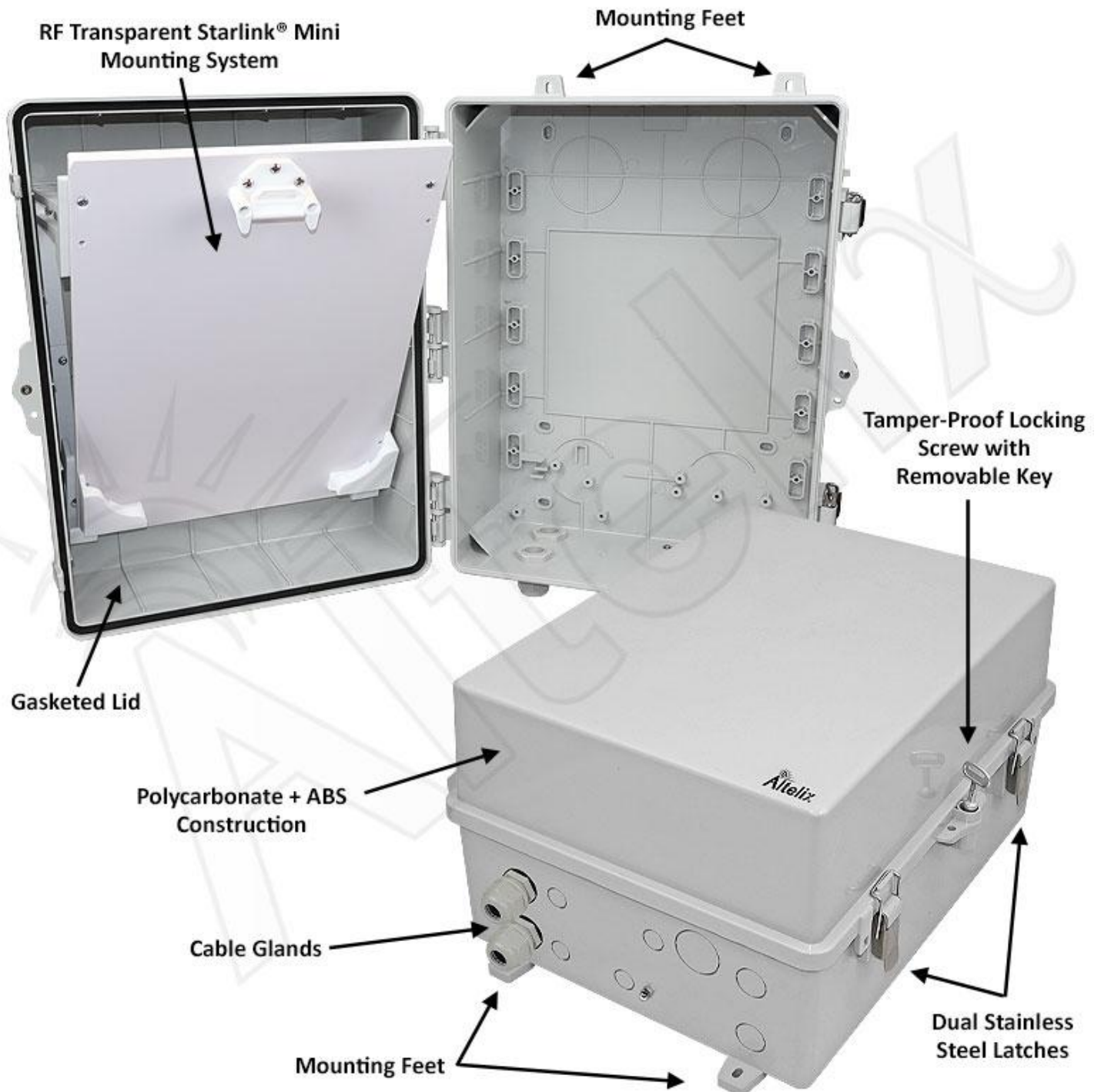

Product Photos

Starlink® Mini Mounting Detail



The Starlink® Mini mounting system in the enclosure lid is angled up 30 degrees to provide better satellite reception.

Product Photos



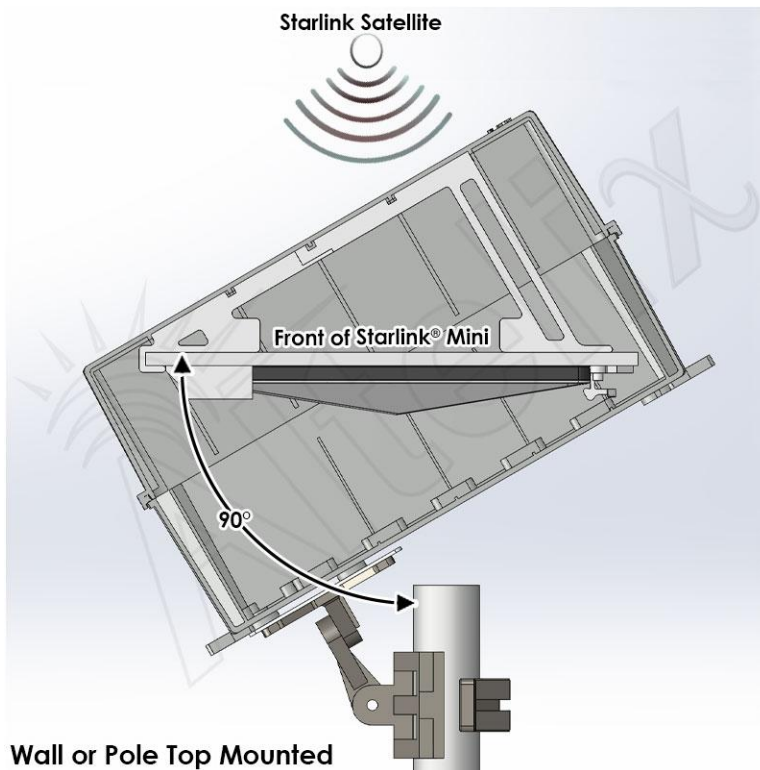
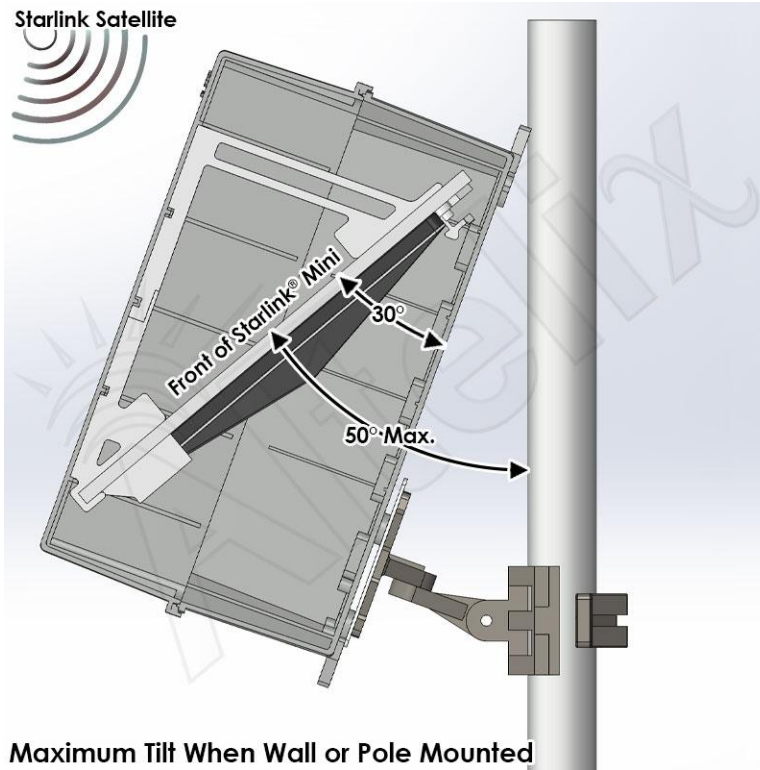

Product Photos



Specifications

Material	PC+ABS Polycarbonate / ABS Blend
Color	Gray
Outer Dimensions	17.1 x 13.6 x 9.3 Inches (435 x 347 x 234 mm)
Inner Dimensions	14.0 x 9.0 x 8.2 inches (355 x 228 x 208 mm)
Weight with Tilt Bracket	9.4 lbs. (4.2 kg)
Mounting Bracket Material	Die-Cast Aluminum
Pole Mounting Diameter Size	1 to 3 Inches (25.4 to 76.2 mm)
Ratings	Meets or Exceeds NEMA 1, 2, 4, 4X, 12, 13 and IEC 529 IP65, IP66
Flame Rating	Meets UL94-V0
Industry Certifications	CE
Knockout Sizes (Diameter)	(4) 0.62 in. (16 mm) (4) 1.02 in. (26 mm) (1) 1.30 in. (33 mm)
Compatible Starlink® Models	Starlink® Mini - Model #UTA-231

Accessories

Model		Description
HNP-001		Weatherproof solid brass padlock.
HN-0004		Replacement door locking key.

Shown with Starlink® Mini Installed
(Starlink® Mini Not Included)



Features

- (2) PoE splitters allow the Starlink® Mini to receive power and data from a single Ethernet cable (up to 825 Feet)
- Heavy duty tilt-n-swivel mounting bracket to precisely aim the enclosure to achieve the best satellite reception
- RF transparent mounting system designed for the Starlink® Mini
- Angled mounting system for better satellite reception
- Durable polycarbonate + ABS construction, weatherproof and UV stable
- Meets NEMA 1, 2, 4, 4X, 12, 13 and IEC 529 IP65, IP66
- Extra deep gasketed lid with dual stainless-steel latches
- Tamper-Proof locking screw with key and provision for padlock
- Can be mounted using external feet or internal mounting points
- (2) Cable glands for Starlink® Mini power and Ethernet cables
- Optional pole mount kits available

Starlink® is a trademark or registered trademark of Space Exploration Technologies Corp.

Description

The **Altelix Starlink® Mini NEMA 4X Aimable PoE Enclosure** allows your Starlink® Mini to receive power and data with a single Ethernet cable (not included) up to 825 feet while providing the ultimate protection. This rugged weatherproof enclosure can withstand the harshest environments and provides a way to securely deploy the Starlink® Mini.

Eliminate Running Multiple Cables

This enclosure includes (2) PoE splitters which allow the Starlink® Mini to receive its power and data from a single Ethernet cable. This eliminates the need for an AC outlet at the enclosure location. The first splitter which is installed near a power source is connected to the Starlink® Mini's power supply as well as a router or PC. From this splitter an Ethernet cable up 825 feet (max length at 1000Mbps) can be run to the enclosure and connected to the second splitter. This second splitter is then connected to the Starlink® Mini's power jack and Ethernet port. This is ideal for remote locations where power is not available.

For added surge protection Altelix has available the optional **ES1000-DIN** Gigabit Ethernet PoE Surge Protector. Installing these protectors at each end of the Ethernet cable helps prevent damage from energy spikes that can be caused by lightning and other strong electrical power surges.

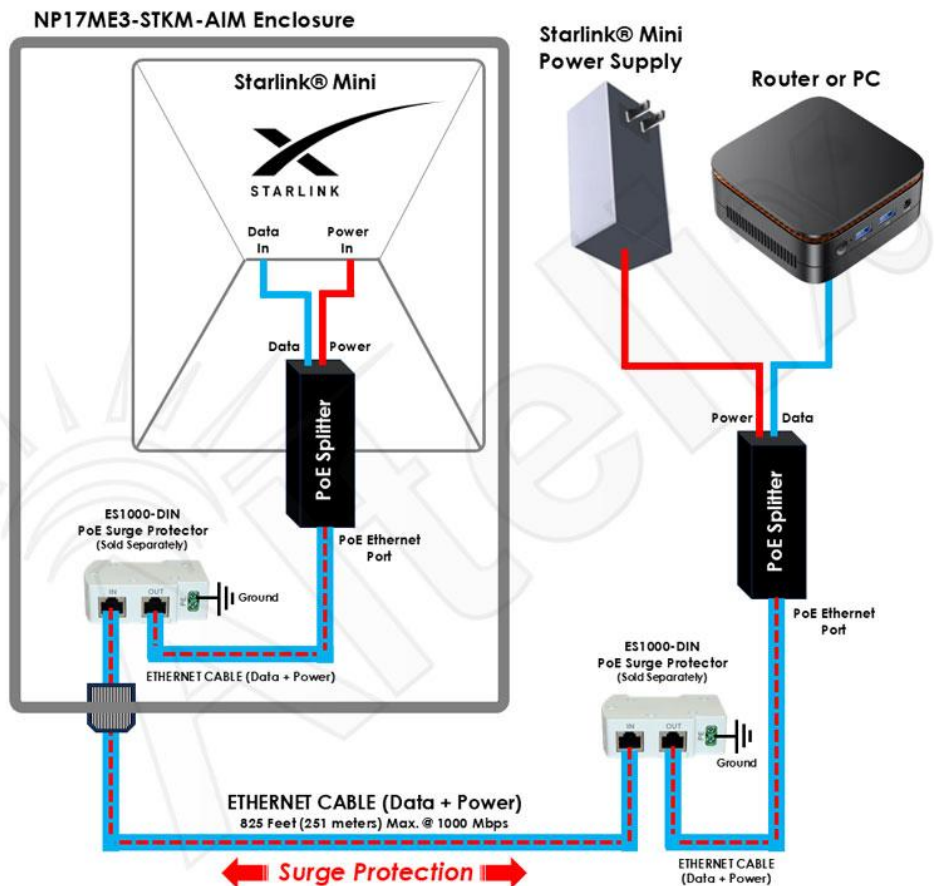

Recommended Setup Diagram

Aimable Enclosure for Better Satellite Reception

This enclosure features a heavy duty cast aluminum tilt-n-swivel mounting bracket attached to the rear of the enclosure. This bracket is designed to articulate in both vertical and horizontal planes which allows for precise adjustment and aiming of the enclosure to achieve the best satellite reception. This tilt-n-swivel bracket is designed for both wall and pole/mast mounting. It can be mounted to pole and masts ranging from 1-3 inches in diameter. Using the optional adjustable stainless steel bands available from Altelix, it can be mounted to poles up to 13 inches in diameter.

Starlink® Mini Mounting System

This enclosure features a RF transparent mounting system located in the lid of the enclosure designed specifically for the Starlink® Mini. Angled up 30 degrees, this mounting system places the Starlink® Mini in the optimal position for the best satellite reception and wireless coverage. Easy to install, simply slide the Starlink® Mini into the mount and lock into place. For installations subject to vibrations such as in vehicles, a hook-n-loop strap is provided. Two pre-installed cable glands are provided on the enclosure for the Starlink® Mini power and Ethernet cables.

Polycarbonate + ABS Protection Built to Last

Built to last, this enclosure is molded out of UV resistant Polycarbonate + ABS, an industrial grade plastic with greater strength and durability than standard ABS. This enclosure can be easily drilled and modified by the installer to suit unique site requirements. This enclosure meets or exceeds NEMA 1, 2, 4, 4X, 12, 13 and IEC 529 IP65, IP66.

Secure Your Equipment

To better secure the Starlink® Mini this enclosure features dual stainless steel quick release latches. A stainless steel security screw with keys and a provision for a padlock are also provided.

RF Transparent Design

The non-metallic design of the enclosure and mounting system is RF transparent and will not interfere with the wireless signal range or coverage pattern.

Product Photos

Enclosure Details

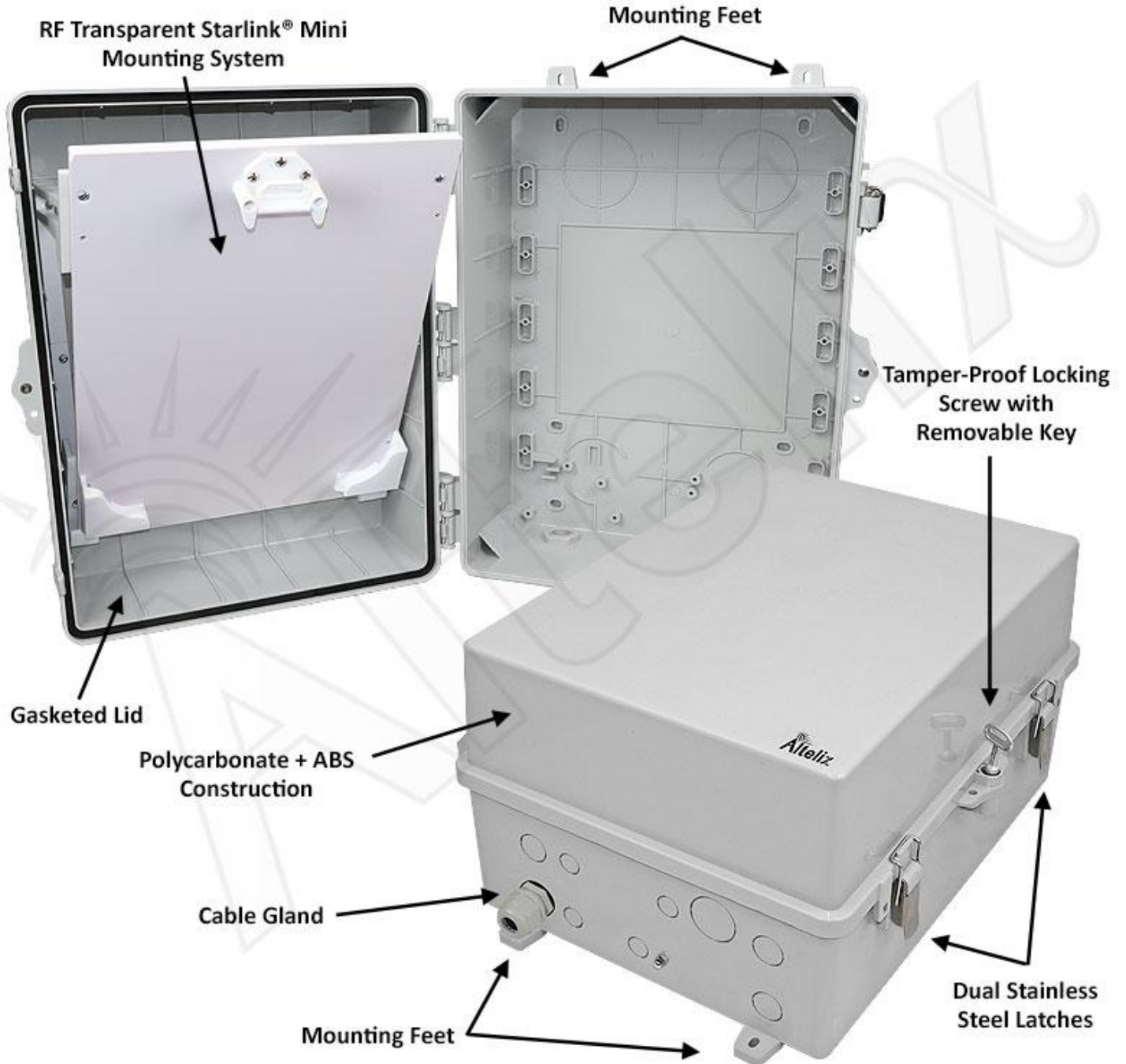

Product Photos

Starlink® Mini Mounting Detail



The Starlink® Mini mounting system in the enclosure lid is angled up 30 degrees to provide better satellite reception.

Product Photos



Product Photos

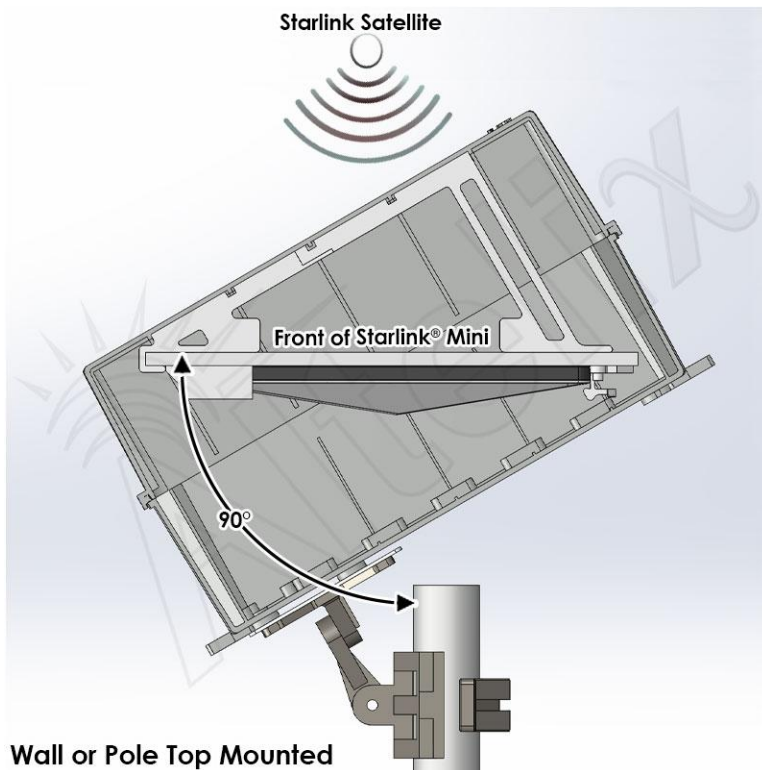
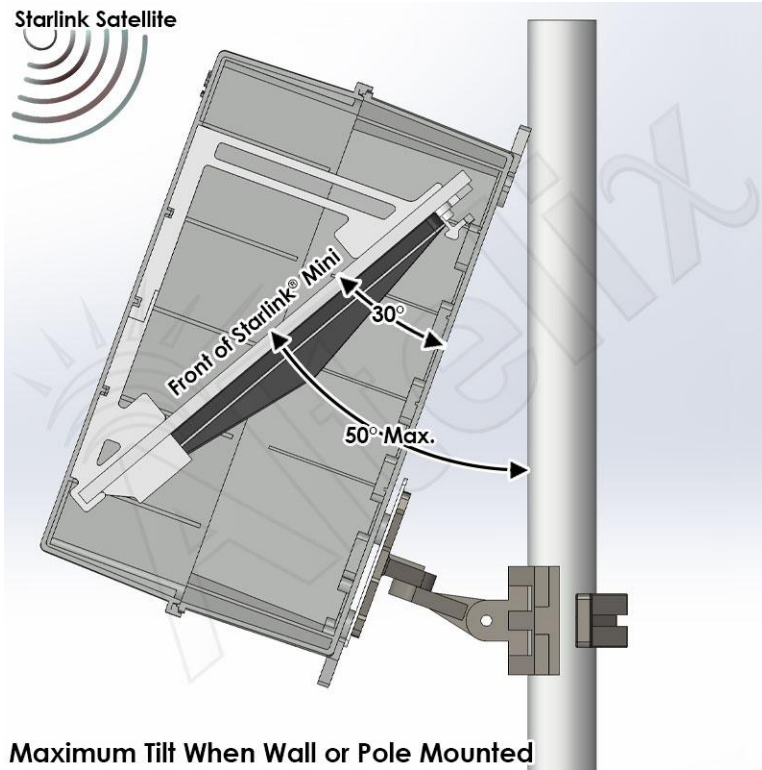

Specifications

Material	PC+ABS Polycarbonate / ABS Blend
Color	Gray
Outer Dimensions	17.1 x 13.6 x 9.3 Inches (435 x 347 x 234 mm)
Inner Dimensions	14.0 x 9.0 x 8.2 inches (355 x 228 x 208 mm)
Weight with Tilt Bracket	9.4 lbs. (4.2 kg)
Mounting Bracket Material	Die-Cast Aluminum
Pole Mounting Diameter Size	1 to 3 Inches (25.4 to 76.2 mm)
PoE Splitters Data Speed	10/100/1000 Mbps
Maximum Ethernet Cable Length	825 Feet (251.4 meters) @ 1000 Mbps
Ratings	Meets or Exceeds NEMA 1, 2, 4, 4X, 12, 13 and IEC 529 IP65, IP66
Flame Rating	Meets UL94-V0
Industry Certifications	CE
Knockout Sizes (Diameter)	(4) 0.62 in. (16 mm) (4) 1.02 in. (26 mm) (1) 1.30 in. (33 mm)
Compatible Starlink® Models	Starlink® Mini - Model #UTA-231

Accessories

Model		Description
ES1000-DIN		Altelix DIN Rail Mount Gigabit Ethernet PoE Surge Protector
DRS-NF12-NP14		35mm Top Hat DIN Rail for NP17 Series Enclosures

Shown with Starlink® Mini Installed
(Starlink® Mini Not Included)



Features

- Heavy duty tilt-n-swivel mounting bracket to precisely aim the enclosure to achieve the best satellite reception
- RF transparent mounting system designed for the Starlink® Mini
- Angled mounting system for better satellite reception
- (2) Internal pre-wired 120VAC power outlets and pre-wired 5 foot 3-prong power cord
- Optional 50W thermostat controlled heater available
- Durable polycarbonate + ABS construction, weatherproof and UV stable
- Meets NEMA 1, 2, 4, 4X, 12, 13 and IEC 529 IP65, IP66
- Extra deep gasketed lid with dual stainless-steel latches
- Tamper-Proof locking screw with key and provision for padlock
- Can be mounted using external feet or internal mounting points
- Cable gland for Starlink® Mini Ethernet cable

Starlink® is a trademark or registered trademark of Space Exploration Technologies Corp.

Description

The **Altelix Starlink® Mini NEMA 4X Aimable Enclosure** is designed to provide the ultimate protection for the Starlink® Mini. This rugged weatherproof enclosure can withstand the harshest environments and provides a way to securely deploy the Starlink® Mini.

Aimable Enclosure for Better Satellite Reception

This enclosure features a heavy duty cast aluminum tilt-n-swivel mounting bracket attached to the rear of the enclosure. This bracket is designed to articulate in both vertical and horizontal planes which allows for precise adjustment and aiming of the enclosure to achieve the best satellite reception. This tilt-n-swivel bracket is designed for both wall and pole/mast mounting. It can be mounted to pole and masts ranging from 1-3 inches in diameter. Using the optional adjustable stainless steel bands available from Altelix, it can be mounted to poles up to 13 inches in diameter.

Starlink® Mini Mounting System

This enclosure features a RF transparent mounting system located in the lid of the enclosure designed specifically for the Starlink® Mini. Angled up 30 degrees, this mounting system places the Starlink® Mini in the optimal position for the best satellite reception and wireless coverage. Easy to install, simply slide the Starlink® Mini into the mount and lock into place. For installations subject to vibrations such as in vehicles, a hook-n-loop strap is provided. A pre-installed cable gland is provided on the enclosure for the Starlink® Mini's Ethernet cable.

Plug and Play Setup

The NP17MA1C-STKM-AIM enclosure provides easy plug-n-play installation. Once the Starlink® Mini is securely mounted inside the enclosure, connect its power supply to the internal 120VAC power outlet. Simply plug the enclosure's 5 foot power cord into an outdoor outlet and you are up and running. This enclosure can be transitioned to hard-wired later if needed. The power cord can be removed and the power receptacle hard-wired by a qualified installer.

50W Thermostat Controlled Heater

For all weather operation the NP17MHA1C-STKM-AIM is available with a 50W thermostat controlled heater. This heater generates a high air-current of warm air due to the design which supports natural convection. The internal design of this heater helps reduce the surface temperatures on the accessible sides of the housing. The heater is mounted in the base of the enclosure and is wired internally leaving the power outlets available for the Starlink® Mini.

Polycarbonate + ABS Protection Built to Last

Built to last, this enclosure is molded out of UV resistant Polycarbonate + ABS, an industrial grade plastic with greater strength and durability than standard ABS. This enclosure can be easily drilled and modified by the installer to suit unique site requirements. This enclosure meets or exceeds NEMA 1, 2, 4, 4X, 12, 13 and IEC 529 IP65, IP66. The non-metallic design of the enclosure and mounting system is RF transparent and will not interfere with the wireless signal range or coverage pattern.

Secure Your Equipment

To better secure the Starlink® Mini this enclosure features dual stainless steel quick release latches. A stainless steel security screw with keys and a provision for a padlock are also provided.

Product Photos

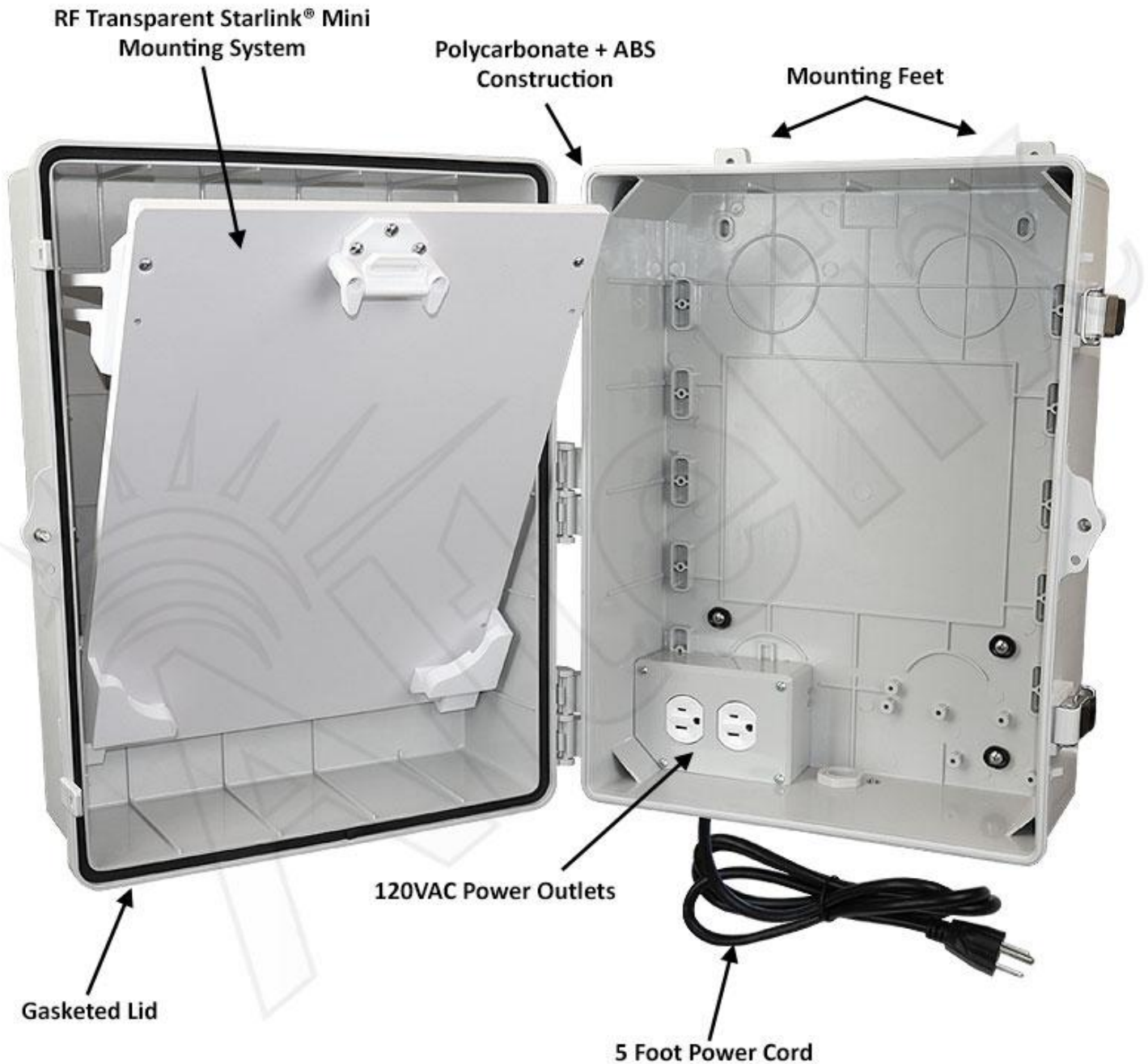

NP17MA1C-STK-AIM with 120VAC Outlets

Product Photos



NP17MHA1C-STKM-AIM with 120VAC Outlets and 50W Heater

Product Photos



Product Photos

Starlink® Mini Mounting Detail



The Starlink® Mini mounting system in the enclosure lid is angled up 30 degrees to provide better satellite reception.

Product Photos



Product Photos

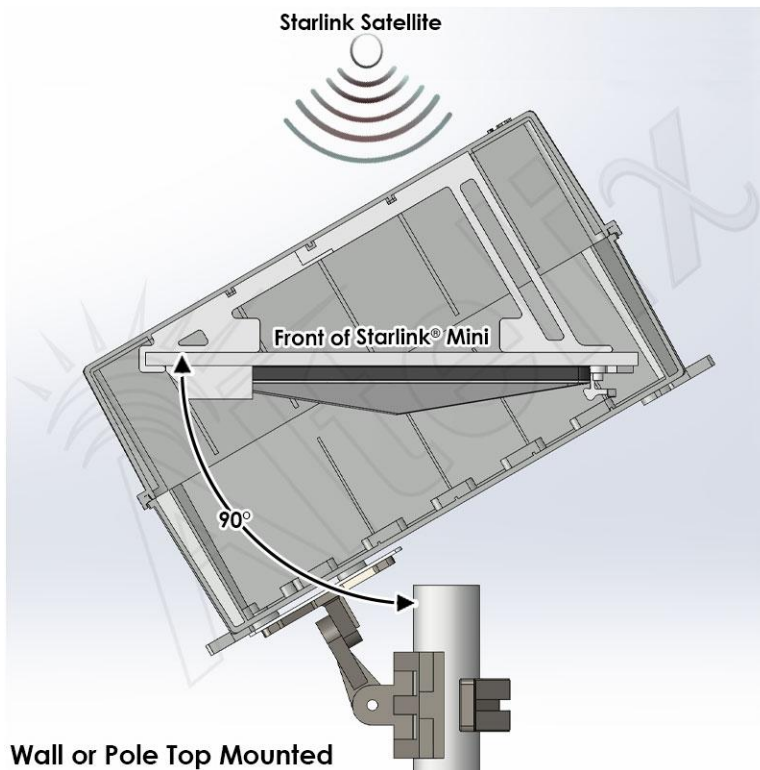
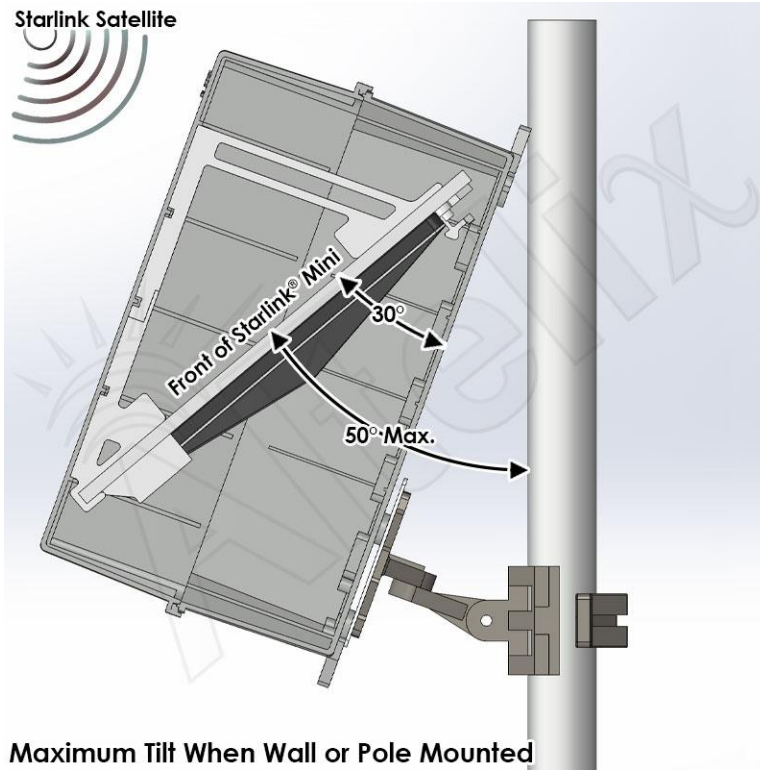

Specifications

Material	PC+ABS Polycarbonate / ABS Blend
Color	Gray
Voltage	120VAC
Max. Load	10A @ 120VAC
Optional Heater Turn-On Temperature	41°F (5°C) ±9°F
Optional Heater Turn-Off Temperature	59°F (15°C) ±9°F
Optional Heater Power	50 Watts
Outer Dimensions	17.1 x 13.6 x 9.3 Inches (435 x 347 x 234 mm)
Inner Dimensions	14.0 x 9.0 x 8.2 inches (355 x 228 x 208 mm)
Weight with Tilt Bracket	10.4 lbs. (4.7 kg)
Mounting Bracket Material	Die-Cast Aluminum
Pole Mounting Diameter Size	1 to 3 Inches (25.4 to 76.2 mm)
Power Cord Length	5 Feet (1.5 meters)
Ratings	Meets or Exceeds NEMA 1, 2, 4, 4X, 12, 13 and IEC 529 IP65, IP66
Flame Rating	Meets UL94-V0
Industry Certifications	CE
Knockout Sizes (Diameter)	(4) 0.62 in. (16 mm) (4) 1.02 in. (26 mm) (1) 1.30 in. (33 mm)
Compatible Starlink® Models	Starlink® Mini - Model #UTA-231