



Features

- Integral Gigabit PoE/PoE+ Repeater/Power Splitter which provides power+data for up to (2) PoE devices
- Dual PoE powered thermostat controlled DC cooling fans
- Designed for ceiling mount applications
- Includes (2) steel 35mm Top Hat DIN Rails for mounting equipment
- Durable Polycarbonate + ABS construction, weatherproof and UV stable
- Meets NEMA 3R, 3RX and IP24
- Gasketed lid with dual stainless steel latches
- Tamper-Proof locking screw with key and provision for padlock
- RF transparent for wireless devices
- Pre-installed 5-Port cable gland for use with pre-terminated Ethernet cables
- Includes (2) locking keys, cable grommets, cable glands, zip ties, hook-n-loop tape and wall mounting hardware
- Optional mounting kits available

Description

The **Altelix NP171407CVFE1-DIN Ceiling Mount PoE Enclosure** is ideal for protecting DIN Rail mounted Power-Over-Ethernet (PoE) enabled equipment from harsh environments and tampering. Using a single Ethernet cable to provide power and data, this enclosure can be installed in remote locations with no power outlets available.

Designed for Ceiling Mount Applications - The NP171407CVFE1-DIN is intended for installation on ceilings in settings such as industrial facilities, commercial buildings, or institutional environments. It can be attached to a wide range of ceiling structures. Optional pole mount kits are also available to mount the enclosure to overhead pipes or truss systems.

Cooling Fan Ventilation - To help manage internal temperatures due to increased heat typical in ceiling environments, the NP171407CVFE1-DIN features dual thermostat controlled PoE powered DC cooling fans. The low noise, high airflow fans help maintain lower internal temperatures. Downward facing vent shrouds on the side of the enclosure help prevent water and falling debris from entering.

Integral Gigabit PoE/PoE+ Repeater / Power Splitter - Featured in this enclosure is an integral Gigabit PoE repeater/power splitter mounted to the equipment mounting plate. This Gigabit PoE splitter is used to power the thermostat controlled DC cooling fans as well as providing data+power to one or two PoE enabled devices installed inside the enclosure. The PoE splitter is compatible with IEEE 802.3af/at standards and features 10/100/1000Mbps data speeds.

35mm Top Hat DIN Rails - Included with this enclosure are (2) 35mm top hat DIN rails for mounting equipment. Using the included screws, these DIN rails mount to raised bosses located in the base of this enclosure. In addition, a large flat section in the base is also provided for use with the hook-n-loop tape included in the accessory kit

RF Transparent Design - Ideal for WiFi applications, the non-metallic design of the enclosure and equipment mounting plate will not interfere with the radio's operation.

Secure Your Equipment - These NP series enclosures feature a gasketed lid with dual stainless steel quick release latches. A stainless steel security screw with keys and a provision for a padlock are also provided.

Polycarbonate + ABS Protection Built to Last - This enclosure is molded out of UV resistant Polycarbonate + ABS, an industrial grade plastic with greater strength and durability than standard ABS. This enclosure can be easily drilled and modified by the installer to suit unique site requirements.

Complete with Cable Grommets and Wire Management Accessories - This enclosure includes an assortment of cable grommets and cable glands that can be installed in the knock-out holes for a weather resistant seal. Also included in the accessory kit are wall anchors, zip ties, wire management loops, hook-n-loop tape, ground wire, (2) door locking keys and more.

Product Photos

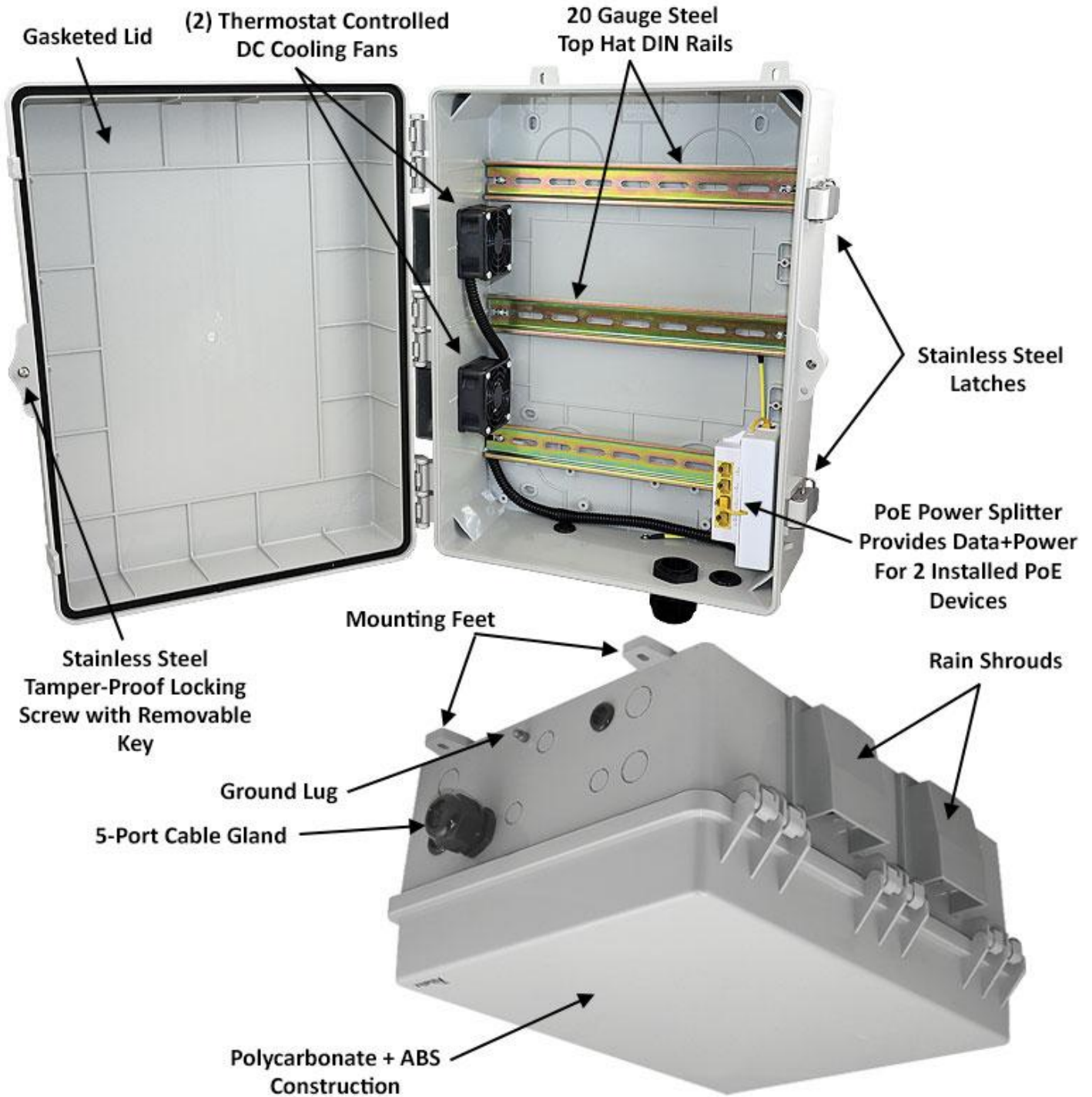

Product Photos

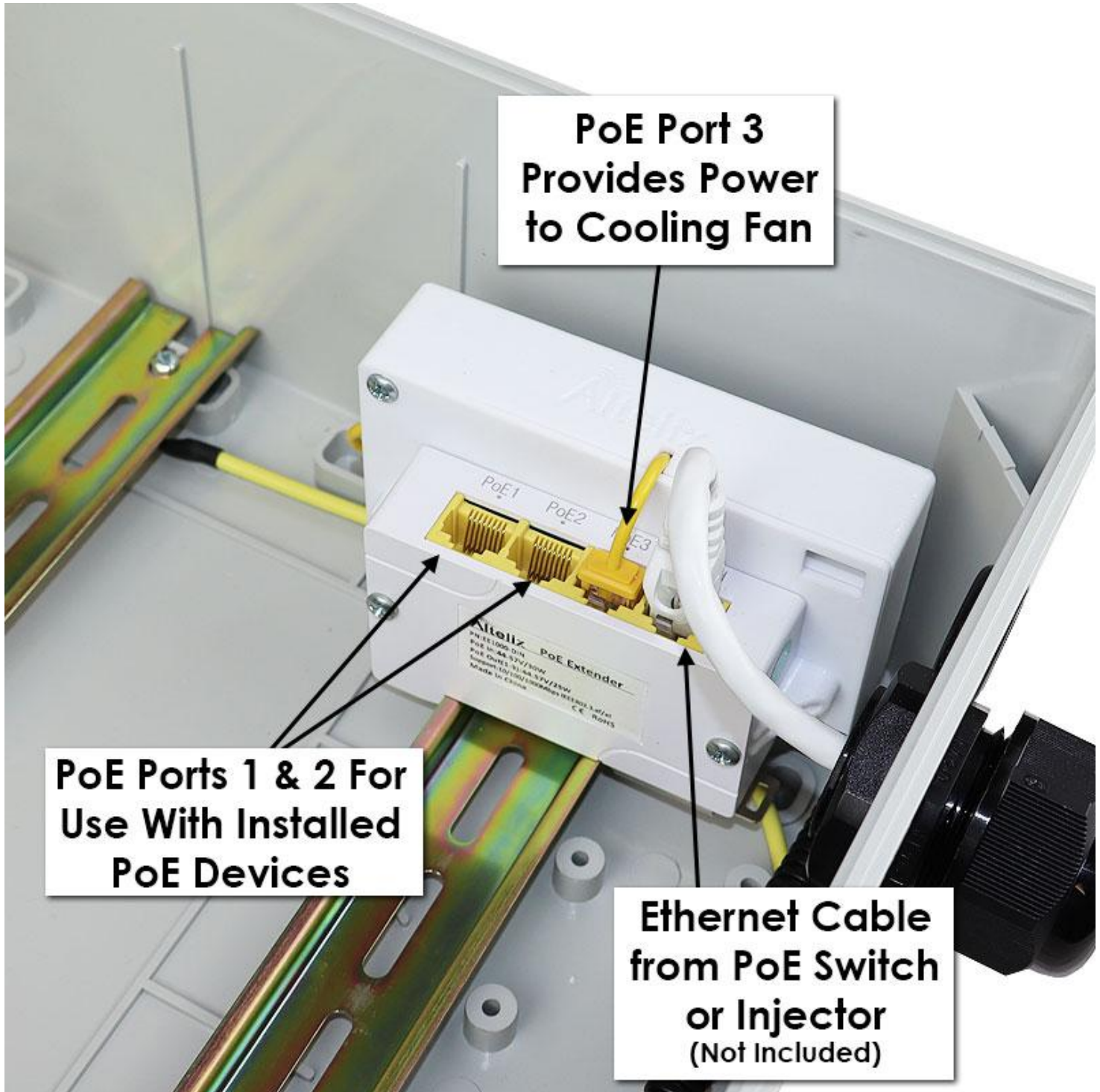

**PoE Port 3
Provides Power
to Cooling Fan**

**PoE Ports 1 & 2 For
Use With Installed
PoE Devices**

**Ethernet Cable
from PoE Switch
or Injector
(Not Included)**

Product Photos



Product Photos



Wiring Diagram

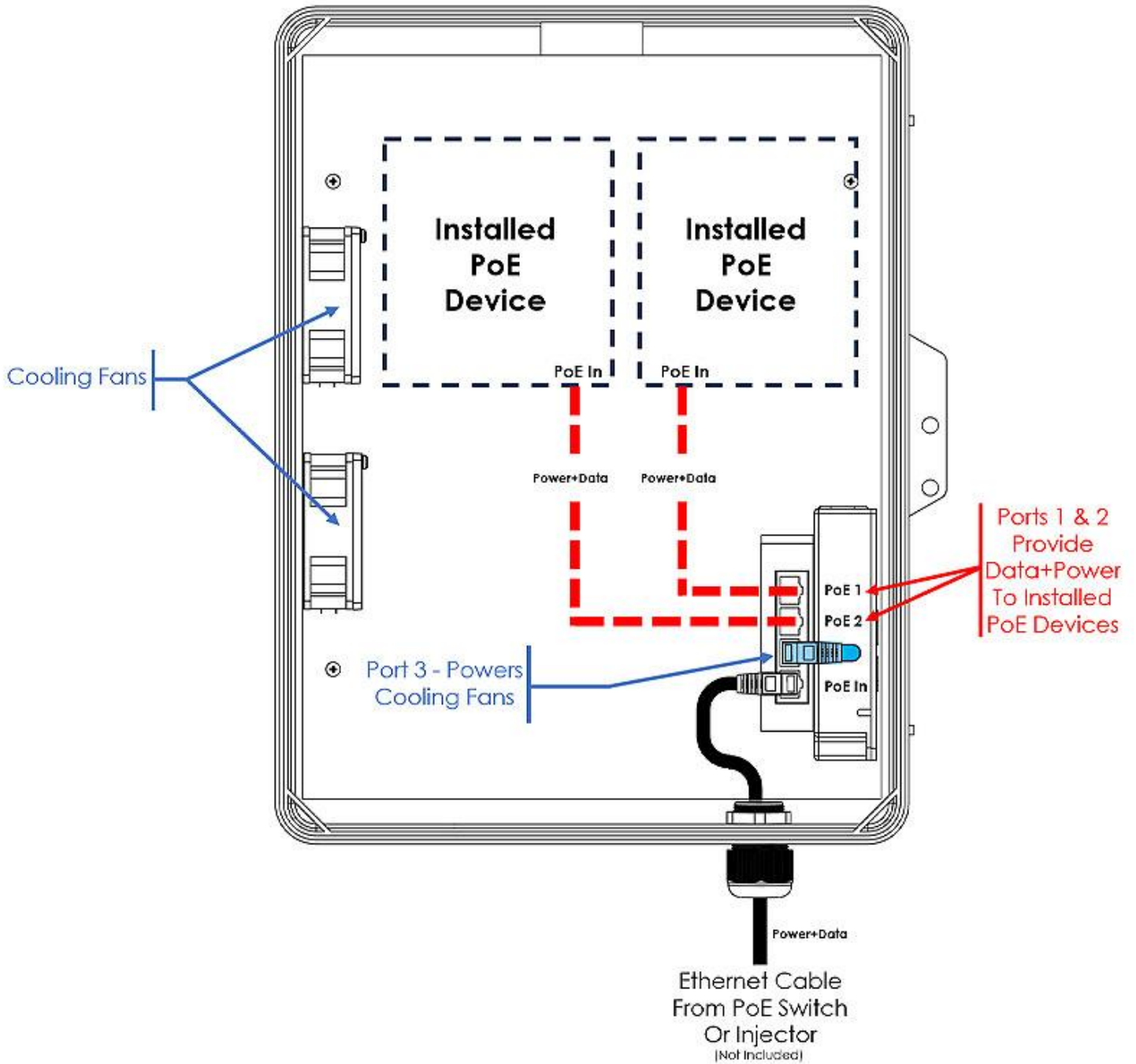

Specifications

Material	PC+ABS Polycarbonate / ABS Blend
Color	Gray
Cooling Fan Turn-On Temperature	100°F (38°C) ±6°F
Cooling Fan Turn-Off Temperature	79°F (26°C) ±9°F
PoE Voltage	44-57 VDC
PoE Input Power	30W Max.
PoE Output Power	24W Max., Average 8W Per Port
Data Speed	10/100/1000 Mbps
PoE Protocol	IEEE 802.3at (30W), IEEE 802.3af (15.4W)
PoE Pinouts	Pins 1/2 (-) Pins 3/3 (+) Pins 4/5 (+) Pins 7/8 (-)
Outer Dimensions (Height x Width x Depth)	17.1 x 13.6 x 7.3 Inches (435 x 347 x 184 mm)
Inner Dimensions* (Height x Width x Depth)	11.8 x 9 x 5.9 inches (299 x 228 x 149 mm)
DIN Rail Length	11.0 in. (279.4 mm)
DIN Rail Material	20 Gauge (0.04 in.) Steel
Weight	7.3 lbs. (3.3 kg)
Ratings	NEMA Type 3R, 3RX / IP24
Flame Rating	Meets UL94-V0
Industry Certifications	CE
Knockout Sizes (Diameter)	(3) 0.62 in. (16 mm) (4) 1.02 in. (26 mm) (1) 1.30 in. (33 mm)

*See drawing for detailed dimensions of maximum space available for equipment.