



**Shown with WiiM® Amp Installed**  
(WiiM® Amp and Cables Not Included)

## Features

- Designed to fit WiiM® Amp and WiiM® Amp Pro Streaming Amplifiers
- Thermostat controlled cooling fan to help expel heat
- Also available with a DIN rail mounted 50W thermostat controlled heater
- (2) pre-wired 120VAC power outlets and pre-wired 5 foot 3-prong power cord
- Durable Polycarbonate + ABS construction, weatherproof and UV stable
- Meets NEMA 3R, 3RX and IP24
- Extra deep gasketed lid with dual stainless steel latches
- Tamper-Proof locking screw with key and provision for padlock
- Can be mounted using external feet or internal mounting points
- Mirror included in accessory kit to provide visibility to controls and indicator lights on installed equipment

WiiM® is a trademark or registered trademark of Linkplay Technology, Inc.

## Description

---

The **Altelix NP17 Series WiiM® Amp Enclosure** is designed to provide indoor or outdoor protection for WiiM® Amp and WiiM® Amp Pro Streaming Amplifier devices. This enclosure is simple to install because no wiring is required. Simply mount the enclosure and plug the pre-wired 5 foot power cord into a nearby outlet. (2) internal pre-wired 120VAC power outlets are provided to power the WiiM® Amp. Get your project up and running quickly and transition to hard-wired later if needed. The power cord can be removed and the power receptacle hard-wired by a qualified installer.

### Plug and Play Installation

Included with this enclosure are brackets to secure the WiiM® Amp to the aluminum equipment mounting plate. Simply attach this bracket to the equipment mounting plate using the supplied screws and install the amplifier. A pre-installed cable gland and grommet on the enclosure allows cables to be connected to the WiiM® Amp. Included in the accessory kit, a self-adhesive mirror can be attached to the inside of the enclosure to provide visibility to any controls and indicator lights on the installed equipment.

### Cooling Fan Ventilation

The NP17AVGY-WIM1 features dual vents and a thermostat controlled cooling fan. The low noise, high airflow fan helps maintain lower internal temperatures. The fan turns on when the internal temperature reaches 100°F (38°C) and turns off when it drops to 79°F (26°C). The fan is wired internally so it does not require the use of the AC outlets leaving them available for internal equipment use. Rain shrouds on the front door keep rain water from entering the enclosure.

### 50W Thermostat Controlled Heater

For all weather operation the NP17AVHGY-WIM1 is available with a 50W thermostat controlled heater in addition to the cooling fan. This heater generates a high air-current of warm air due to the design which supports natural convection. The internal design of this heater helps reduce the surface temperatures on the accessible sides of the housing. The heater turns on when the internal temperature reaches 41°F (5°C) and turns off when it rises to 59°F (15°C). The heater is mounted to a DIN rail in the enclosure lid and is wired internally leaving the power outlets available for the WiiM® Amp.

### Secure Your WiiM® Amp

This enclosure features dual stainless steel quick release latches. A stainless steel security screw with keys and a provision for a padlock are also provided.

**Polycarbonate + ABS Protection Built to Last**

This enclosure is molded out of UV resistant Polycarbonate + ABS, an industrial grade plastic with greater strength and durability than standard ABS. This enclosure can be easily drilled and modified by the installer to suit unique site requirements.

**Complete with Cable Grommets and Wire Management Accessories**

This enclosure includes an assortment of cable grommets and cable glands that can be installed in the knock-out holes for a weather resistant seal. Also included in the accessory kit are wall anchors, zip ties, wire management loops, hook-n-loop tape, ground wire, (2) door locking keys and more.

**Multiple Mounting Options**

This enclosure features (4) external mounting feet which can be used for wall mounting or with our optional pole mounting kit. Mounting points are also provided inside the enclosure. These can be easily drilled out and used for applications requiring a more secure installation.

**Product Photos**

---



**Full access to all  
WiiM® Amp ports**

**Shown with WiiM® Amp Installed  
(WiiM® Amp and Cables Not Included)**

Product Photos

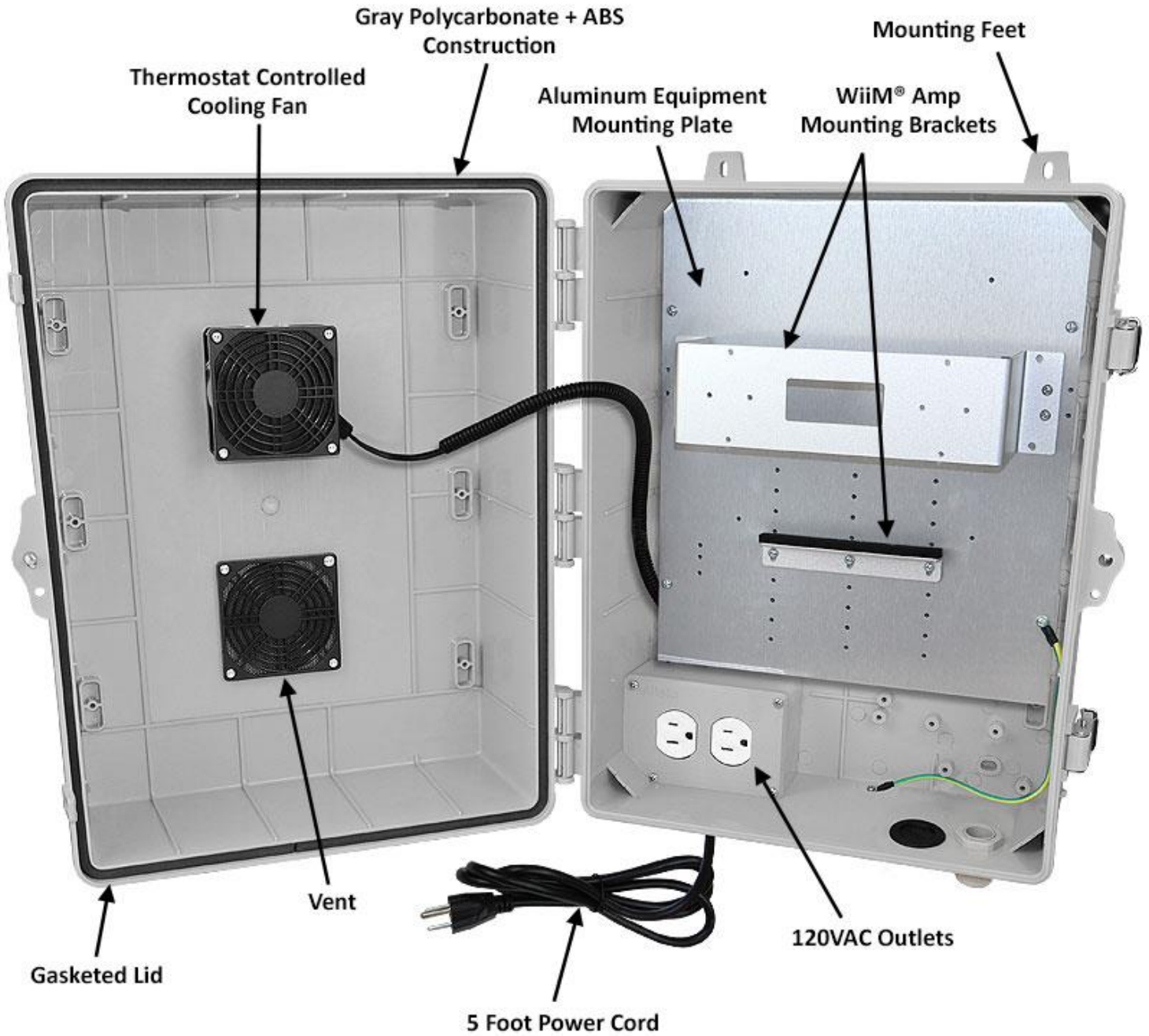

NP17AVGY-WIM1 with Cooling Fan

Product Photos

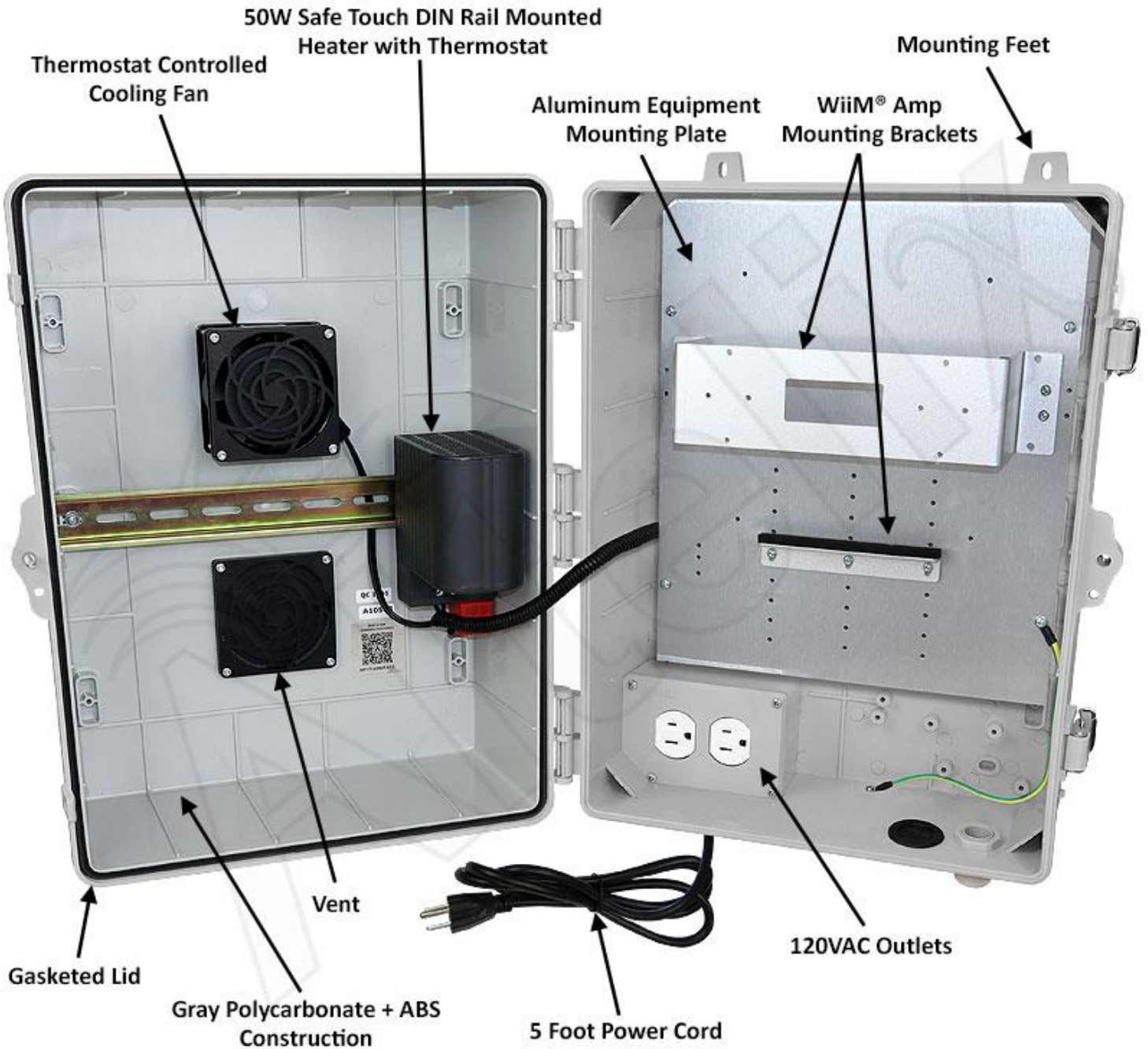

NP17AVHGY-WIM1 with Cooling Fan and 50W Heater

Product Photos

---



## Specifications

---

|   |  |
|---|--|
| <b>Material</b>                             | PC+ABS Polycarbonate / ABS Blend                                     |
| <b>Color</b>                                | Gray   |
| <b>Voltage / Max Load</b>                   | 120VAC / 10A @ 120V  |
| <b>Cooling Fan Turn-On Temperature</b>      | 100°F (38°C) ±6°F  |
| <b>Cooling Fan Turn-Off Temperature</b>     | 79°F (26°C) ±9°F   |
| <b>Optional Heater Turn-On Temperature</b>  | 41°F (5°C) ±9°F  |
| <b>Optional Heater Turn-Off Temperature</b> | 59°F (15°C) ±9°F   |
| <b>Optional Heater Power</b>                | 50 Watts   |
| <b>Outer Dimensions</b>                     | 17.1 x 13.6 x 10.5 Inches (435 x 347 x 266 mm)                       |
| <b>Inner Dimensions</b>                     | 11.8 x 9 x 7.2 inches (299 x 228 x 182 mm)                           |
| <b>Mounting Plate Material</b>              | 0.06 in. (1.5 mm) Aluminum   |
| <b>Weight</b>                               | 8.7 lbs. (3.9 kg)  |
| <b>Power Cord Length</b>                    | 5 Feet (1.5m)  |
| <b>Ratings</b>                              | NEMA Type 3R, 3RX / IP24   |
| <b>Flame Rating</b>                         | Meets UL94-V0  |
| <b>Industry Certifications</b>              | CE   |
| <b>Knockout Sizes (Diameter)</b>            | (4) 0.62 in. (16 mm)<br>(4) 1.02 in. (26 mm)<br>(1) 1.30 in. (33 mm) |
| <b>Compatible WiiM® Amp Models</b>          | WiiM® Amp<br>WiiM® Amp Pro   |