

16x16x8 Steel Weatherproof NEMA Enclosure with Dual Cooling Fans, 120 VAC Power Outlets and Power Cord

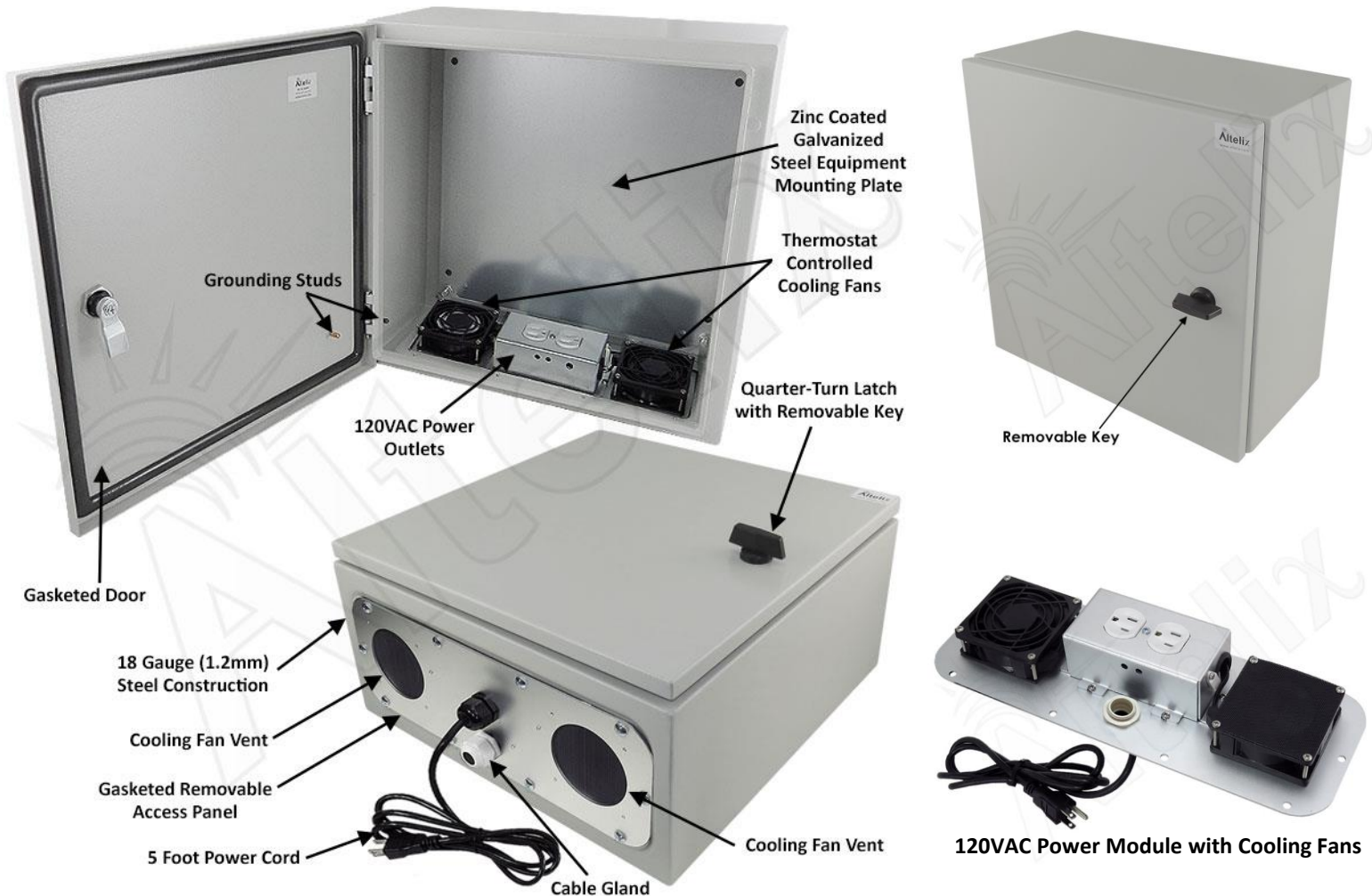

Features

- Dual Thermostat Controlled Cooling Fans
- Removable Power Module with (2) 120VAC Outlets and 5 Ft. Power Cord
- Heavy Duty Continuous Seam Welded 18 Gauge Steel Construction
- Meets NEMA 3R, 3RX and IP24
- Includes Blank Zinc Coated Galvanized Steel Equipment Mounting Plate
- Epoxy Polyester Textured Light Gray Powder Coat Finish
- Quarter-Turn Door Latch with Removable Key
- Optional Keyed Lock Set Latch and Padlock Latch Available

Description

Construction and Features - This rugged vented enclosure features continuous seam welded 18 Gauge (1.2mm thick) steel construction. The enclosure door is fully gasketed making this enclosure suitable for use indoors or outdoors. The door features reinforced hinges and a quarter-turn latch to secure the enclosure. Internal grounding studs are provided on both the door enclosure. Both the enclosure and door are finished in a rugged epoxy polyester textured light gray powder coat finish.

Galvanized Steel Equipment Plate - This configuration consists of the steel NEMA enclosure with hinged door and a 18 Gauge (1.2mm thick) zinc coated galvanized steel plate for mounting and securing equipment. The enclosure and plate can be drilled and modified by the installer to suit unique site requirements.

Removable Power and Fan Module - The NS161608VFA1C features a removable power and fan module that attaches to the bottom of the enclosure. Constructed of rugged aluminum, this can be easily removed for servicing and is fully gasketed to ensure a proper seal. This power module features a pre-wired duplex 120VAC power outlet and a pre-wired 5 foot power cord, so no additional wiring is required.

Dual Cooling Fans Ventilation - This enclosure features dual thermostat-controlled cooling fans. The low noise, high airflow fans help maintain lower internal temperatures by allowing air to be either pushed or pulled through the enclosure. Both fans are wired internally so they do not require the use of the AC outlets leaving them available for internal equipment use.

Specifications

Material	Continuous Seam Welded 18 Gauge (1.2 mm) Steel
Color	Light Gray (RAL 7035)
Voltage / Max. Load	120VAC / 10A @ 120VAC
Cooling Fans Turn-On Temperature	100°F (38°C)
Cooling Fans Turn-Off Temperature	79°F (26°C)
Outer Dimensions (Height x Width x Depth)	15.8 x 15.8 x 7.9 Inches (400 x 400 x 200 mm)
Inner Dimensions* (Height x Width x Depth)	10.0 x 12.0 x 6.3 Inches (254 x 306 x 159 mm)
Equipment Mounting Plate Material	18 Gauge (1.2 mm) Zinc Coated Galvanized Steel
Equipment Mounting Plate Dimensions	14.3 x 13.8 In. (365 x 350 mm)
Weight	19.9 lbs. (9.0 kg)
Power Cord Length	5 Feet (1.5m)
Ratings*	Meets or Exceeds NEMA 3R, 3RX and IP24

*Notes: Interior dimensions represent maximum space available for equipment.