

24x20x12 Vented Steel Weatherproof NEMA Enclosure
with 120 VAC Power Outlets and Power Cord

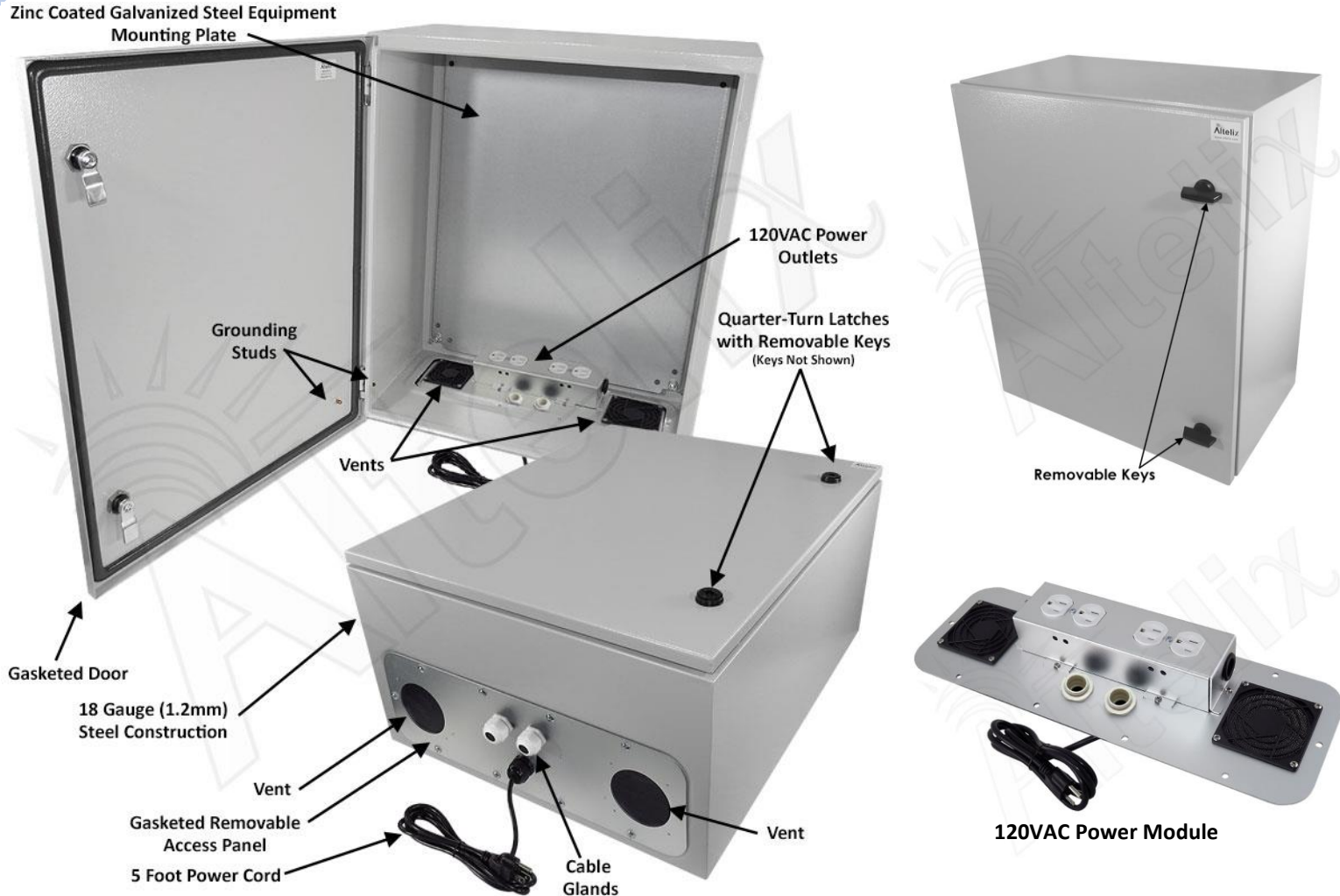

Features

- Dual 3" Vents to Help Expel Heat
- Removable Power Module with (4) 120VAC Outlets and 5 Ft. Power Cord
- Heavy Duty Continuous Seam Welded 18 Gauge Steel Construction
- Meets NEMA 3R, 3RX and IP24
- Includes Blank Zinc Coated Galvanized Steel Equipment Mounting Plate
- Epoxy Polyester Textured Light Gray Powder Coat Finish
- Dual Quarter-Turn Door Latches with Removable Keys
- Optional Keyed Lock Set Latch and Padlock Latch Available

Description

Construction and Features - This rugged vented enclosure features continuous seam welded 18 Gauge (1.2mm thick) steel construction. The enclosure door is fully gasketed making this enclosure suitable for use indoors or outdoors. The door features reinforced hinges and a dual quarter-turn latches to secure the enclosure. Internal grounding studs are provided on both the door enclosure. Both the enclosure and door are finished in a rugged epoxy polyester textured light gray powder coat finish.

Galvanized Steel Equipment Plate - This configuration consists of the steel NEMA enclosure with hinged door and a 18 Gauge (1.2mm thick) zinc coated galvanized steel plate for mounting and securing equipment. The enclosure and plate can be drilled and modified by the installer to suit unique site requirements.

Removable Power Module - The NS242012VA1C features a removable power module that attaches to the bottom of the enclosure. Constructed of rugged aluminum, this can be easily removed for servicing and is fully gasketed to ensure a proper seal. This power module features two pre-wired duplex 120VAC power outlets (4 outlets total) and a pre-wired 5 foot power cord, so no additional wiring is required.

Ventilation - To help expel heat from within the enclosure, this model features two 3" vents located on the removable power module.

Optional Lockable Latches - For additional protection of internal equipment installed, two lockable latches are available. A keyed lock set which includes two keys as well as one that allows the enclosure to be securely locked via use of a padlock (not included). Both are direct replacements for the standard quarter-turn latches that come pre-installed in the enclosures.

Specifications

Material	Continuous Seam Welded 18 Gauge (1.2 mm) Steel
Color	Light Gray (RAL 7035)
Voltage / Max. Load	120VAC / 10A @ 120VAC
Outer Dimensions (Height x Width x Depth)	23.6 x 19.7 x 11.8 Inches (600 x 500 x 300 mm)
Inner Dimensions* (Height x Width x Depth)	18.0 x 16.0 x 10.3 Inches (457 x 406 x 260 mm)
Equipment Mounting Plate Material	18 Gauge (1.2 mm) Zinc Coated Galvanized Steel
Equipment Mounting Plate Dimensions	22.2 x 17.7 In. (565 x 450 mm)
Weight	37.6 lbs. (17.1 kg)
Power Cord Length	5 Feet (1.5m)
Ratings*	Meets or Exceeds NEMA 3R, 3RX and IP24

*Notes: Interior dimensions represent maximum space available for equipment.