

24x24x24 Steel Weatherproof NEMA Enclosure with 19" Wide Adjustable 8U Rack, Dual Door Mounted Cooling Fans, 120 VAC Power Outlets and Power Cord

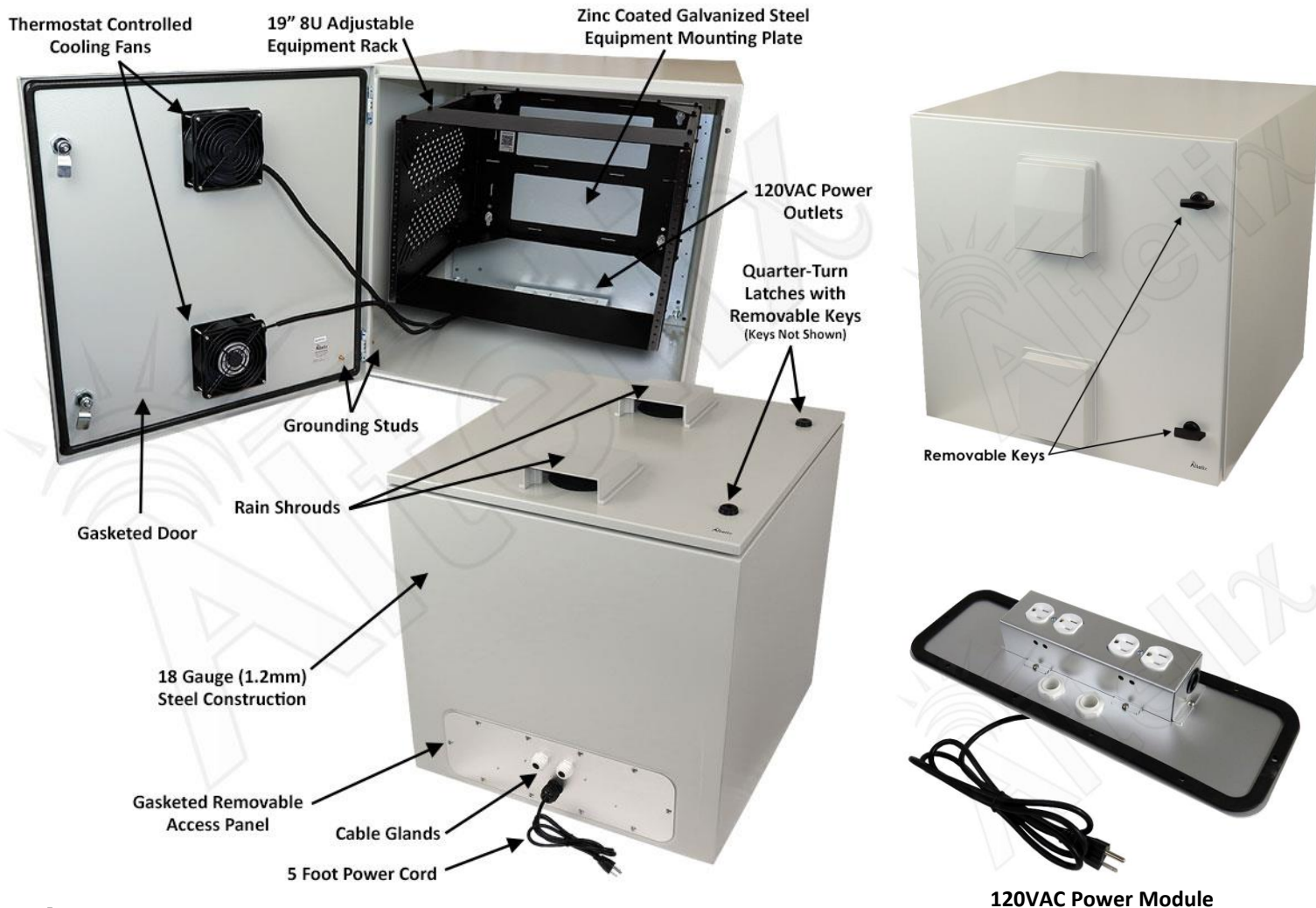

Features

- Dual Door Mounted Thermostat Controlled 120mm Cooling Fans for Better Air Flow
- Powder Coated Aluminum Rain Shrouds
- Removable Power Module with (4) 120VAC Outlets and 5 Ft. Power Cord
- Heavy Duty Continuous Seam Welded 18 Gauge Steel Construction
- Meets NEMA 3R, 3RX and IP24
- Includes Heavy Duty Steel 19" 8U Rack Frame with Adjustable Depth
- Vented Rack Frame Design Ensures Maximum Air Flow Around Installed Equipment
- Extendable Rack Adjusts from 12.3" to 20.3" Deep
- Epoxy Polyester Textured Light Gray Powder Coat Finish
- Dual Quarter-Turn Door Latches with Removable Keys
- Optional Keyed Lock Set Latch and Padlock Latch Available

Description

The **Altelix NS242424LVFA1C-R8U** Steel Fan Cooled Weatherproof NEMA Enclosure with 120VAC Power and Equipment Plate is ideal for protecting rack mountable equipment from harsh environments and tampering. Equipment designed for indoor use can now be located outside.

Construction and Features

This rugged enclosure features continuous seam welded 18 Gauge (1.2mm thick) steel construction. The enclosure door is fully gasketed making this enclosure suitable for use indoors or outdoors. The door features reinforced hinges and dual quarter-turn latches to secure the enclosure. Internal grounding studs are provided on both the door and enclosure. Both the enclosure and door are finished in a rugged epoxy polyester textured light gray powder coat finish.

Removable Power Module

The NS242424LVFA1C-R8U features a removable power module that attaches to the bottom of the enclosure. Constructed of rugged aluminum, this can be easily removed for servicing and is fully gasketed to ensure a proper seal. This power module features two pre-wired duplex 120VAC power outlets (4 outlets total) and a pre-wired 5 foot power cord, so no additional wiring is required.

Dual Door Mounted Cooling Fans Ventilation

This enclosure features two (2) thermostat controlled 120mm cooling fans. These door mounted low noise, high airflow fans provide better air flow through the enclosure than bottom mounted fans and help maintain lower internal temperatures. Both fans are wired internally so it does not require the use of the AC outlets leaving them available for internal equipment use. Powder coated aluminum rain shrouds on the front door keep rainwater from entering the enclosure.

Internal 8U 19" Adjustable Equipment Rack Frame

The NS242424LVFA1C-R8U features a standard 19" 8U equipment rack frame with adjustable depth. It is designed to accommodate a wide range of equipment such as network switches, rack mount audio/video equipment and most other rack mountable equipment. Featuring heavy duty powder coated 15 gauge steel construction, the vented design of this 8U rack frame ensures maximum air flow around installed equipment. The rack frame mounts to a 18 Gauge (1.2mm thick) galvanized steel plate which can also be drilled and modified by the installer to unique site requirements.

Installation Note: This 8U rack has an adjustable depth from 12.3" (313.7mm) to 20.3" (516.9mm). Before ordering please check the dimensions of the equipment to be installed to ensure proper fit.

Cable Glands

The enclosure features two unique PG-16 cable glands with a closed inner seal. They are installed in the open ports to maintain the NEMA rating of the enclosure when not in use. When required for use, simply punch a hole through the inner membrane, run your cables and tighten for a water-tight seal.

Mounting

Mounting holes are provided inside the enclosure for mounting to a wall or other structure. For pole mounting and Rohn Tower mounting, Altelix has optional mounting kits available.

Specifications

Material	Continuous Seam Welded 18 Gauge (1.2 mm) Steel
Color	Light Gray (RAL 7035)
Voltage	120VAC
Max. Load	10A @ 120VAC
Cooling Fans Turn-On Temperature	100°F (38°C)
Cooling Fans Turn-Off Temperature	79°F (26°C)
Outer Dimensions (Height x Width x Depth)	23.6 x 23.6 x 25.1 Inches (600 x 600 x 637.5 mm)
Inner Dimensions* (Height x Width x Depth)	19.75 x 20.0 x 21.0 Inches (502 x 508 x 533.1 mm)
Rack Frame	19" Width 6U
Rack Frame Weight Capacity	75 lbs. (34kg)
Minimum Rack Depth	12.3 inch (313.7mm)
Maximum Rack Depth	20.3 inch (516.9mm)
Equipment Mounting Plate Material	18 Gauge (1.2 mm) Zinc Coated Galvanized Steel
Equipment Mounting Plate Dimensions	22.2 x 21.6 In. (565 x 550 mm)
Weight	77.9 lbs. (35.3 kg)
Power Cord Length	5 Feet (1.5m)
Ratings*	Meets or Exceeds NEMA 3R, 3RX and IP24

*Notes: Interior dimensions represent maximum space available for equipment.