

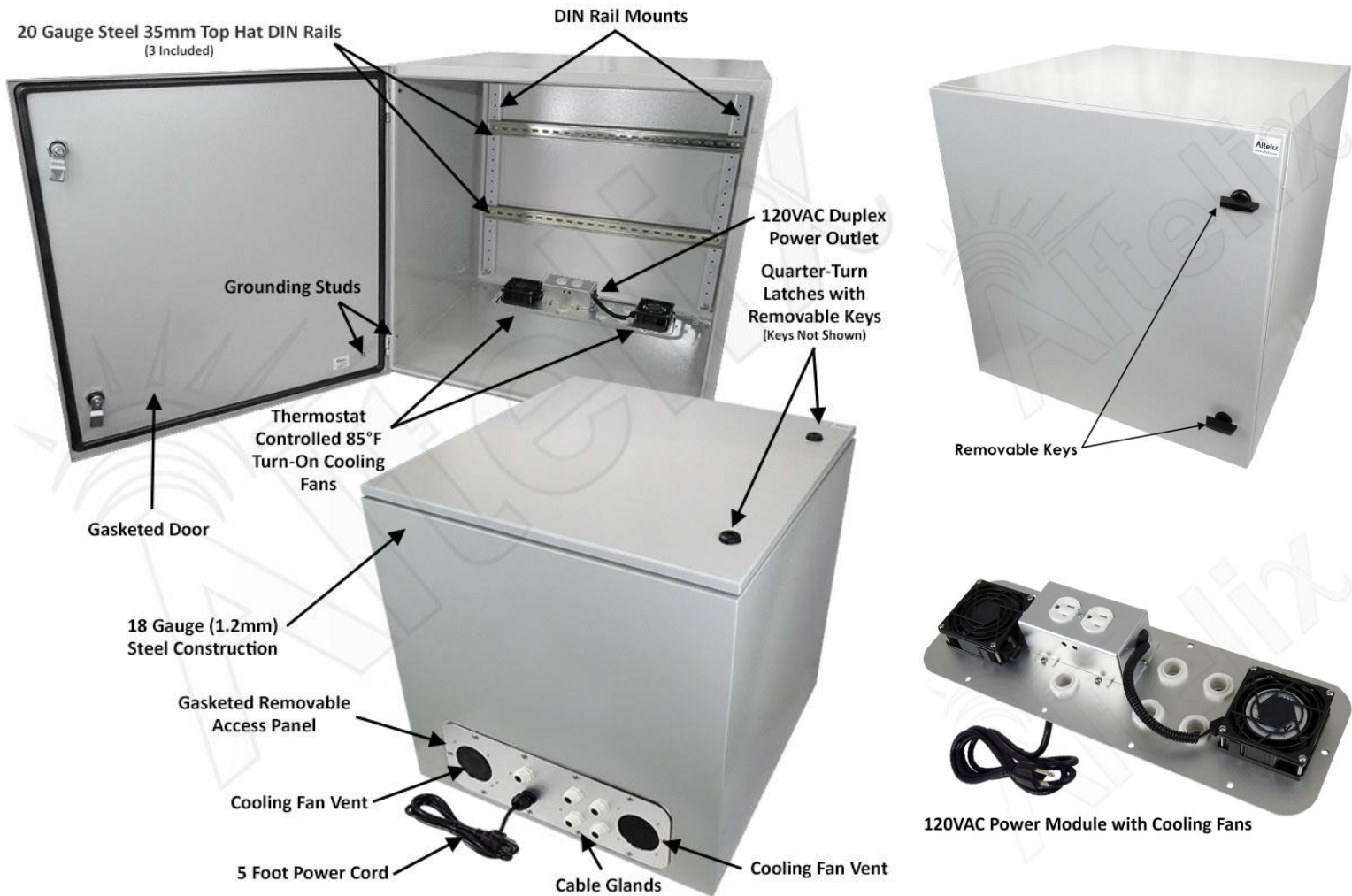

NS242424VFA1R2C-85-DIN

24x24x24 Steel Weatherproof NEMA Enclosure with 35mm DIN Rails, 85°F Turn-On Cooling Fans, Single 120 VAC Duplex Power Outlet and Power Cord



Features

- Dual Thermostat Controlled 85°F Turn-On Cooling Fans
- Removable Power Module with (2) 120VAC Outlets and 5 Ft. Power Cord
- Heavy Duty Continuous Seam Welded 18 Gauge Steel Construction
- Meets NEMA 3R, 3RX and IP24
- Includes (3) 35mm Top Hat DIN Rails and DIN Rail Mounting System with 18 Positions
- Epoxy Polyester Textured Light Gray Powder Coat Finish
- Dual Quarter-Turn Door Latches with Removable Keys
- Optional Keyed Lock Set Latch and Padlock Latch Available

Description

Construction and Features - This rugged vented enclosure features continuous seam welded 18 Gauge (1.2mm thick) steel construction. The enclosure door is fully gasketed making this enclosure suitable for use indoors or outdoors. The door features reinforced hinges and dual quarter-turn latches to secure the enclosure. Internal grounding studs are provided on both the door and enclosure. Both the enclosure and door are finished in a rugged epoxy polyester textured light gray powder coat finish.

DIN Mounting Rails - Included with this enclosure are (2) DIN Mounting Rails. These rails mount to the interior of enclosure and are designed for use with (3) 35mm top hat DIN rails included with the enclosure. This versatile DIN rail mounting system runs the full length of the enclosure from top to bottom. This allows the Top Hat DIN rails to be mounted easily in any of 18 locations providing the flexibility needed when configuring the enclosure for specific user requirements. Hardware for mounting the Top Hat DIN rails is included.

Removable Power and Fan Module - The NS242424VFA1R2C-85-DIN features a removable power and fan module that attaches to the bottom of the enclosure. Constructed of rugged aluminum, this can be easily removed for servicing and is fully gasketed to ensure a proper seal. This power module features a single pre-wired duplex 120VAC power outlet (2 outlets total) and a pre-wired 5 foot power cord, so no additional wiring is required.

85°F Turn-On Cooling Fans - The NS242424VFA1R2C-85-DIN is designed for applications which require the cooling fans to turn on at a lower temperature than our standard fan cooled enclosures. The low noise, high airflow fans help maintain lower internal temperatures by allowing air to be either pushed or pulled through the enclosure. Both fans are wired internally so they do not require the use of the AC outlets leaving them available for internal equipment use.

Specifications

Material	Continuous Seam Welded 18 Gauge (1.2 mm) Steel
Color	Light Gray (RAL 7035)
Voltage / Max. Load	120VAC / 10A @ 120VAC
Cooling Fans Turn-On Temperature	85°F (30°C)
Cooling Fans Turn-Off Temperature	59°F (15°C)
Outer Dimensions (Height x Width x Depth)	23.6 x 23.6 x 23.6 Inches (600 x 600 x 600 mm)
Inner Dimensions* (Height x Width x Depth)	19.7 x 20.0 x 22.0 Inches (502 x 508 x 559 mm)
DIN Rail Length	22.1 In. (562 mm)
DIN Rail Material	20 Gauge (0.04 In.) Steel
Weight	59.4 lbs. (26.9 kg)
Power Cord Length	5 Feet (1.5m)
Ratings*	Meets or Exceeds NEMA 3R, 3RX and IP24

*Notes: Interior dimensions represent maximum space available for equipment.