



Features

- Provide equipment cooling while maintaining NEMA 4X /IP66 protection
- 800 BTU air conditioning and 520W heating system with programmable digital temperature controller
- Externally mounted AC/Heating unit to maximize interior space
- Maintenance free AC/Heater, no moving components, no compressor, refrigerant or filters
- Reliable solid-state construction with long life span
- Digital controller features programmable Under/Over temperature alarms
- Turn-on/Turn-off temperatures for heating and cooling can be programmed separately
- Includes heavy duty steel 19" 6U equipment rack frame with adjustable depth
- (4) Internal pre-wired 120VAC power outlets with 5 Foot 3-prong power cord
- Enclosure features heavy duty continuous seam welded 18 gauge steel construction
- Epoxy polyester textured light gray powder coat finish
- Blank zinc coated galvanized steel equipment mounting plate
- Dual quarter-turn door latches with key
- Enclosure features 0.500" thick interior insulation to help maintain internal temperatures
- Optional wall and pole mounts available

Description

The **Altelix NS322416A1C-AZ-R6U Heated and Air Conditioned** Weatherproof NEMA 4X Enclosure is ideal for protecting sensitive rack mountable equipment from harsh environments and tampering. The digitally controlled heating and air conditioning system helps maintain optimal internal temperatures so internally mounted equipment can operate at peak performance. This enclosure is designed for both indoor and outdoor applications.

Maintenance Free Heating and Air Conditioning System - The NS322416A1C-AZ-R6U features a digitally controlled heating and air conditioning system. Mounted externally on the enclosure to maximize interior space, this system provides 800 BTU of cooling and 520W of heating. Operation of this system is done via a programmable digital temperature controller. Heat and air conditioning Turn-On/Turn-Off temperatures can be separately programmed as well as Under/Over temperature alarms. The entire system is housed in a rugged powder coated steel housing and is mounted to the side of the enclosure. Power for this system is provided by one of the four internal 120VAC power outlets. An external drain on the Heat/AC unit is provided to direct any condensation to outside the enclosure.

Designed to be maintenance free, this AC/Heating system features no moving components (except for fan), no compressor, refrigerant or filters to be changed. Reliable solid-state construction ensures a long operational life span.

Thermal Insulation - To help maintain internal temperatures, this enclosure features 0.50 inch (12.7mm) thick insulation attached to the interior of the enclosure.

Internal 6U 19" Equipment Rack Frame - The NS322416A1C-AZ-R6U features a standard 19" 6U equipment rack frame with adjustable depth. The rack frame mounts to an 18 Gauge (1.2mm thick) galvanized steel plate which can also be drilled and modified by the installer to unique site requirements.

Installation Note: Once installed in the enclosure, this 6U rack has an adjustable depth from 9.5" (241.3mm) to 15.5" (393.7mm). Before ordering please check the dimensions of the equipment to be installed to ensure proper fit.

Enclosure Construction and Features - This rugged enclosure features continuous seam welded 18 Gauge (1.2mm thick) steel construction. The enclosure door is fully gasketed making this enclosure suitable for use indoors or outdoors. The door features reinforced hinges and dual quarter-turn latches to secure the enclosure. Internal grounding studs are provided on both the door and enclosure. Both the enclosure and door are finished in a rugged epoxy polyester textured light gray powder coat finish.

Removable Power Module - The NS322416A1C-AZ-R6U features a removable power module that attaches to the bottom of the enclosure. Constructed of rugged aluminum, this can be easily removed for servicing and is fully gasketed to ensure a proper seal. This power module features two pre-wired duplex 120VAC power outlets (4 outlets total) and a pre-wired 5 foot power cord, so no additional wiring is required.

Mounting - Mounting holes are provided inside the enclosure for mounting to a wall or other structure. Optional heavy-duty pole and wall mounting kits as well as a Rohn tower mounting kit are available in the accessories section.

Product Photos

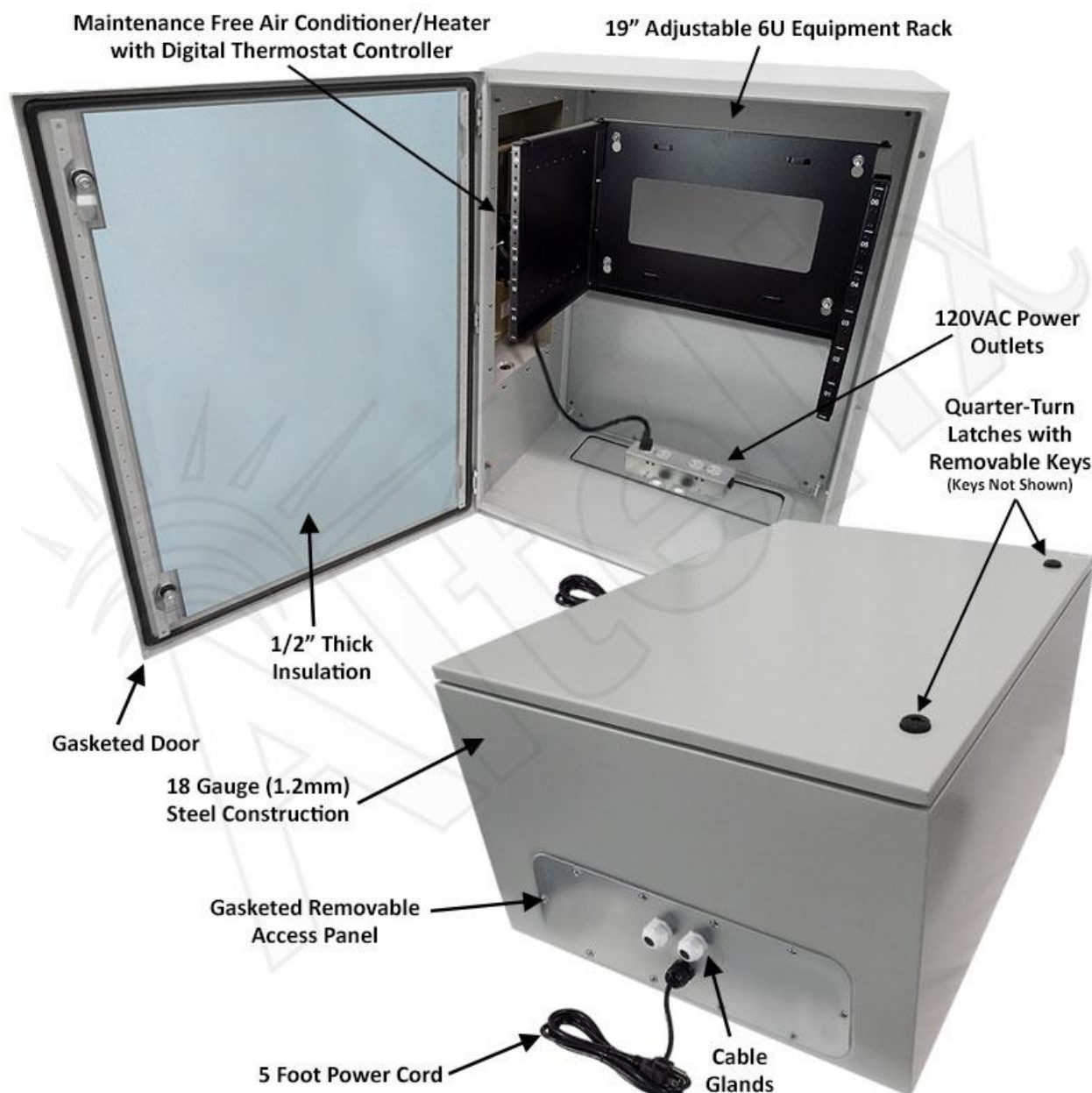

Product Photos



Product Photos

Equipment Rack Detail



**Rack Mount Equipment Shown For Reference,
Not Included**

Product Photos



120VAC Power Module Detail

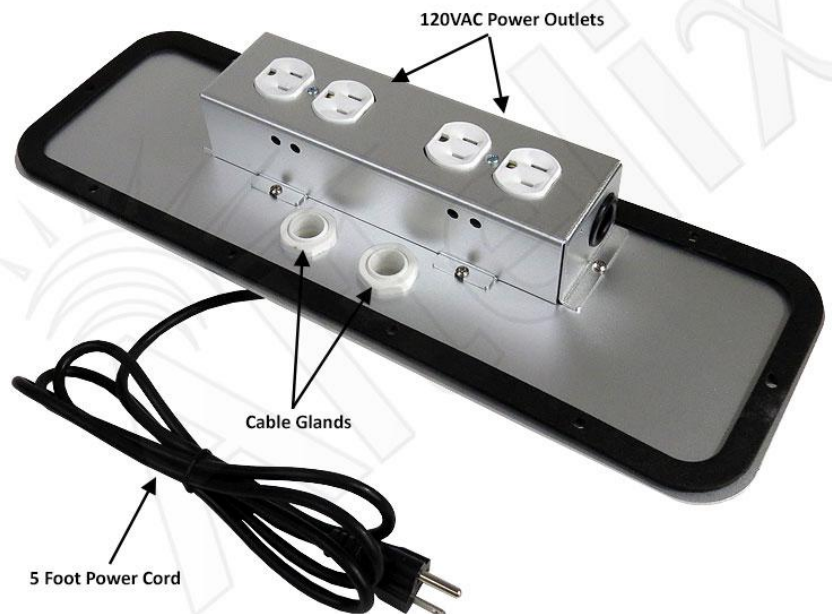

Specifications

Material	Continuous Seam Welded 18 Gauge (1.2 mm) Steel
Color	Light Gray (RAL 7035)
Enclosure Voltage	120VAC
Max. Load	10A @ 120VAC
Cooling Capacity	800 BTU
Heating Capacity	520W
Digital Controller Operational Temperature Range	-22°F (-30°C) to +140°F (+60°C)
AC/Heater Working Voltage	100-260VAC
Insulation Thickness	0.50 inch (12.7mm)
Insulation R-Value	2
Exterior Dimensions (Height x Width x Depth)	31.5 x 31.6 x 15.7 In. (800 x 802.6 x 400 mm)
Interior Dimensions (Height x Width x Depth)	26.0 x 20.0 x 14.1 In. (660 x 508 x 358 mm)
Rack Frame	19" Width 6U
Rack Frame Weight Capacity	75 lbs. (34kg)
Minimum Rack Depth	9.5 in. (243.3 mm)
Maximum Rack Depth*	15.5 in. (393.7 mm)
Equipment Mounting Plate Material	18 Gauge (1.2 mm) Zinc Coated Galvanized Steel
Equipment Mounting Plate Dimensions	30.1 x 21.6 In. (765 x 550 mm)
Weight	110.2 lbs. (50 kg)
Noise Level	65dB
Power Cord Length	5 Feet (1.5m)
Ratings	Meets or Exceeds NEMA 1, 2, 4, 4X, 12, 13 and IEC 529 IP65, IP66

*Notes:

Rack frame max. depth is based on depth of enclosure.