



Features

- Provide equipment cooling while maintaining NEMA 4X /IP66 protection
- DC powered 800 BTU air conditioning and 520W heating system with programmable digital temperature controller
- Externally mounted AC/Heating unit to maximize interior space
- Maintenance free AC/Heater with no moving components, no compressor, refrigerant or filters
- Reliable solid-state construction with long life span
- Digital controller features programmable Under/Over temperature alarms
- Turn-on/Turn-off temperatures for heating and cooling can be programmed separately
- Available for 12VDC, 24VDC or 48VDC applications
- Enclosure features heavy duty continuous seam welded 18 gauge steel construction
- Epoxy polyester textured light gray powder coat finish
- Blank zinc coated galvanized steel equipment mounting plate
- Dual quarter-turn door latches with key
- Enclosure features 0.500" thick interior insulation to help maintain internal temperatures
- Optional wall and pole mounts available

Description

The **Altelix NS322416D-AZ DC Powered** Heated and Air Conditioned Weatherproof NEMA 4X Enclosure is ideal for protecting sensitive equipment from harsh environments and tampering. The digitally controlled heating and air conditioning system helps maintain optimal internal temperatures so internally mounted equipment can operate at peak performance. This enclosure is designed for both indoor and outdoor applications. Available in 12VDC, 24VDC or 48VDC models, this enclosure can be powered from DC solar and battery power sources.

Maintenance Free Heating and Air Conditioning System - The NS322416D-AZ features a DC powered digitally controlled heating and air conditioning system. Mounted externally on the enclosure to maximize interior space, this system provides 800 BTU of cooling and 520W of heating. Operation of this system is done via a programmable digital temperature controller. Heat and air conditioning Turn-On/Turn-Off temperatures can be separately programmed as well as Under/Over temperature alarms. The entire system is housed in a rugged powder coated steel housing and is mounted to the side of the enclosure. An external drain on the Heat/AC unit is provided to direct any condensation to outside the enclosure.

Designed to be maintenance free, this AC/Heating system features no moving components (except for fan), no compressor, refrigerant or filters to be changed. Reliable solid-state construction ensures a long operational life span.

Thermal Insulation - To help maintain internal temperatures, this enclosure features 0.50 inch (12.7mm) thick insulation attached to the interior of the enclosure.

Enclosure Construction and Features - This rugged enclosure features continuous seam welded 18 Gauge (1.2mm thick) steel construction. The enclosure door is fully gasketed making this enclosure suitable for use indoors or outdoors. The door features reinforced hinges and dual quarter-turn latches to secure the enclosure. Both the enclosure and door are finished in a rugged epoxy polyester textured light gray powder coat finish.

Removable Access Panels - The NS322416D-AZ includes a gasketed blank access panel which is ideal for custom applications. Optional access panels are also available which include features such as pre-installed cable glands and MC4 solar power connectors.

Galvanized Steel Equipment Plate - This configuration consists of the steel NEMA enclosure with hinged door and a 18 Gauge (1.2mm thick) zinc coated galvanized steel plate for mounting and securing equipment. The enclosure and plate can be drilled and modified by the installer to suit unique site requirements.

Mounting - Mounting holes are provided inside the enclosure for mounting to a wall or other structure. Optional heavy-duty pole and wall mounting kits as well as a Rohn tower mounting kit are available in the accessories section.

Product Photos

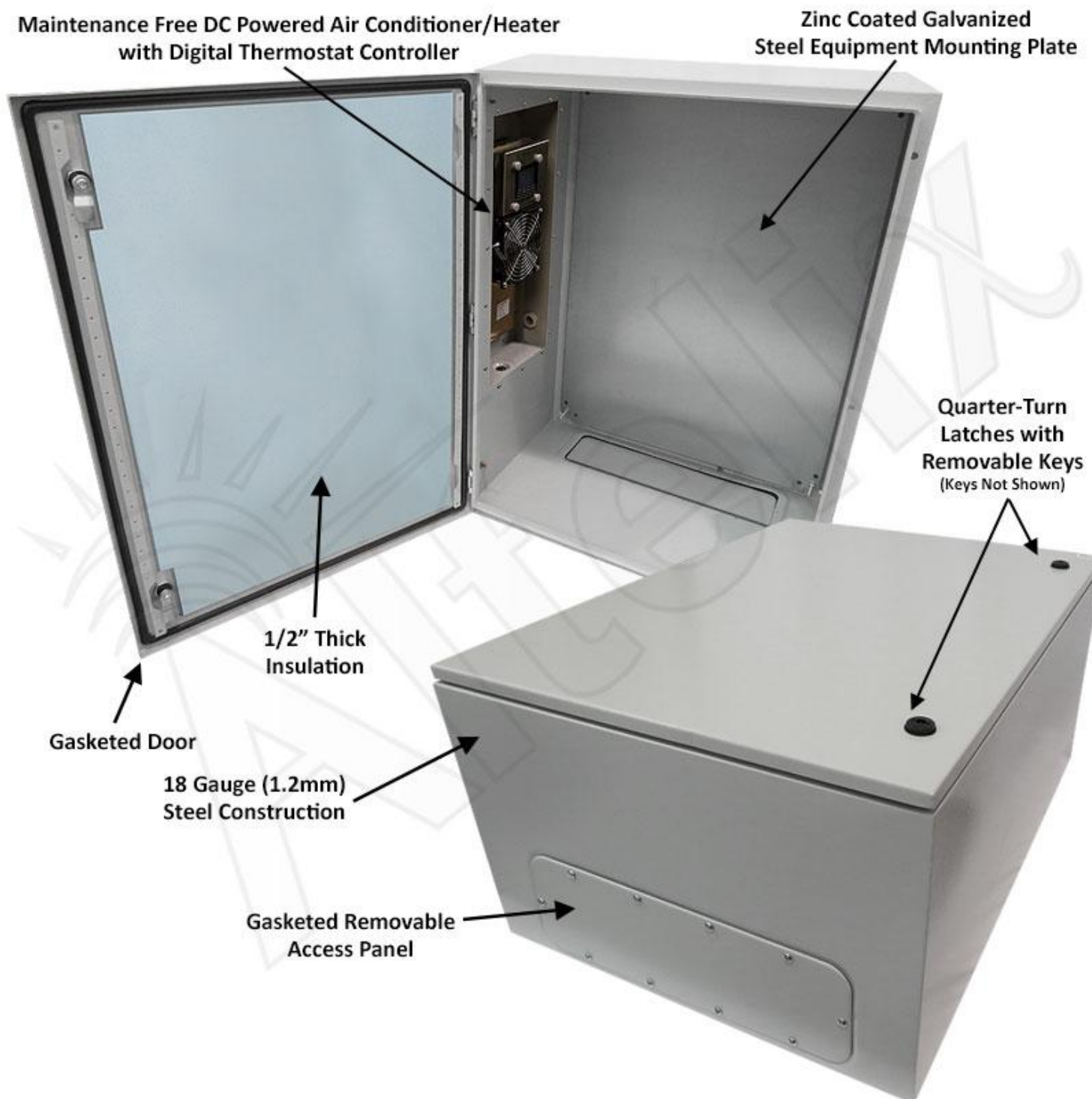

Product Photos



Product Photos



Optional Access Panels



Specifications

Electrical Specifications

Model	NS322416D12-AZ
A/C Unit Voltage	11-35 VDC
A/C Unit Power Consumption	12VDC @ 34A max. 24VDC@ 17A max.

Model	NS322416D4-AZ
A/C Unit Voltage	36-54 VDC
A/C Unit Power Consumption	48VDC @ 8.1 max.

General Specifications

Material	Continuous Seam Welded 18 Gauge (1.2 mm) Steel
Color	Light Gray (RAL 7035)
Digital Controller Operational Temperature Range	-22°F (-30°C) to +140°F (+60°C)
Insulation Thickness	0.50 in. (12.7mm)
Insulation R-Value	2
Cooling Capacity	800 BTU
Heating Capacity	520W
Exterior Dimensions (Height x Width x Depth)	31.5 x 31.6 x 15.7 In. (800 x 802.6 x 400 mm)
Interior Dimensions* (Height x Width x Depth)	26.0 x 20.0 x 14.1 In. (660 x 508 x 358 mm)
Equipment Mounting Plate Material	18 Gauge (1.2 mm) Zinc Coated Galvanized Steel
Equipment Mounting Plate Dimensions	30.1 x 21.6 In. (765 x 550 mm)
Weight	98.5 lbs. (44.6 kg)
Noise Level	65dB
Ratings	Meets or Exceeds NEMA 1, 2, 4, 4X, 12, 13 and IEC 529 IP65, IP66

*Notes:

Interior dimensions represent maximum space available for equipment.