

Installing the Sonos AMP

The HBB-SNS1 enclosure features a mounting system designed specifically for the Sonos AMP.

Step 1:

Attach the included locking cam to the bottom side of the Sonos AMP

Locking Cam



Wall/Ceiling Mounting Bracket

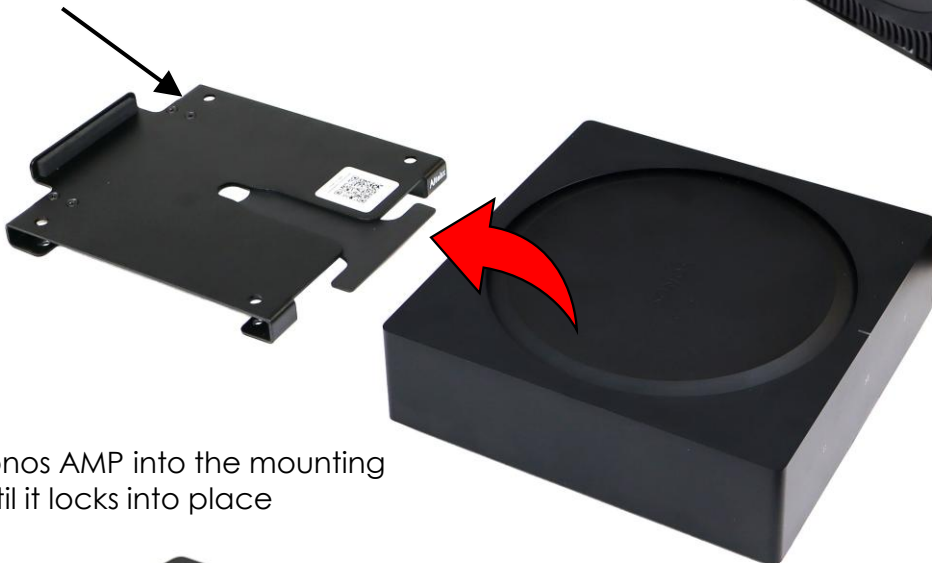

Step 2:

Slide the Sonos AMP into the mounting bracket until it locks into place

Release Tab



To remove, press tab to release the Sonos AMP and slide out.

Got Questions?

We are here to help. Contact us at:



sales@altelix.com



USA & Canada: 866-660-9434

International: +1 561-660-9434



www.Altelix.com