



NF14VFA1C-STK1 & NF14VFHA1C-STK1



Installation Guide

Altelix LLC USA: 866-660-WIFI (9434) International: +1 561-660-9434 sales@altelix.com www.altelix.com

Copyright (C) 2023 Altelix LLC. All rights reserved. Altelix and the Altelix logo are Trademarks and/or Registered Trademarks of Altelix LLC.

Specifications are subject to change without notice. See www.altelix.com for most current information

Installing the Starlink Router and Ethernet Adapter

This enclosure features a multi function mounting cradle which is designed to easily mount both the Starlink router and Starlink Ethernet adapter into one cradle. This mounting cradle also provides easy to use cable management for all the required cables.

1. To install the Starlink Ethernet Adapter if required, slide in the bottom of the mounting cradle as shown.

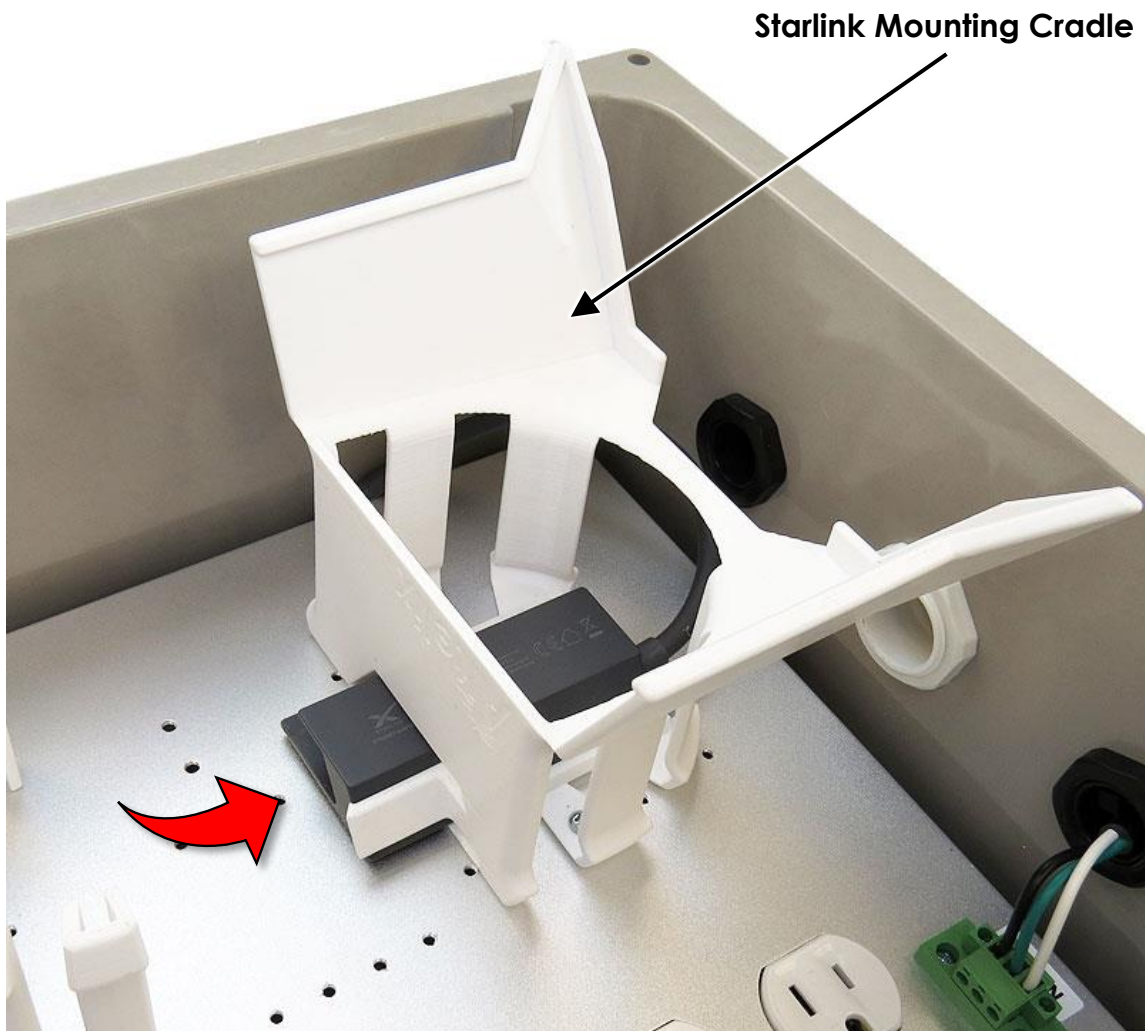

2. The Starlink mounting cradle provides an easy way to manage excess cable. The example below illustrates how to easily route the cables.



Note: When routing the Starlink cables, be sure to position the connectors at the bottom opening of the mounting cradle as shown.

- 3. Cable glands on the bottom of the enclosure provide access for cables

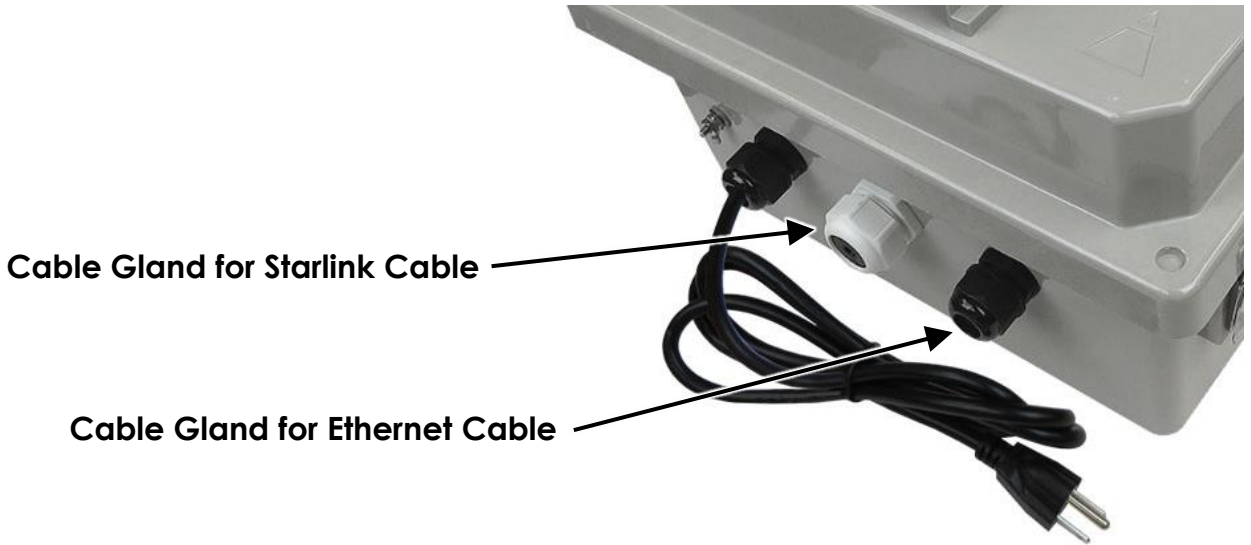

- 4. Press and secure the Starlink router into the mounting cradle. Ensure sides are snug around the router.

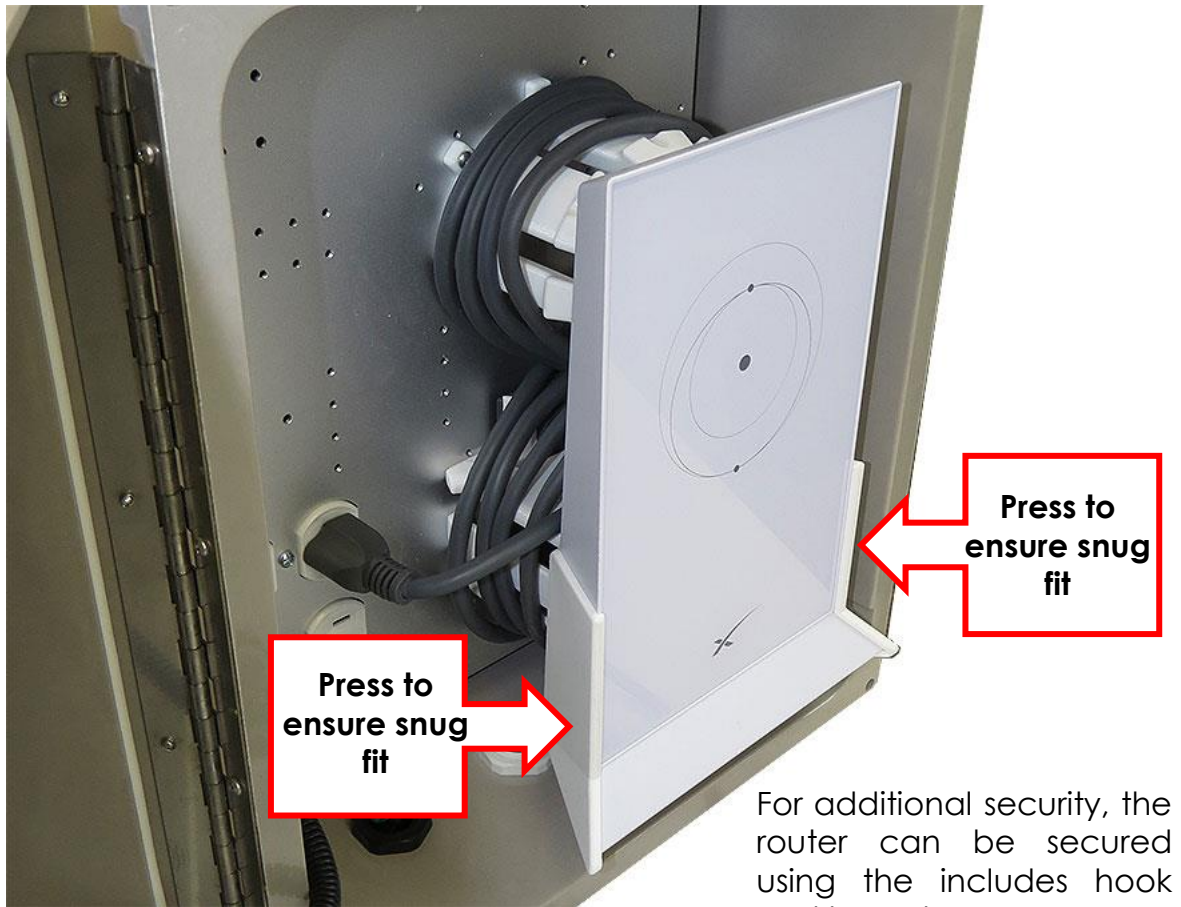

Mounting The Enclosure

The (4) steel mounting feet included in the hardware kit can be used to mount the enclosure to most surfaces.

(4) Threaded inserts are provided on the rear of the enclosure. Using the included screws, secure the (4) mounting feet to the enclosure as shown.

Mounting Feet



When attaching mounting feet, hand tighten screws only.

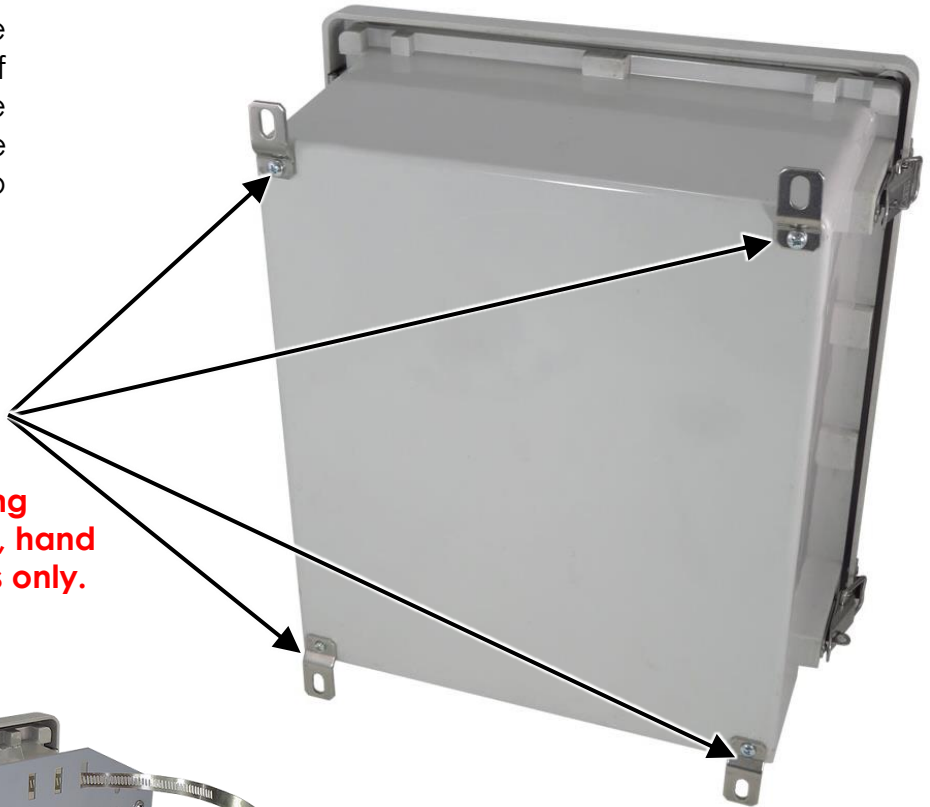

This enclosure can also be pole mounted using the optional NMK Series Pole Mount Kits which can be purchased by visiting:

www.ALTELIX.com

Shown with Optional
NMKS-300-08
Pole/Wall Mount Kit

**Got Questions?
We are here to help.
Contact us at:**



sales@altelix.com



**USA & Canada: 866-660-9434
International: +1 561-660-9434**

WARNING: INSTALLATION OF THIS PRODUCT NEAR POWERLINES IS DANGEROUS. FOR YOUR SAFETY, FOLLOW THE INSTALLATION DIRECTIONS



Under some conditions, this enclosure may not prevent electrocution. Users should keep enclosure away from any overhead wires. If enclosure contacts a power line, any initial protection could fail at any time. IF ENCLOSURE NEARS ANY OVERHEAD WIRES, IMMEDIATELY LET GO, STAY AWAY, AND CALL UTILITY COMPANY

THIS ENCLOSURE IS DESIGNED TO BE INSTALLED ONLY BY A TRAINED PROFESSIONAL INSTALLER

Warning: To avoid electric shock, grounding must be installed by the installer as part of the installation. The unit must be grounded and installed in accordance with National Electrical Codes (NEC) and any local codes. Note that non-metallic enclosures do not provide grounding between conduit connections.

Warning: Enclosure must be secured when energized to prevent unauthorized access and shock hazard.

Important: Look over the site before beginning installation and anticipate possible hazards. Select a safe site to install the enclosure.

If you have power lines in the area, call your local electric utility for assistance.

NEVER work alone; always have someone near who can summon help.

Check weather conditions. Be sure that the area is not slippery and make sure that rain or thunderstorms are not predicted for the day you install the enclosure.

If you need to use a ladder, make sure it is made of non-conductive (non-metallic) material.

Enclosures improperly installed or installed to an inadequate structure are susceptible to wind damage that can be very serious or even life threatening. Ensure that the installation is properly grounded. Ensure that the enclosure is properly secured and structurally sound to support all loads (weight, wind & ice).

Rooftop Installation Warning

DO NOT assume that just because you're on a roof, you're isolated from ground. You may still be electrocuted or fall off the roof.