

# NP17AV-YBT2



## Installation Guide

**Altelix LLC USA: 866-660-WIFI (9434) International: +1 561-660-9434 sales@altelix.com www.altelix.com**  
Copyright (C) 2023 Altelix LLC. All rights reserved. Altelix and the Altelix logo are Trademarks and/or Registered Trademarks of Altelix LLC.  
Specifications are subject to change without notice. See [www.altelix.com](http://www.altelix.com) for most current information

# Installing the WIS4200 in the NP17AV-YBT2



The WIS4200 mounting bracket kit included with the NP17AV-YBT2 contains (3) brackets for securing the device into the enclosure. The (7) screws included in the kit are used to attached the brackets to the aluminum back plate.

**Mounting Bracket Kit**

1. The two adjustable brackets shown are used to secure the WIS4200 to the back plate. Adjust the height of each bracket as shown by loosening the two adjustment screws on each bracket.

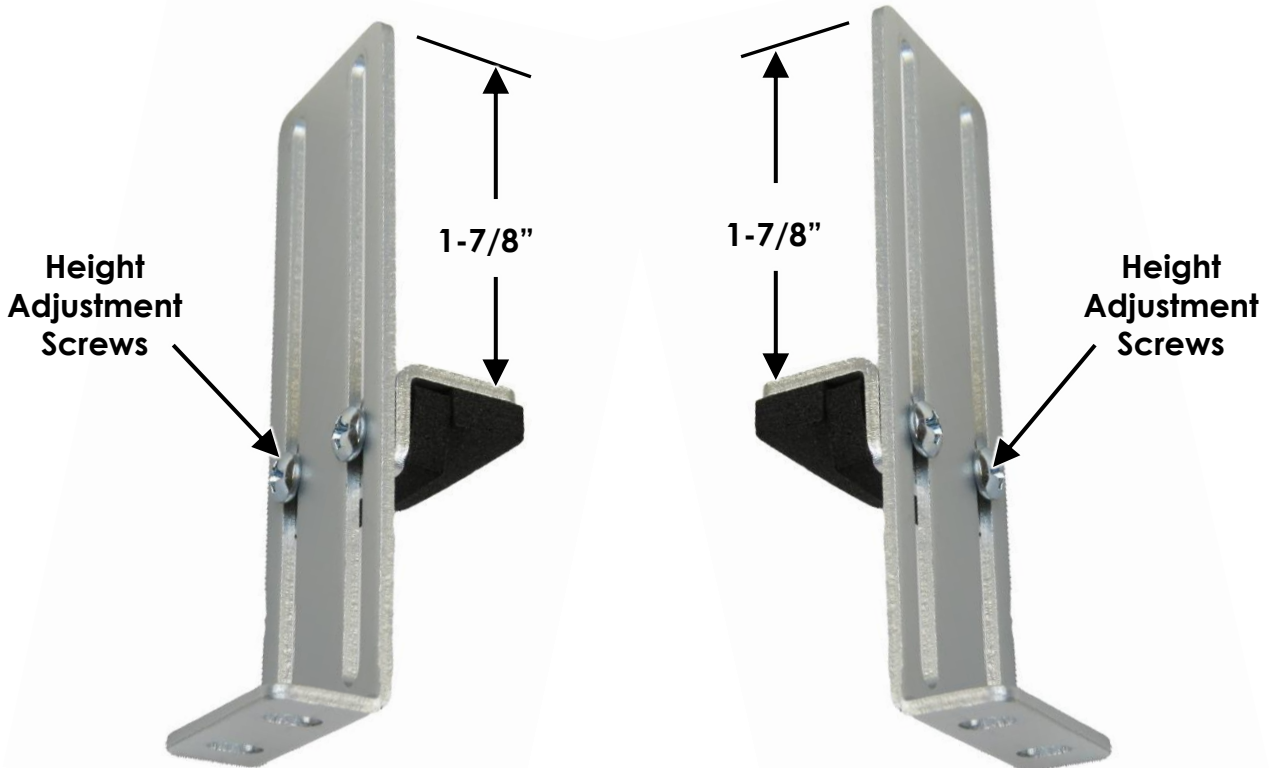

2. Install the two mounting brackets to the back plate as shown using the (4) #6-32 screws supplied in the kit.

Note the location of the brackets on the back plate.

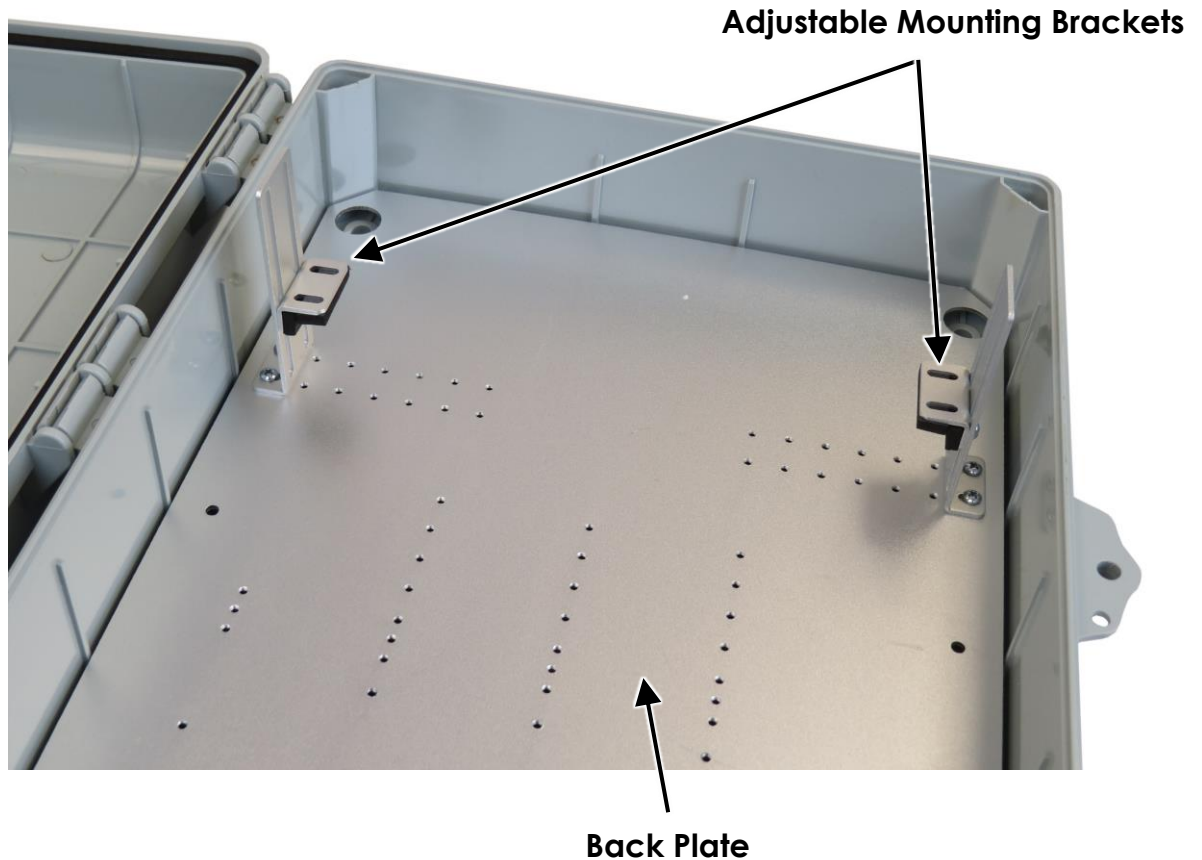

3. Run Ethernet cable (not included) into the enclosure via the cable gland as shown.

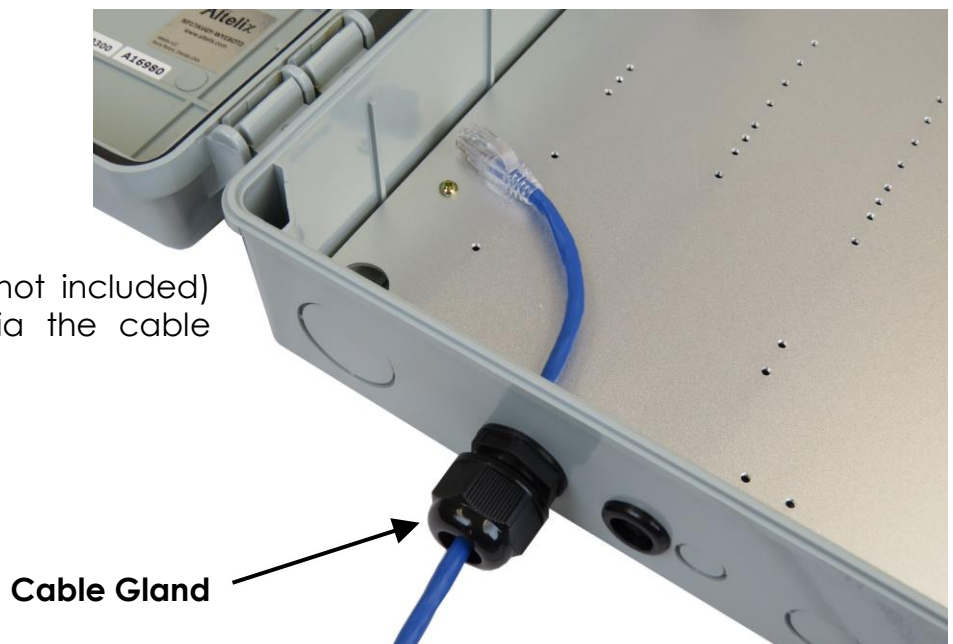

4. Attach Ethernet cable to the WIS4200 and slide unit under the two adjustable mounting brackets as shown.

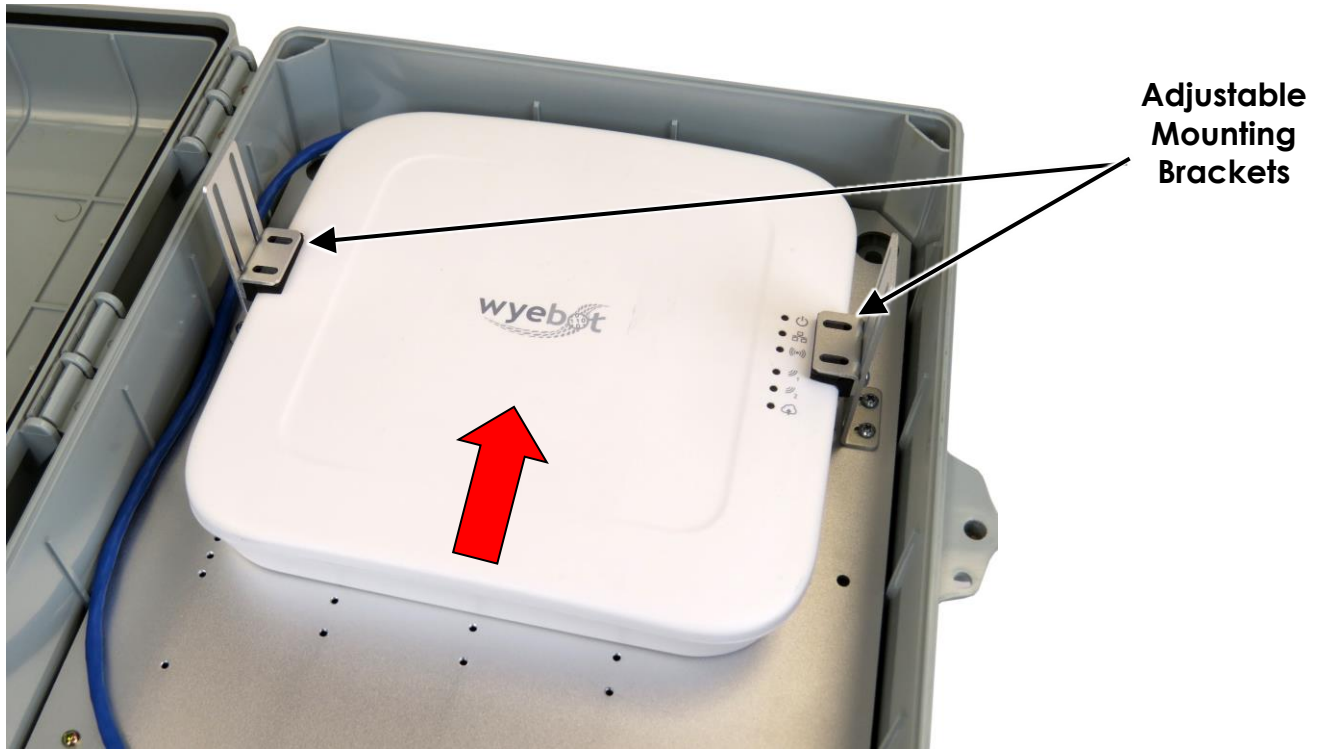

5. Installed the bottom bracket onto the back plate as shown using (3) #6-32 screws included in the kit.

**Bottom Bracket**

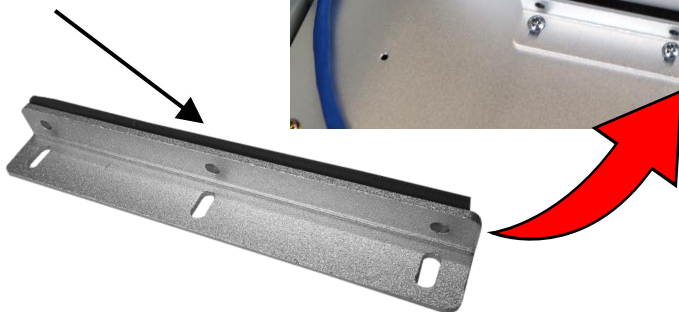

6. Once the WIS4200 is secured inside the enclosure, use the included cable management straps to secure any loose cables.

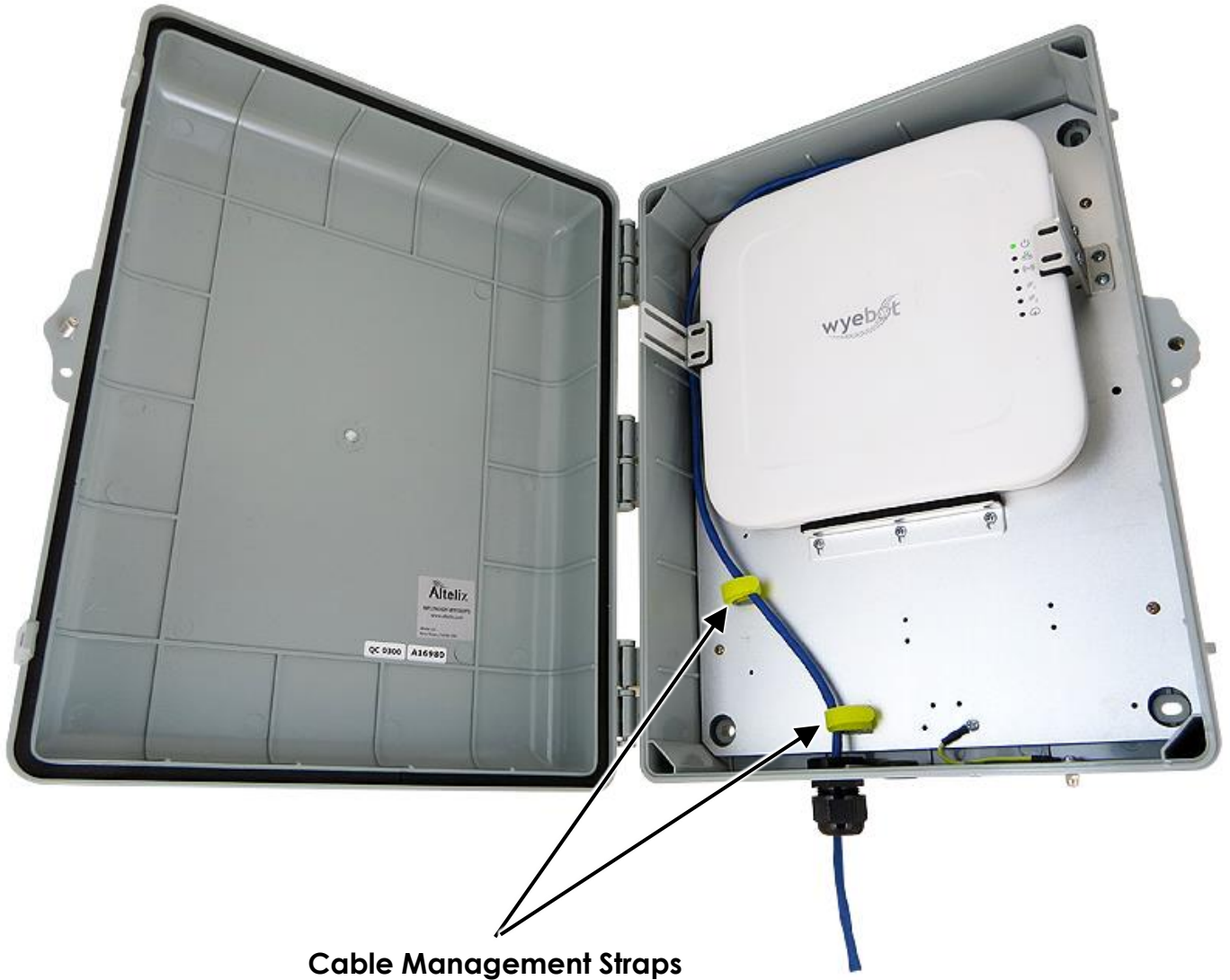

**Got Questions?  
We are here to help.  
Contact us at:**



**sales@altelix.com**



**USA & Canada: 866-660-9434  
International: +1 561-660-9434**

# Mounting the NP17AV-YBT2 Enclosure

The NP17AV-YBT2 enclosure can be either wall mounted using the supplied hardware or pole mounted using the optional pole mounting kits available from [www.ALTELIX.com](http://www.ALTELIX.com).

To wall mount the NP17AV-YBT2 enclosure, two of rear mounting feet need to be drilled.

Using a 1/4" drill bit, carefully drill through the mounting feet in locations shown.



**Mounting Screws & Wall Anchors**



**Rubber Sealing Washers**

## Mounting the Enclosure

1. Place (4) Rubber Sealing Washers into (4) mounting holes as shown.
2. Secure the enclosure to the wall using the (4) Screws.

Note: Back plate not shown for clarity.

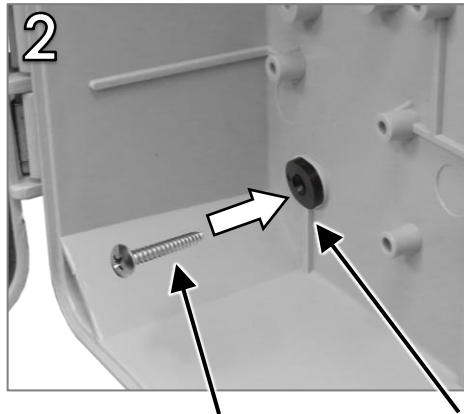
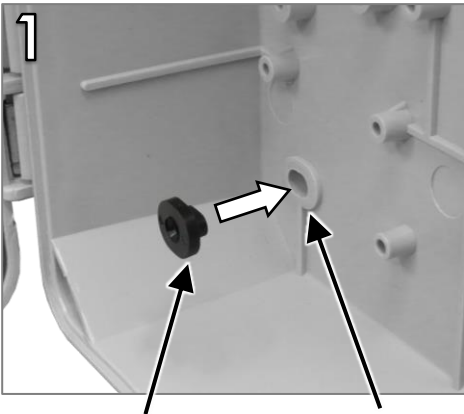

**Rubber Sealing Washer**

**Mounting Hole**

**Mounting Screw**

**Rubber Sealing Washer**

3. When mounting the enclosure, ensure the rubber sealing washers completely cover the enclosure mounting holes to provide a water-tight seal. Silicone sealant can also be added to enhance the seal.

**WARNING: INSTALLATION OF THIS PRODUCT NEAR POWERLINES IS DANGEROUS. FOR YOUR SAFETY, FOLLOW THE INSTALLATION DIRECTIONS**



Under some conditions, this enclosure may not prevent electrocution. Users should keep enclosure away from any overhead wires. If enclosure contacts a power line, any initial protection could fail at any time. IF ENCLOSURE NEARS ANY OVERHEAD WIRES, IMMEDIATELY LET GO, STAY AWAY, AND CALL UTILITY COMPANY

**THIS ENCLOSURE IS DESIGNED TO BE INSTALLED ONLY BY A TRAINED PROFESSIONAL INSTALLER**

**Warning:** To avoid electric shock, grounding must be installed by the installer as part of the installation. The unit must be grounded and installed in accordance with National Electrical Codes (NEC) and any local codes. Note that non-metallic enclosures do not provide grounding between conduit connections.

**Warning:** Enclosure must be secured using a pad-lock when energized to prevent unauthorized access and shock hazard.

**Important:** Look over the site before beginning installation and anticipate possible hazards. Select a safe site to install the enclosure.

If you have power lines in the area, call your local electric utility for assistance.

**NEVER** work alone; always have someone near who can summon help.

Check weather conditions. Be sure that the area is not slippery and make sure that rain or thunderstorms are not predicted for the day you install the enclosure.

If you need to use a ladder, make sure it is made of non-conductive (non-metallic) material.

Enclosures improperly installed or installed to an inadequate structure are susceptible to wind damage that can be very serious or even life threatening. Ensure that the installation is properly grounded. Ensure that the enclosure is properly secured and structurally sound to support all loads (weight, wind & ice).

## **Rooftop Installation Warning**

**DO NOT** assume that just because you're on a roof, you're isolated from ground. You may still be electrocuted or fall off the roof.